

# Douglas and King Architects

**External Lighting Strategy**  
**Discharge of Planning Condition 17**  
**Planning Consent Reference – 2015/2789/P**

*252 Finchley Road. London. NW3 7AA*

*Revision A – 24<sup>th</sup> May 2016*

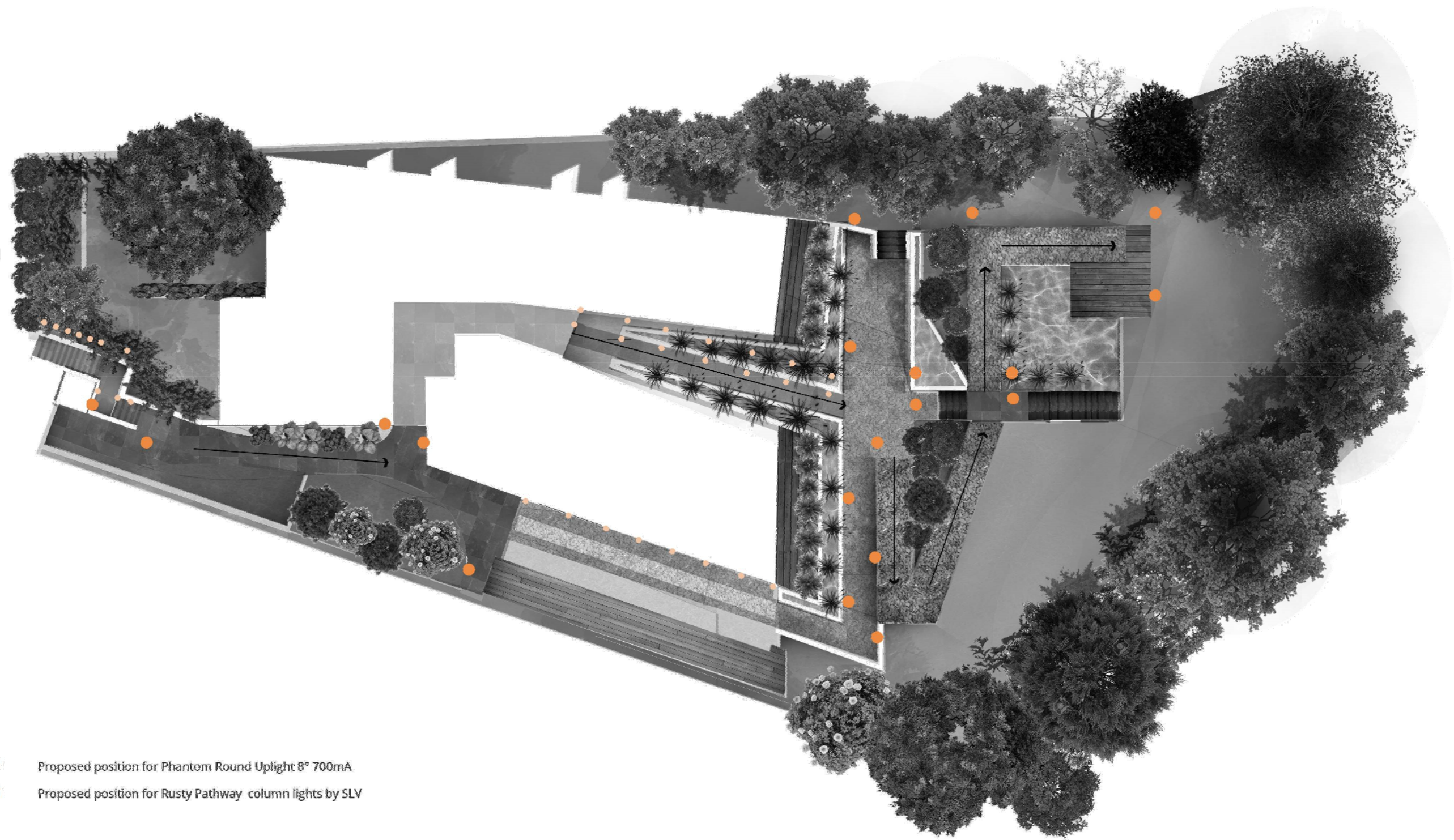

- Proposed position for Phantom Round Uplight 8° 700mA
- Proposed position for Rusty Pathway column lights by SLV

Notes

1. All dimensions to be checked on site.
2. All dimensions are to masonry unless otherwise stated (ie not plaster finishes)
3. All information is to be checked and verified by the contractors and sub-contractors for accuracy and fit.
4. Discrepancies or omissions to be brought to the attention of Douglas & King prior to construction.
5. Do not scale from this drawing.

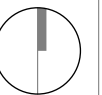

**Douglas and King Architects**

148-150 Curtain Road London EC2A 3AR  
 t + 44 (020) 7613 1395  
 info@douglasandking.com  
 www.douglasandking.com

revision	date	notes

project:	FINc252 252 Finchley Road NW3 7AA
client:	Finchley Road Developments

drawing title:	Proposed External Lighting plan
----------------	------------------------------------

scale:	1:200@A3	date:	May 2016
drawing no:		FINc252 GA 701A	

PLANNING

## LIGHTING SPECIFICATIONS

The external lighting strategy provides a very low level of external light to mark pathways and obstacles.

The light spill to neighbouring trees and planting areas is avoided by the use of 3W(low lights) spot lights and low level column lights as advised in council policy documentation.



### Information

#### Specification

##### General

Colour Chrome,Stainless Steel

Construction Steel / Glass

Dimmable Yes

IP Rating IP68 - Dust tight. Protection against complete, continuous submersion in water.

LED TypeHigh Power

##### Dimensions

Cable Length 2000mm

Cut Out 40mm (Diameter)

Depth 82mm

Diameter 49mm

Tube Diameter 49mm

Tube Length 88mm

##### Electrical

Amperage 700mA

Maximum Wattage 3W

Requires Driver Yes

Light Characteristics

Beam Angle 8°

Colour Rendering Index 80

Lumens 130 lm



### Information

#### Features

Includes: Screws

Design by CDC

Safety class two

Energy saver

IP 44 rated

Rusted iron finish

Energy Saving Trust Approved: Yes

Accommodates: (1) x E27 11W energy saver bulb

Voltage: 230 Volts

#### Product Details

Product Type: Pathway lighting

Style: Modern

Bulb Wattage: 11 Watts (W)

Number of Lights: 1

Bulb Type: Incandescent

#### Additional Documents

PDFEnergy Guide

Weights & Dimensions

50 cm Size

Overall: 50cm H x 12cm W x 12cm D

80 cm Size

Overall: 80cm H x 12cm W x 12cm D

#### Features

Product Type: Pathway lighting Style: Modern

Bulb Wattage: 11 Watts (W) Number of Lights: 1

Bulb Type: Incandescent Fixture Finish: Rusted iron

Voltage: 230 Volts (V)Light Direction: Ambient

Glass Component: Yes Country of Manufacture: United Kingdom