

Do not scale from this drawing. Verify all dimensions on site. Drawing should be read in conjunction with information from all other design consultants and contractors. All drawings in digital format are for reference only, paper copies are available on request.

FOR PLANNING

© Maccreanor Lavington Ltd.

For proposed landscape information refer to JCLA landscape drawings submitted as part of this planning application

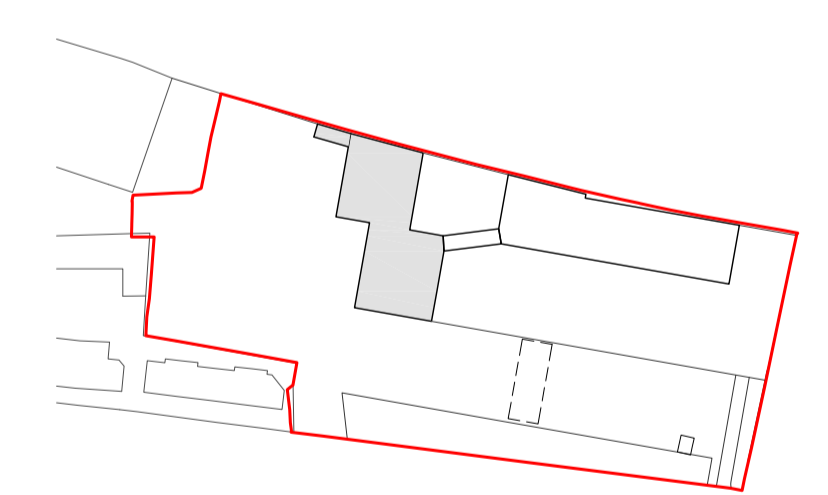

A	Planning Amendments	JP	13.05.16
Rev	Details	Drwn	Date

**Application 01
Expansion of Kingsgate Primary School
& Redevelopment of Liddell Road Phase 01**

Client: London Borough of Camden
 Title: School Building 01
 Roof Plan
 Scale: 1:100 @ A1 / 1:200 @ A3
 Date: 01-12-2014 Drawn: HD/IP

MLA / 403 / P1 / 122 - Rev A

MaccreanorLavington
 3rd Floor
 19-21 Nile Street
 London N1 7LL
 t +44(0)207 336 73 53
 f +44(0)207 336 76 55
 e uk@ml-architects.com

