

**ENE 4 - Drying Space**

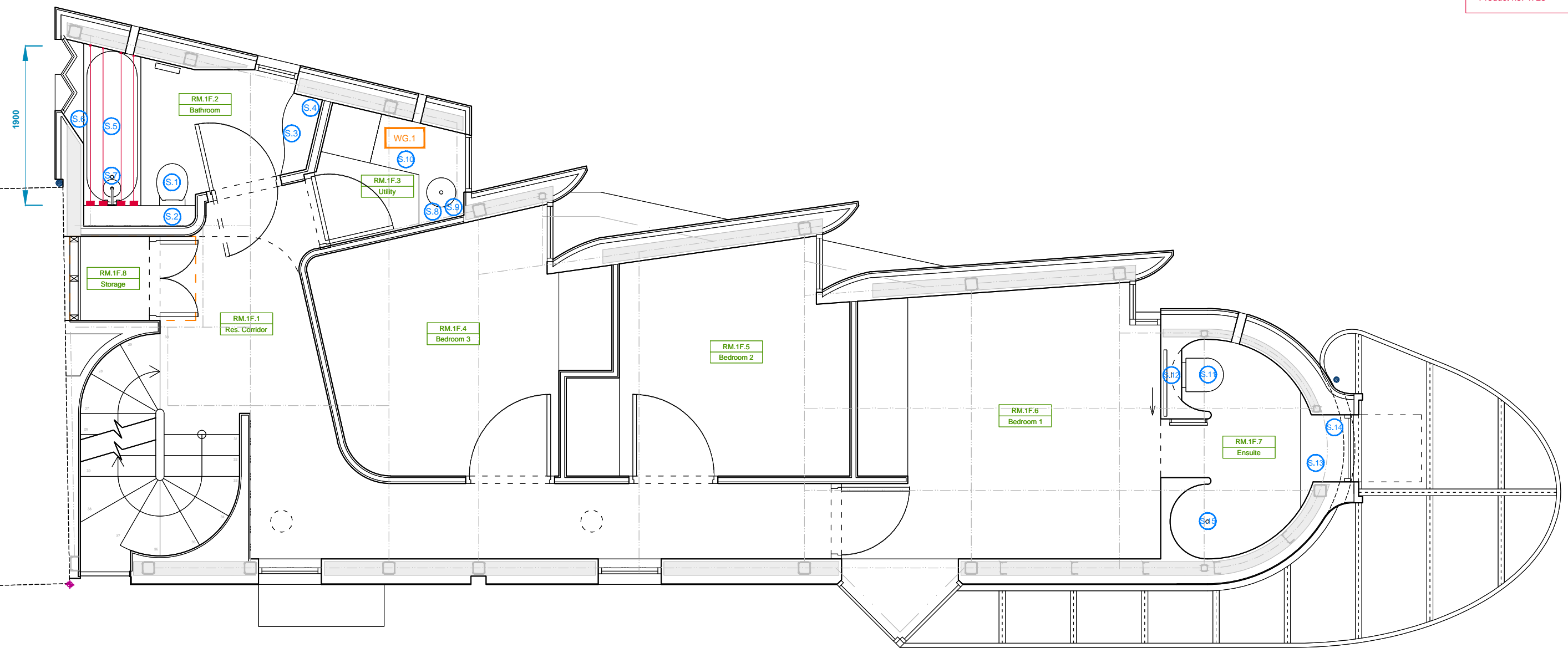

4no. Corby retractable clotheslines, wall mounted  
 Max length: 2.8m  
 Product no. 4726



**NOTES**  
 This drawing is the property of Birds Portchmouth Russum Architects (copyright reserved). This drawing is not to be copied, reproduced, retained or disclosed to any unauthorised person either wholly or in part without the specific consent in writing of Birds Portchmouth Russum Architects.  
 1. No dimension to be scaled from drawings  
 2. All dimensions to be verified by the contractor before work is commenced

**ENE 4 - Drying Space**  
 Length: 7m  
 4no. Corby retractable clotheslines over bath  
 Continuous mechanical extract: minimum high rate of 8L/S = 5.4 air changes

**ENE 5 - White Goods**  
 WG.1 Siemens Washer / Dryer  
 See SH.2005 White Goods Schedule for technical information

- WAT 1 - Internal Usage**
- S.1 Architec Wall mounted WC
  - S.2 Geberit Omega Concealed Cistern
  - S.3 Ex.t Round Countertop Basin
  - S.4 Vola Wall Mounted Tap
  - S.5 Bettestarlet IV Silhouette Bath
  - S.6 Vola Wall Mounted Bath Tap
  - S.7 Grohe Tempesta 100 Head Shower - Wall Mounted
  - S.8 Franke Rotondo Steel Sink
  - S.9 Vola Swivel Spout Tap
  - S.10 Siemens Washer Dryer
  - S.11 Architec Wall mounted WC
  - S.12 Geberit Omega Concealed Cistern
  - S.13 Ex.t Round Countertop Basin
  - S.14 Vola Table Mounted Tap
  - S.15 Grohe Tempesta 100 Head Shower - Ceiling Mounted
- See SH.2004 Sanitary Schedule for technical information

Rev:	Note:	Date:
Drawing Scale:		
0 1m 2m		
Project:	Issue/Date:	
69 Highgate High Street, London	16.5.16	
Drawing:	Status:	
CSH - Plan : +1	Information	
Drawing No:	Scale:	
HG.CSH.003	1:50 @ A3	
<b>BIRDS PORTCHMOUTH RUSSUM ARCHITECTS</b>		
Unit 11, Union Wharf 23 Wenlock Road, London N1 7SB t. 020 7253 8205		