



Photo 1

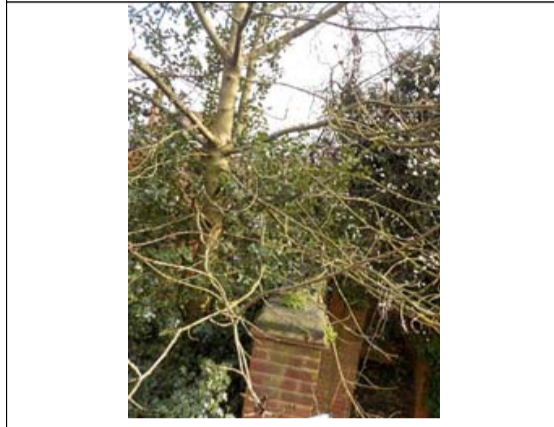

Photo 2



Photo 3



Photo 4



Photo 5



Photo 6

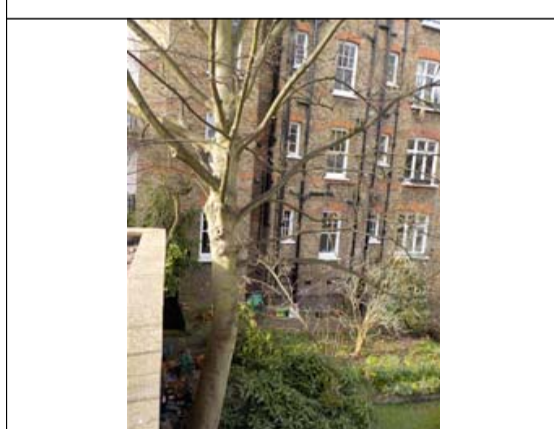

Photo 7

Drawing No: CCL 09261 / TCP Rev: 1
 Title: Tree Constraints Plan (Existing Layout)
 Site: Abacus Belisize Primary School NW3 1PD
 Scale: 1:200 Paper Size: A1



Tree Retention Categories (Rev: 1)

- Category A tree** (Green circle): Trees of high quality with an estimated life expectancy of 40+ years. Usually large trees with significant presence or smaller trees with excellent form. Retention of these trees is highly desirable.
- Category B tree** (Blue circle): Trees of moderate quality with a life expectancy of 20+ years. Usually maturing trees or younger trees with good form. Retention of these trees is desirable though less than Category A trees.
- Category C tree** (Grey circle): Unremarkable trees of low quality and merit. Individual specimens are not considered to be a material planning consideration.
- Category U tree** (Red circle): Trees unsuitable for retention due to their very poor condition.

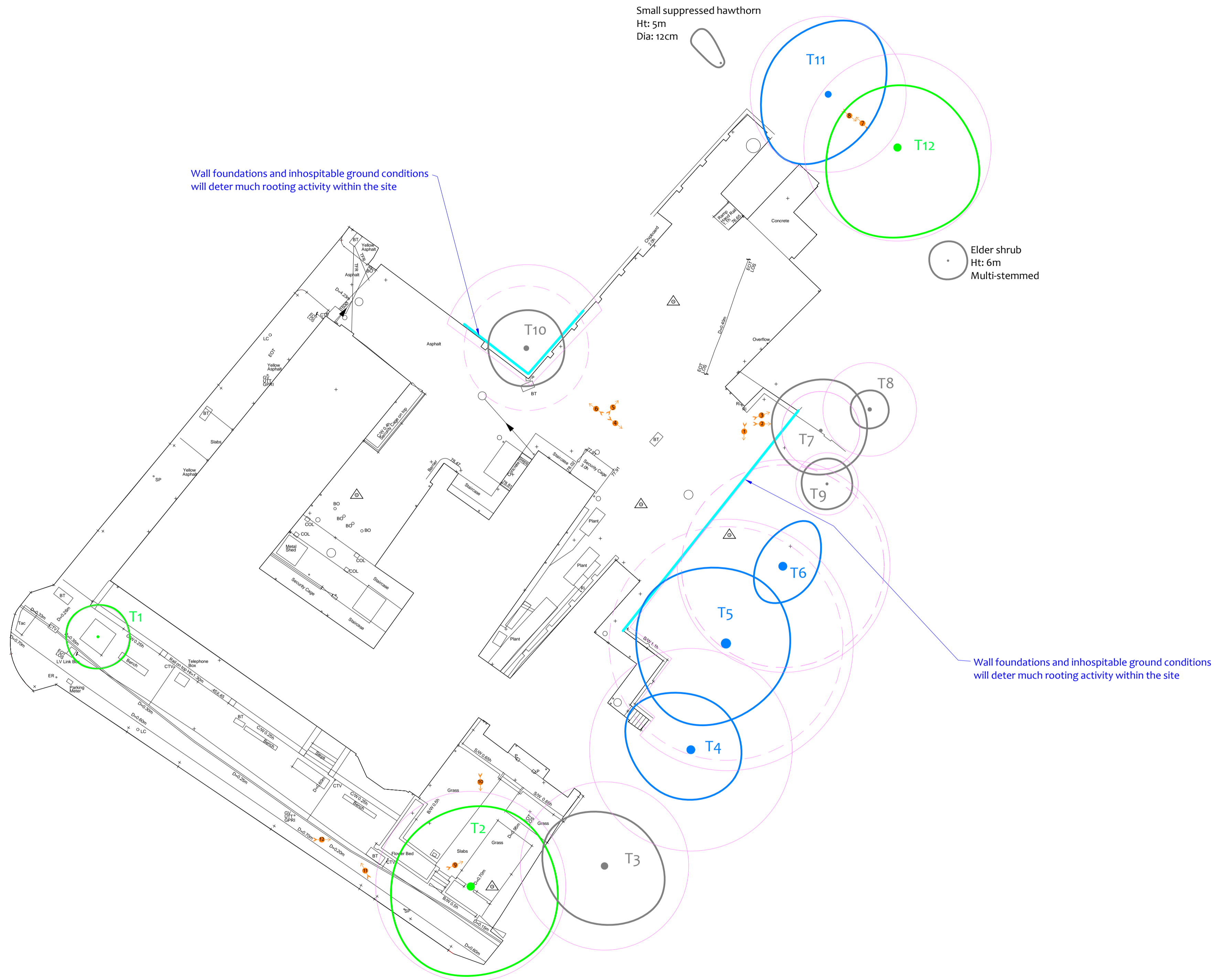

Tree Constraints Plan

BS 5837 Root Protection Area (radius = 1xstem diameter)
 Root Protection Area needing amendment due to site conditions, e.g. presence of existing road or building.
 Root Protection Area having been amended to account for site conditions

T1 = Tree No 1 G2 = Group No 2 H3 = Hedge No 3

Photo 1
 MN = Measured North:
 Canopy spreads are sometimes measured to an approximate N defined by site features. Often more accurate, especially where rows of trees are not aligned N-S or E-W.

Tree Ref.	Species	Height (m)	Root Protection Area	
			Radius (m)	Area (m ²)
T1	Hornbeam	8.5	2.4	18
T2	Oak	14	7.3	168
T3	Lime	12	6.5	132
T4	Lime	10	7.8	191
T5	London Plane	13	9.0	254
T6	Lime	16	7.8	191
T7	Ash	10	3.0	28
T8	Lawson Cypress	8.5	3.6	41
T9	Cherry	6	2.4	18
T10	Lime	9	4.8	72
T11	Sycamore	16	6.0	113
T12	Sycamore	18	7.2	163

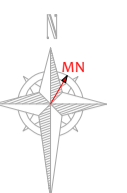

Tree Constraints Plan (Existing Layout)



Photo 8



Photo 9



Photo 10



Photo 11



Photo 12