

Amaduddin, Shaik

**From:** Kumar, Krishnaraj  
**Sent:** 13 October 2014 11:35  
**To:** Statutory Enquiries  
**Subject:** RE: Urgent: PLANT ENQUIRY : LM 33749/NR - Site at Haverstock Hill, London  
**Attachments:** Haverstock Hill.pdf; Data Key + Special Requirements.pdf

**This response is made only in respect to electronic communications apparatus forming part of the Vodafone: Fixed electronic communications network formerly being part of the electronic communications networks of Cable & Wireless UK, Energis Communications Limited, Thus Group Holdings Plc and Your Communications Limited.**

Please accept this email as confirmation that Vodafone: Fixed **does** have apparatus within the vicinity of your proposed works detailed below.

Please see attached network information.

Many thanks.

Plant Enquiries Team  
T: 01454 662881  
E: [osm.enquiries@atkinsglobal.com](mailto:osm.enquiries@atkinsglobal.com)

ATKINS working on behalf of Vodafone



**IMPORTANT - PLEASE READ:**

Diversions may be necessary if the existing line of the highway/railway or its levels are altered, where apparatus is affected. Where apparatus is affected and requires diversion, you must submit draft details of the proposed scheme with a request for a 'C3 Budget Estimate' to [osm.enquiries@atkinsglobal.com](mailto:osm.enquiries@atkinsglobal.com). Once your C3 request has been received, it will be submitted to Vodafone. These estimates should be provided by Vodafone normally within 20 working days from receipt of your request. Please include proof of this C2 response when requesting a C3 (using the 'forward' option).

**PLEASE NOTE:**

The information given is indicative only. No warranty is made as to its accuracy. This information must not be solely relied upon in the event of excavation or other works carried out in the vicinity of Vodafone plant. No liability of any kind whatsoever is accepted by Vodafone, its servants, or agents, for any error or omission in respect of information contained on this information. The actual position of underground services must be verified and established on site before any mechanical plant is used. Authorities and contractors will be held liable for the full cost of repairs to Vodafone's apparatus and all claims made against them by Third parties as a result of any interference or damage.



---

**From:** Rathore, Neha **On Behalf Of** Statutory Enquiries  
**Sent:** 10 October 2014 10:47  
**To:** National Plant Enquiries; 'Easynet'; 'Environment agn'; 'Interoute'; 'McNic'; 'Global Crossing New'; 'Networkrail'; 'Telenttella.Plantenquiries@telent.com'; 'verizonbusiness'; 'plantenquiries@energetics-uk.com'; 'plantenquiries@cityfibreholdings.com'; plantenquiries@catelecomuk.com; plantenquiries@jsmconstruction.com; plantenquiries@tfl.gov.uk; LULHVpowerassets@tfl.gov.uk; highwaysmanagement@camden.gov.uk; NRSWA@cofely-gdfsuez.com; plantenquiries@arqiva.com  
**Subject:** Urgent: PLANT ENQUIRY : LM 33749/NR - Site at Haverstock Hill, London  
**Importance:** High

**Urgent- It would be greatly appreciated if you could reply ASAP, where possible by 15.10.2014.**  
**Thanks in advance.**

To whom it may concern,

**Please reply to this Email id: - [AtkinsStatutory.Enquiries@atkinglobal.com](mailto:AtkinsStatutory.Enquiries@atkinglobal.com);**

McNicholas - Please reply for KPN & TATA

**[LM 33749/NR - Site at Haverstock Hill, London - 528200,184430 - NW3 2BL](#)**

**[Works Description - Development Appraisal](#)**

**[Reply required by date - 15.10.2014](#)**

Please find attached a plant enquiry with corresponding map for your attention. Please could you send us plans showing the location of your company's affected plant to the below address quoting our reference number and the name of the scheme shown above. **Please also include information relating to the use and location of Radio Frequency Identification Devices (RFIDs) where available.**

Please cover the **entire area** shown in the boundary on the attached map not just the arrow, this is just an indicator of the middle of the site

If you do not have any apparatus in this area, please could you send written confirmation to declare that no apparatus is affected.

Many thanks,

**Please don't hesitate to contact me with any questions.**

Regards,

**Neha Rathore.**

Statutory Search Coordinator, Communications-Network Services

**ATKINS**

Find out more about what we do and how we do it – [www.atkinglobal.com](http://www.atkinglobal.com)

The hub, 500 Park Avenue, Aztec West, Almondsbury, Bristol, BS32 4RZ | Tel: 01454 663130 or 01454 663222 |  
Email: [Neha.Rathore@atkinglobal.com](mailto:Neha.Rathore@atkinglobal.com) | Web: [www.atkinglobal.com](http://www.atkinglobal.com)

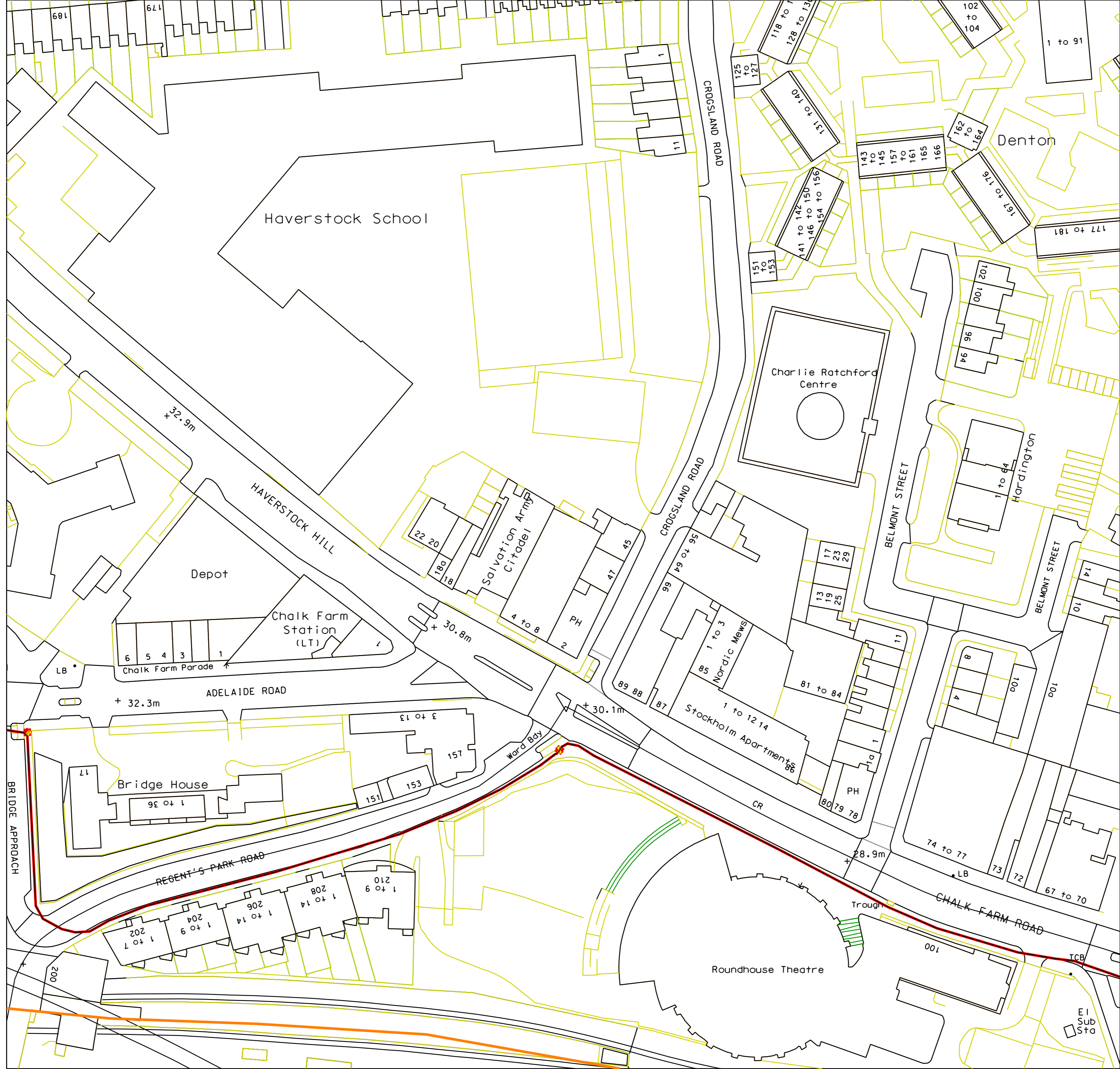

Haverstock School

Denton

Charlie Ratchford Centre

Depot

Chalk Farm Station (LT)

Salvation Army Citadel

Stockholm Apartments

Nordic Mews

Bridge House

Roundhouse Theatre

BRIDGE APPROACH

REGENT'S PARK ROAD

CROSSLAND ROAD

CROSSLAND ROAD

BELMONT STREET

BELMONT STREET

CHALK FARM ROAD

ADELAIDE ROAD

HAVERSTOCK HILL

Chalk Farm Parade

Hardington

PH

Word & Bay

PH

E1 Sub Sta

+ 32.9m

+ 32.3m

+ 30.8m

+ 30.1m

+ 28.9m

189

179

11

125 to 127

118 to 128

102 to 104

1 to 91

131 to 140

143 to 145

157 to 161

165 to 166

167 to 176

177 to 181

151 to 153

141 to 142

146 to 150

154 to 156

102 100

96 94

1 to 64

22 20

18a 18

4 to 8

PH

47

99 99 94 95

13 19 25

17 23 29

81 to 84

8

4

100

100

14

10

17

157

151

153

89 88

87

11

11a 1

80 79 78

74 to 77

73

72

67 to 70

1 to 7

1 to 9

1 to 14

1 to 14

1 to 14

1 to 14

1 to 14

1 to 9

1 to 14

1 to 14

1 to 14

1 to 14

1 to 14



200

100



TCB

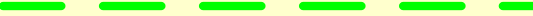

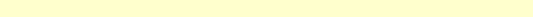
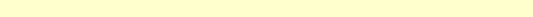
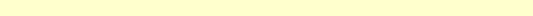
### Vodafone Network Colour:

	Ex-Cable&Wireless UK Network (now Vodafone)
	Planned & Approved Route
	Planned Route – Awaiting Approval
	Other Licensed Operator (OLO)
	Ex-Thus Network (now Vodafone)
	Ex-Energis Network (now Vodafone)
	OLO

### Other:

	Overhead Electricity Line (non Vodafone)
	Network Rail

### Other Licensed Operator (OLO).

= Ex-Cable&Wireless UK, Energis and Thus fibre-optic cable within an OLO duct. Please contact all other operators for further details of their apparatus within that area.

# Fibre Services

## Special Requirements relating to the External Plant Network of Vodafone

### Contents

1.	Introduction .....	1
2.	Purpose of document .....	1
3.	Scope .....	2
4.	Vodafone Network and Apparatus .....	2
5.	Plant records .....	2
6.	Definitions .....	2
7.	Requirements .....	3
8.	Depths of cover .....	3
9.	Separation .....	3
10.	Jointing chambers .....	5
11.	Notification periods .....	5
12.	Excavation and backfill .....	5
13.	Foam concrete .....	6
14.	Attendance of Company Representative .....	6
15.	Damage reports .....	6
	Appendix A - office address details .....	7
	Appendix B – Street Works Team Contacts for Vodafone .....	8
16.	About this Document .....	9

## 1. Introduction

This document sets out the procedure that will apply when Other Parties intend or are undertaking works in the vicinity of Vodafone apparatus.

## 2. Purpose of document

This document provides a means by which the Vodafone specific special requirements relating to their apparatus, regardless of it being situated in the public highway / road, private street, land or any other areas, is made aware to Other Parties.



### 3. Scope

This document will be presented to Other Parties or Contractors to encourage those undertaking works within the vicinity of Vodafone apparatus to refer to and comply with. This is in order to protect where necessary the Vodafone apparatus and to avoid damage to the apparatus and loss of service.

A National Joint Utilities Group (NJUG) document NJUG 9 titled "Recommendations for the Exchange of Records of Apparatus between Utilities" provides useful reference material.

It should be noted that, where appropriate, additional information on avoiding danger from underground apparatus is contained within the HSG47 guidance book titled "Avoiding Danger from Underground Services."

### 4. Vodafone Network and Apparatus

Damage to Vodafone apparatus is extremely disruptive and can be expensive to repair, especially where long lengths of cable have to be replaced.

In order to maintain the network integrity and minimise disruption to service, it is essential that disturbances are absolutely minimal. When working within the vicinity of Vodafone apparatus, extreme care is necessary in order to avoid costly repairs. The Other Parties / Contractor shall make every effort to ensure that disturbance of Vodafone apparatus is no more than is absolutely necessary for the completion of the works in accordance with their contract.

### 5. Plant records

It is the responsibility of the Other Parties undertaking works which may affect Vodafone apparatus to obtain all relevant Vodafone plant records from our agent Atkins Global prior to works commencing. This may be done by contacting the Atkins Global Plant Enquiries Team listed in Appendix B.

Plant records for such enquiries will generally be provided within 10 working days of receipt and in compliance with the New Roads and Street Works Act 1991 [NRSWA] requirements. If Vodafone plant is affected, the response will contain reference to this document. Other Parties and Contractors are advised to refer to the National Joint Utilities Group [NJUG] 9 Document which outlines recommendations for the exchange of records of apparatus between utilities.

### 6. Definitions

The following definitions are applicable in this document:

- a) **Apparatus** means all electronic communications apparatus above surface, at the surface or sub-surface apparatus, Cable, Jointing Chamber and plant formerly being apparatus owned or used by the Code Operators Cable & Wireless UK, Energis Communications Limited, Thus Group Holdings Plc and Your Communications Limited including any associated cables or ducts owned, leased or rented by the said Code Operators now owned and used by the Code Operator Vodafone Limited ("Vodafone").
- b) **Cable** means any polythene or other sheath containing optical fibres or metallic conductors.
- c) **Depth of cover** means the depth from the surface to the topmost barrel of the duct nest, in the case of ducts encased in concrete, to the top of the concrete, and in the case of directly buried cable, the top of the cable.
- d) **Jointing chamber** means any manhole, surface box or other chamber giving access to Vodafone apparatus or their network.
- e) **Utility** means an organisation licensed to provide gas, water, electricity, Cable TV or telecommunications services.
- f) **Developer** means an organisation licensed to develop industrial/residential premises or given license to connect to utility apparatus.



- g) **Contractor** means the individual, firm or company contracted to undertake the work for a Utility or Other Parties.
- h) **Other Parties** means the Utilities, Highway Authorities, Developers, Street Authority (Roads Authority - Scotland).
- i) **Site** means the location of, or in the vicinity of, the various works.

## 7. Requirements

Prior to commencing any work or moving heavy plant or equipment over any portion of the site, the Other Parties or Contractor shall notify Vodafone of their intentions. This may be done by contacting Atkins Global, contact listed in Appendix B.

Upon receipt of this notification, Atkins Global will identify if Vodafone apparatus is affected. If any Vodafone apparatus is affected by the works then Atkins Global will provide necessary records and confirm details of Vodafone apparatus and network operated within the affected area or adjacent to the proposed work site.

### 7.1 Location of Plant

It is the responsibility of the Other Parties or Contractors to undertake adequate plant location procedures. These may include searches for metallic cables which must be performed by actively inducing a signal in a cable conductor via a transmitter. A passive search is not considered sufficient.

Before applying a tracing signal to the Vodafone apparatus, the Other Parties or Contractors shall seek confirmation from Atkins Global that the Vodafone apparatus will not suffer any disruption to its networks normal workings as a result of the nature of the signal being induced.

### 7.2 Trial excavations

Optic fibre cables are very susceptible to damage from excavation tools. They are not electrically conductive and cannot be located by radio induction methods. Once an approximate location is known, the exact location must be ascertained by means of hand dug pilot holes. Where the work to be carried out by the Other Party or Contractor involves excavation in the vicinity of our apparatus, the Other Party or Contractor shall, by trial excavation at his own expense, determine the exact location and depth of the Cable & Wireless Worldwide apparatus. All excavations adjacent to the Vodafone apparatus are to be carried out by hand until the extent and /or location of the apparatus is known.

**All excavation work shall be executed in accordance with the current issue of Health and Safety series booklet HSG47, Avoiding danger from underground services.**

## 8. Depths of cover

The Other Party or Contractor should note that the minimum depths of cover for Vodafone apparatus shall be maintained together with specified separation requirements. Where the minimum depths of cover specified by Vodafone cannot be maintained, the Other Party or Contractor shall at their own expense, carry out the instructions of Vodafone requirements for the protection or diversion of their apparatus.

**The Other Party or Contractor should have particular regard to the possibility of encountering Vodafone apparatus (including ducts and cables), at depths of cover other than that reported.**

Surface cables (such as cables on bridges or walls) which are liable to be placed in danger from the Other Parties or Contractors works shall be protected, at the Other Parties expense, as directed by the Vodafone representative.

## 9. Separation

Reference should be made to HSG47 to ensure that adequate separation is achieved. The following details outline the specific requirements of Vodafone and capture the HSG47 requirements.



### 9.1 High voltage cables

High voltage single core cables of 1000 V and above shall have a minimum clearance from Company Apparatus of 500 mm.

High voltage multi-core cables of 1000 V and above shall have a minimum clearance from Company Apparatus of 350 mm.

In exceptional circumstances where the above clearances cannot be maintained, the separating distance may be reduced to a minimum of 175 mm. In such circumstances, concrete, of a quality as directed by the Company Representative, must be inserted to completely fill the space between the High Voltage cable and the Company Apparatus, in accordance with the requirements of the Company Representative. Any further services must have a minimum clearance of 250 mm from the concrete.

### 9.2 Low voltage cables

Low voltage cables of less than 1000 V shall have a minimum clearance from Company Apparatus of 180 mm. In exceptional circumstances where the above clearance cannot be maintained, the separating distance may be reduced to a minimum of 75 mm. In such circumstances, concrete, of a quality as directed by the Company Representative, must be inserted to completely fill the space between the services, in accordance with the requirements of the Company Representative. Any further services must have a minimum clearance of 250 mm from the concrete.

### 9.3 Ancillary electrical apparatus

Lamp posts, traffic posts and other such ancillary electrical apparatus shall have a minimum clearance of 150 mm from underground Company Apparatus and 600mm clearance from above ground Company Apparatus.

### 9.4 High pressure gas mains and other Undertakers plant/equipment

High pressure gas mains shall have a minimum clearance of 450 mm from Company Apparatus. All other undertakers' plant and equipment, when running in parallel with Company Apparatus, shall have a minimum clearance of 200mm. Where gas mains cross Company Apparatus, the minimum clearance shall be 200mm. All other undertakers' plant and equipment, when running across Company Apparatus, shall have a minimum clearance of 100 mm.

### 9.5 Other Undertakers plant

Other undertakers' plant and equipment which runs in parallel with Company Apparatus shall have a minimum clearance of 200mm. All other undertakers' plant and equipment when running across Company Apparatus shall have a minimum clearance of 100mm.

### 9.6 Tramways

Each separating distance shall be individually agreed with the Company Representative.





## 10. Jointing chambers

### 10.1 Protection

Footway type jointing chambers are not designed to withstand carriageway loadings.

Where such chambers are liable to be placed at risk, either temporarily or permanently, from vehicular traffic or from the movement of plant and/or equipment, they will need to be adequately protected. Alternatively, they may have to be demolished and rebuilt to carriageway standards, at the Other Parties or Contractors expense under supervision of Vodafone representative.

All Vodafone jointing chambers and / or other access points shall be kept clear and unobstructed. Access for vehicles, winches, cable drums and / or any further equipment required by Vodafone for the maintenance of its apparatus, must be maintained at all reasonable times.

### 10.2 Access

The covers to Vodafone jointing chambers and / or apparatus shall only be lifted by means of the appropriate keys and under the direct supervision of a Cable & Wireless Worldwide representative. Other Parties or Contractors shall not enter any Vodafone jointing chamber and / or apparatus unless under the supervision of a Vodafone representative and in any case not before the mandatory gas test has been carried out in the presence of Vodafone representative and such checks have shown it to be safe to enter the Vodafone chamber and / or apparatus. The Other Parties or Contractors shall be given reasonable access to Vodafone apparatus and chambers when required.

## 11. Notification periods

Where the Other Parties or Contractors works or the movement of plant or equipment may endanger Vodafone apparatus, the Other Party or Contractor shall give the Vodafone agent Atkins Global [as indicated at Appendix B] at least 7 working days notice in writing of the intended date to commence operations.

No excavation should be made without first consulting the relevant Vodafone apparatus layout drawings, which will be made available from the Vodafone agent Atkins Global on request and allowing 28 working days for processing the relevant drawings. However, should this not be possible, direct contact should be made to the Atkins Global Bristol Plant Enquiries Team as soon as possible to assess the situation.

When excavating, moving or backfilling (including use of Foamed Concrete for Reinstatements – FCR) around Vodafone apparatus, Atkins Global (as agent for Vodafone) shall be given adequate prior written notice of the Other Parties or Contractors intentions, in order that the works may be adequately supervised. Such notice shall not be less than 3 working days.

## 12. Excavation and backfill

All excavations adjacent to Vodafone apparatus are to be carried out by hand until the extent and or location of the Vodafone apparatus is known.

Use of mechanical borers and / or excavators shall not be used without the supervisory presence of a Vodafone representative or a given exemption.

Shuttering of the excavation or support to Vodafone apparatus, at the Other Parties or Contractors expense, shall be used as directed by the Vodafone representative.

At least 7 working days notice must be given to Vodafone in order that any special protective measures which may be required to protect Vodafone apparatus, at the Other Parties or Contractors expense, when equipment such as pile driving, explosives, laser cutting high powered RF equipment or RF test gear, is to be used in conjunction with the works.

Other Parties or Contractors are advised to refer to the National Joint Utilities Group [NJUG] 4 Document which outlines the identification of small buried mains and services.



## 13. Foam concrete

If foam concrete is being used as the backfill material, it shall not be used either above or within 500 mm of any Company Apparatus. A suitable material in accordance with the specification for the Reinstatement of Openings in Highways shall be substituted.

## 14. Attendance of Company Representative

If a situation requires the attendance on site of a Vodafone representative for a continuous period of more than 6 hours, suitable facilities shall be provided by the Other Party or Contractor, at their expense, to meet the office and ablution requirements.

## 15. Damage reports

In the event of any damage whatsoever occurring to Vodafone apparatus, the Other Party or Contractor shall immediately inform Vodafone by contacting Julia Burgoyne, (for contact details please refer to Appendix B).

All relevant costs of any subsequent repair and / or removal of the Vodafone apparatus shall be charged to the Other Party or Contractor, irrespective of who affects the repair.

The above requirements do not relieve the Other Party or Contractor of any of their obligations under their contract.



## Appendix A - office address details

### **Glasgow Office**

Vodafone  
Pavillion 1  
1 - 2 Berkeley Square  
99 Berkeley Street  
Glasgow  
G3 7HR

### **Bristol Office**

Vodafone  
Unit 1,  
Tamar Road  
St Philips  
Bristol  
BS2 0TY

### **Manchester Office**

Vodafone  
Unit M  
Atlas Business Park  
Wythenshawe  
Manchester  
M22 5RR



## Appendix B – Street Works Team Contacts for Vodafone

Function	Name	Job Title	Address	Phone	Mobile	Fax	Email Address
Co-ordination	Sandra Semple	National Street Works Manager	Glasgow Office (see above)	0141 303 2857	07775 792133	0141 300 9611	sandra.semple@cw.com
Customer Complaints	CMC	Customer Management Centre	n/a	08456 021585	n/a	n/a	n/a
Liability Claims	Julia Burgoyne	Major Incident Resolution Coordinator	Bristol Office (see above)	01454 895114	07803 259857	n/a	julia.burgoyne@cw.com
Diversiory Works	Samantha Wilkinson	C3 Diversiory Works Project Controller	Manchester Office (see above)	0161 423 2740	n/a	n/a	samantha.wilkinson@cw.com
Emergencies (24 Hour)	CMC	Customer Management Centre	n/a	08456 021585	n/a	n/a	n/a
Plant Enquiries- Including Thus Plc, (formerly Scottish Telecom), Your Comms (formerly Norweb), Energis & Mercury Communications	Plant Enquiries Team	n/a	Atkins Global PO Box 290 500 Aztec West, Almondsbury, Bristol, BS32 4RZ	01454 662881	n/a	01454 663330	Osm.Enquiries@atkinsglobal.com



## 16. About this Document

### Content Owner

Price, David J

### Changes since last version

Reformatted using the current Vodafone template.

End of Document

