

ADVICE TO CONTRACTORS ON AVOIDING DANGER FROM BURIED ELECTRICITY CABLES.

- 1) Do have cable drawings with you on site and check them before you start the excavation.
 - 2) Use a cable locator tool on site and use it to help you.
 - 3) Mark out the location of electricity cables.
 - 4) Do not use a mechanical excavator within 0.5m of electricity cables.
 - 5) Use spades and shovels in preference to other tools.
 - 6) Never disturb electricity cables and joints or their protective covers.
- IF IN DOUBT - ASK! PHONE 0800 056 8666
EMERGENCY - If you damage a cable or live
Phone 0800 780 0780 (24hrs) URGENTLY
- These basic safety precautions are explained in detail in the HSE booklet, HSC014, 'Working Safely in the Ground' and Services, a copy of which may be obtained from your supervisor or HNSO.
- Please be aware that electric lines belonging to other owners of licensed electricity distribution systems may be present and it is your responsibility to identify their location.

1. UK Power Networks does not warrant that the information provided to you is correct. You rely upon it at your own risk.

2. UK Power Networks does not exclude or limit its liability if it causes the death of any person or causes personal injury to a person where such death or personal injury is caused by its negligence.
 3. Subject to paragraph 2, UK Power Networks has no liability to you in contract, in tort (including negligence), for breach of statutory duty or otherwise howsoever for any loss, damage, costs, claims, demands, or expenses that you or any third party may suffer or incur as a result of using the information provided whether for business or otherwise, or for any loss of opportunity, loss of savings, loss of goodwill, loss of business, loss of use or any special or consequential loss or damage whatsoever.
- Reproduced by permission of Ordnance Survey on behalf of HMSO. (c) Crown copyright 1999. Ordnance Survey Licence No. 100019623. The Ordnance Survey name and logo are registered trademarks of Ordnance Survey. All other rights reserved. Ordnance Survey and the Ordnance Survey logo are the property of (c) Eastern Power Networks plc or London Power Networks plc each being a distribution licensee under section 6(1)(c) of the Electricity Act 1989 for the relevant distribution services area as that term is defined in such licensee's distribution licence. All rights in such data reserved.

PRIMARY CABLES
EXTRA HIGH VOLTAGE CABLES (EHV) 22,000 TO 132,000 Volts

- Depth normally 750mm cover in carriageway & 600mm cover in footway.
- Before digging within one metre of these cables, contact the Company's telephone 0800 056 5966 in order that the Company's apparatus may be located on site and any necessary protection works agreed.
- N.B. THRUST BORERS OR MOLES MUST NOT BE USED WITHIN THE VICINITY OF ANY CABLES BELONGING TO UK POWER NETWORKS WITHOUT FIRST CONTACTING THIS COMPANY.**
1. The position of the apparatus shown on this drawing is believed to be correct but the original particulars may have been altered since the apparatus was installed.
 2. All cables must be verified - use approved cable avoidance tools prior to excavation using suitable hand tools.
 3. It is essential that trial holes are carefully made avoiding the use of mechanical tools or picks until the exact location of all cables has been determined.
 4. It must be assumed that there is a service cable into each property, lamp column and street.
 5. All cables must be treated as being live unless proved otherwise by UK Power Networks.
 6. The information provided must be given to all people working near UK Power Networks' plant & equipment. Do not use plans more than 3 months after the issue date for excavation purposes.
 7. Please be aware that electric cables/lines belonging to other owners of licensed electricity distribution systems may be present and it is your responsibility to identify their location.

Plotted On : 13/10/2014
Plotted By : Lynda Blizard
Plot Description : Contents of plot menu line title line.1
Contents of plot menu line title line.2

Map Centre : 1028845W

UK Power Networks
Plan Provision
PSW/CH
Suffolk
IP3 BA
Tel 0800 0565 866
Fax 06701 963782

For details of the symbology please refer to
<http://www.electrify-safety.com/psw/for-the-workshop/understanding-safety-symbols.html>

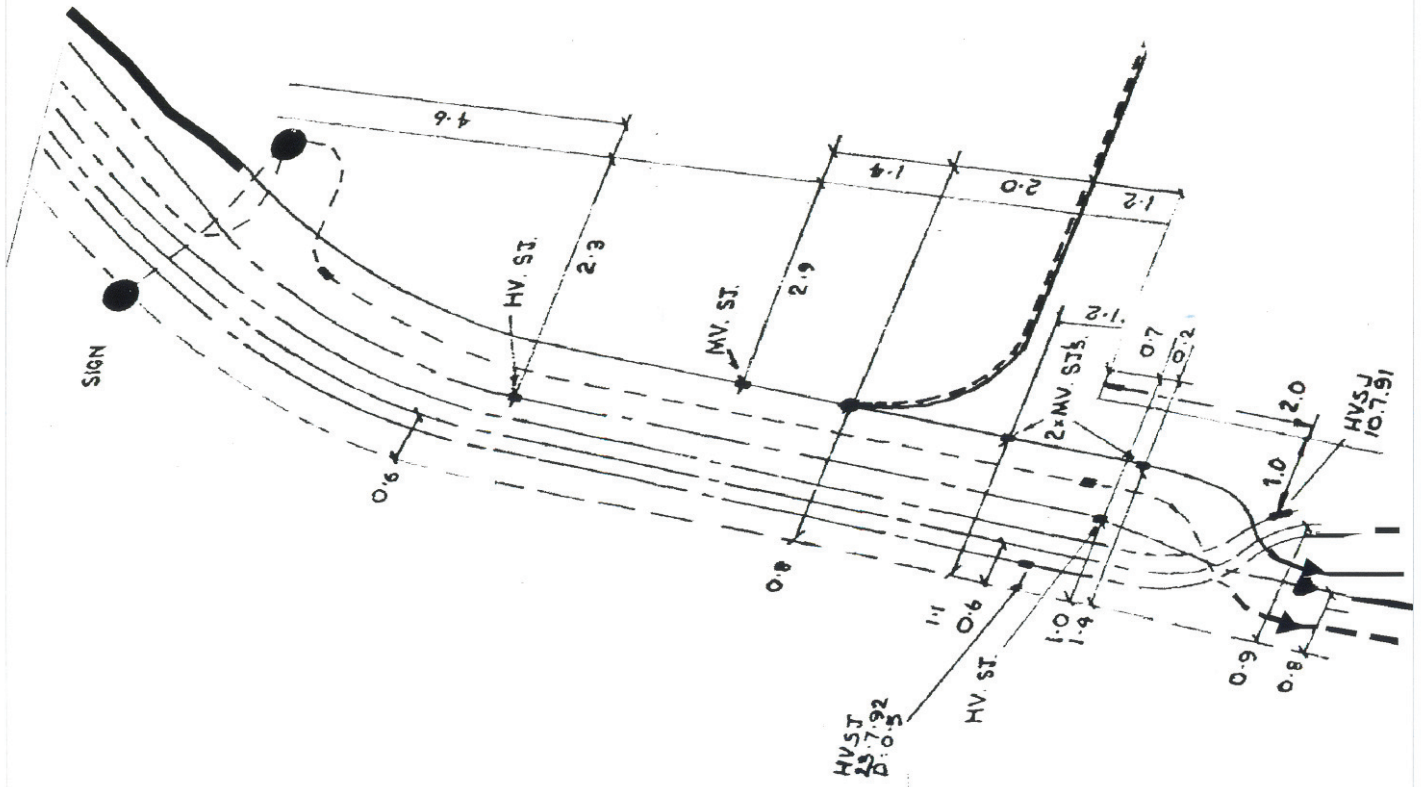

384
 N/1
 46.21/A

Comp Raster TQ2884 SW N

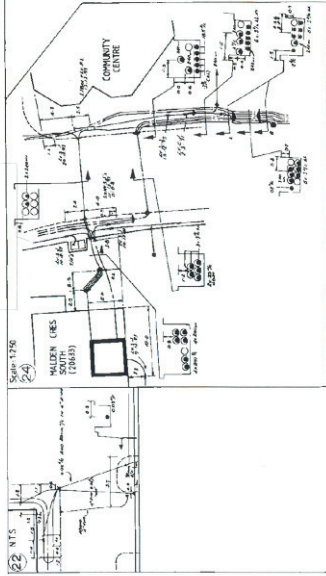

NORTHERN AREA
261 City Road, EC1V 1LE Tel. 071-251 5161

Sheet 1 TQ 2884 SW-N/1

46.21/A

46.21

IM201 TQ 2884-RWS

46.21

46.21

46.21



(N 21) TQ 2884 SE-N

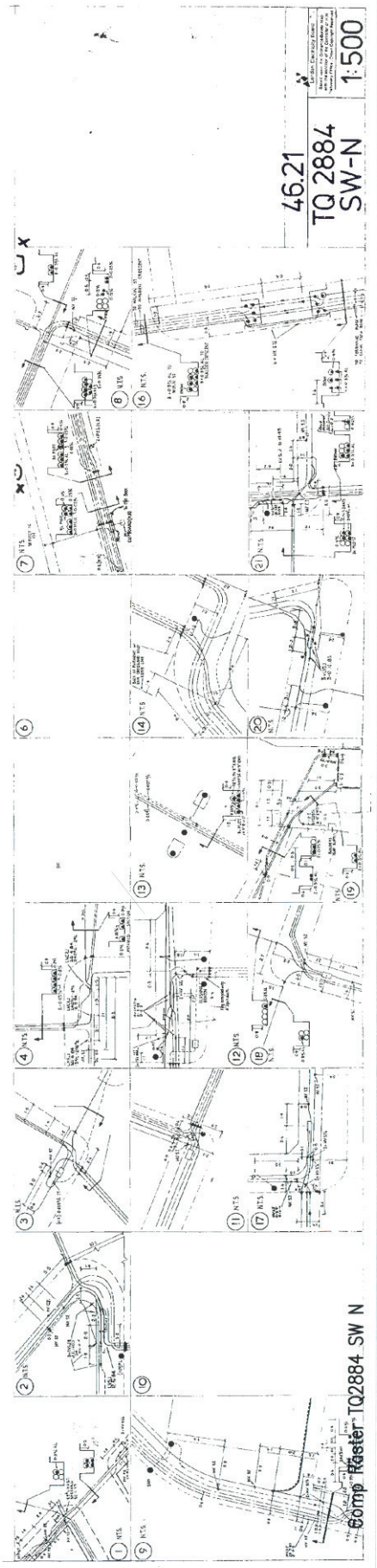

46.21
TQ 2884
SW-N
1:500

Comp Master TQ2884 SW N

(N19) TQ 2784 SE-N