

Application for tree works: works to trees subject to a preservation order (TPO)
and/or notification of proposed works to trees in conservation areas (CA).

Town and Country Planning Act 1990

Publication of planning applications on council websites

Please note that with the exception of applicant contact details and Certificates of Ownership, the information provided on this application form and in supporting documents may be published on the council's website.

If you have provided any other information as part of your application which falls within the definition of personal data under the Data Protection Act which you do not wish to be published on the council's website, please contact the council's planning department.

Please complete using block capitals and black ink.

It is important that you read the accompanying guidance notes as incorrect completion will delay the processing of your application.

1. Applicant Name and Address	2. Agent Name and Address
Title: <input type="text"/> First name: <input type="text"/>	Title: <input type="text"/> First name: <input type="text"/>
Last name: <input type="text"/>	Last name: <input type="text"/>
Company (optional): <input type="text"/> LONDON DIOCESAN FUND	Company (optional): <input type="text"/> CUSTOM CUTTERS TREE SPECIALISTS LTD
Unit: <input type="text"/> House number: <input type="text"/> 36 House suffix: <input type="text"/>	Unit: <input type="text"/> House number: <input type="text"/> 46 House suffix: <input type="text"/>
House name: <input type="text"/>	House name: <input type="text"/>
Address 1: <input type="text"/> CAUSTON STREET	Address 1: <input type="text"/> STANLEY ROAD
Address 2: <input type="text"/>	Address 2: <input type="text"/> BOUNDS GREEN
Address 3: <input type="text"/>	Address 3: <input type="text"/>
Town: <input type="text"/> LONDON	Town: <input type="text"/> LONDON
County: <input type="text"/>	County: <input type="text"/>
Country: <input type="text"/>	Country: <input type="text"/>
Postcode: <input type="text"/> SW1P 4AU	Postcode: <input type="text"/> N11 2LE

3. Trees Location

Full address/location of the site where the tree(s) stand (including full postcode where available)

Unit:	<input type="text"/>	House number:	<input type="text" value="52"/>	House suffix:	<input type="text"/>
House name:	<input type="text" value="THE VICARAGE"/>				
Address 1:	<input type="text" value="COURTHOPE ROAD"/>				
Address 2:	<input type="text"/>				
Address 3:	<input type="text"/>				
Town:	<input type="text" value="LONDON"/>				
County:	<input type="text"/>				
Postcode (if known):	<input type="text" value="NW3 2LD"/>				

If there is not a full postal address, describe as clearly as possible where it is (for example, 'Land to the rear of 12 to 18 High Street' or 'Woodland adjoining Main Road') or provide a grid reference:

Easting:	<input type="text"/>
Northing:	<input type="text"/>

Description:

4. Trees Ownership

Is the applicant the owner of the tree(s): ☒ Yes ☐ No
If 'No' please provide the address of the owner (if known and if different from the trees location)

Title:	<input type="text"/>	First name:	<input type="text"/>
Last name:	<input type="text"/>		
Company (optional):	<input type="text"/>		
Unit:	<input type="text"/>	House number:	<input type="text"/>
House name:	<input type="text"/>		
Address 1:	<input type="text"/>		
Address 2:	<input type="text"/>		
Address 3:	<input type="text"/>		
Town:	<input type="text"/>		
County:	<input type="text"/>		
Country:	<input type="text"/>		
Postcode:	<input type="text"/>		

Telephone numbers

Country code:	<input type="text"/>	National number:	<input type="text"/>	Extension number:	<input type="text"/>
Country code:	<input type="text"/>	Mobile number (optional):	<input type="text"/>		
Country code:	<input type="text"/>	Fax number (optional):	<input type="text"/>		
Email address (optional): <input type="text"/>					

5. What Are You Applying For?

Are you wishing to carry out works to tree(s) in a Conservation Area (CA)? ☒ Yes ☐ No

Are you seeking consent for works to tree(s) Subject to a Tree Preservation Order (TPO)? ☐ Yes ☐ No

6. Tree Preservation Order Details

Do you know the title of the Tree Preservation Order (TPO)? ☐ Yes ☐ No

If Yes, please provide the title of the TPO:

7. Identification Of Tree(s) And Description Of Works

Please identify the tree(s) and provide a full and clear specification of the works you want to carry out. Enter the species of the tree(s) and include a sketch plan showing position(s) of the tree(s) in relation to buildings, named roads and boundaries.

If the trees are protected by a TPO, if possible please number them as shown in the First Schedule to the Tree Preservation Order (for example T3 Oak; two Beech and one Birch in G2; seven Ash in A1; sycamore in W1).

Trees and proposed works:

PLEASE SEE ATTACHED TREE WORK SPECIFICATIONS
MAINTENANCE WORKS IN LINE WITH GOOD ARBORICULTURAL PRACTICE

You might find it helpful to consult a tree surgeon to clarify what needs to be done.

Please state the reference number you have given the plan:



CLIENT

LONDON DIOCESAN FUND
36, CAUSTON STREET,
LONDON,
SW1P 4AU

AGENT

CUSTOM CUTTERS TREE SPECIALISTS LTD
46, STANLEY ROAD,
BOUNDS GREEN,
LONDON,
N11 2LE

Tree Work Specifications
For
The Vicarage,
52, Courthope Road,
London,
NW3 2LD

Front of the property

- | | | |
|----------|---|---|
| 5 Limes | - | Crown reduce back to previous pollard points
Remove trunk and basal growth |
| Laurels | - | Reduce and trim |
| Laburnum | - | Trim and prune as necessary |

Side of the property

- | | | |
|---------|---|---|
| 3 Limes | - | Crown reduce height and spread by 25%
Prune to balance crowns
Remove any honeysuckle re-growth
Remove trunk and basal growth |
|---------|---|---|

Rear of the property

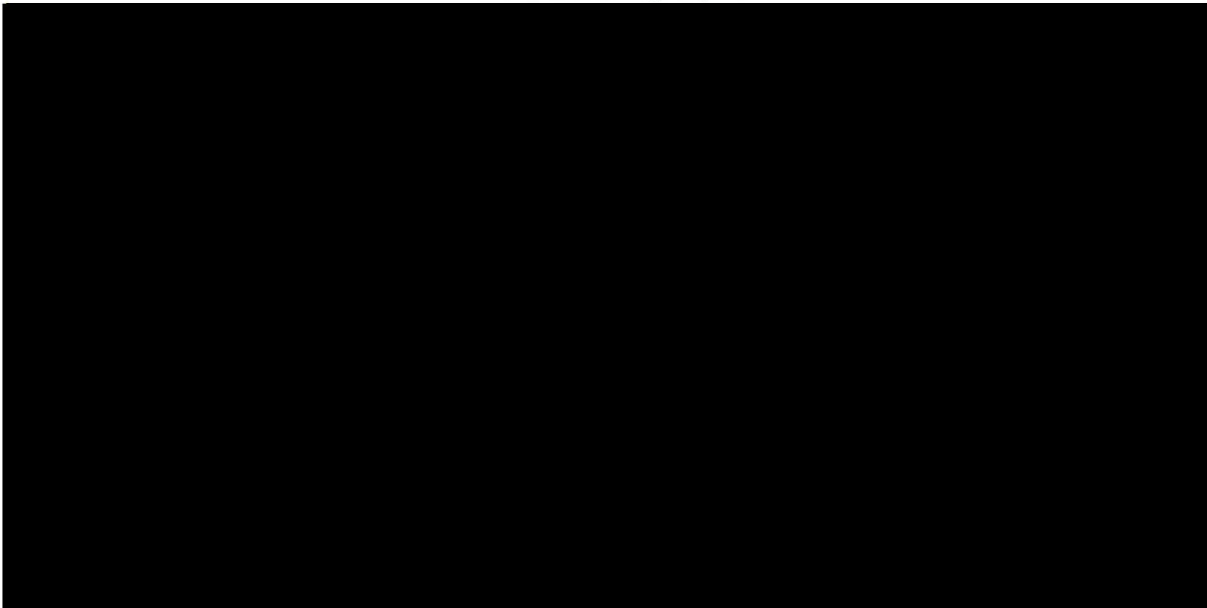
- | | | |
|------------|---|---|
| Sycamore | - | Crown reduce height and spread by 20%
Thin throughout the crown by 15%
Reduce extremities of branches growing towards the property to give a clearance of 2m
Remove all deadwood |
| 2 Conifers | - | Crown reduce height by 40% |
- 

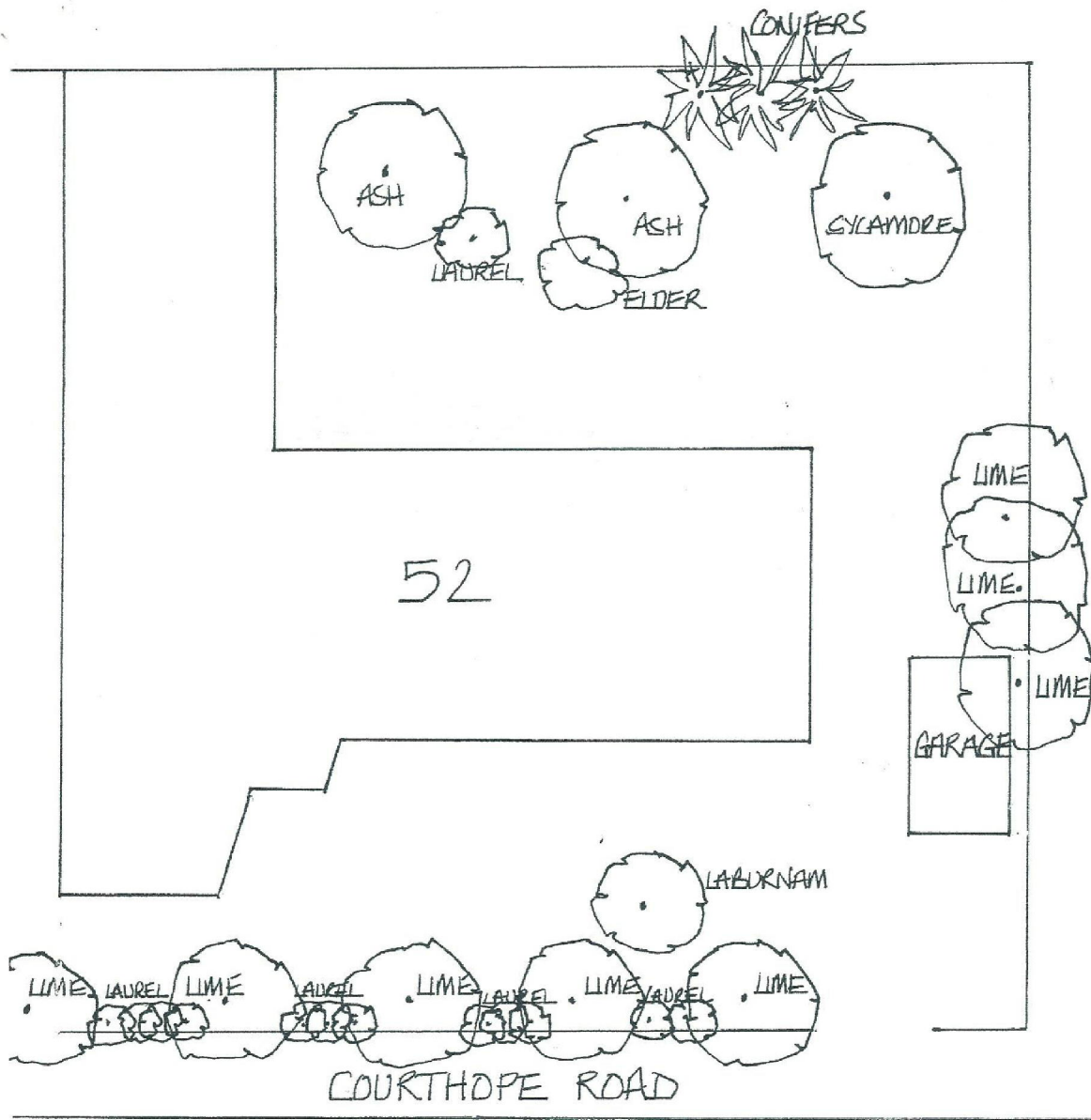

8. Trees - Reasons For Works

This section only needs to be completed if you are seeking consent to trees under a Tree Preservation Order (TPO)

Please state the reasons for carrying out the proposed works on the tree(s):

Please indicate whether the reasons for carrying out the proposed works include any of the following. If so, your application must be accompanied by the documents specified.

Health or safety of the tree(s) - e.g. it is diseased, fears that it might break or fall:

☐ Yes

☐ No

If Yes, information required - report by a tree professional (e.g. arboriculturist, horticultural adviser).

Alleged subsidence damage:

☐ Yes

☐ No

If Yes, Information required: Full report by an engineer or surveyor, together with one from a tree professional - to include date and description of property damage; sub-soil type and shrinkage potential; location of any roots found and their identification; history of ground and building movement through a distortion survey and/or level or crack monitoring over suitable period; other vegetation in the vicinity and its management since discovery of the damage.

9. Trees - Additional Information

Are you providing additional information in support of your application?

☐ Yes

☐ No

If Yes, please provide the reference numbers of plans, documents, professional reports etc in support of your application:

10. Application For Tree Works - Checklist

Please use this checklist to ensure that the form has been completed correctly and that all relevant information is submitted.

For works to trees protected by a Tree Preservation Order, failure to supply sufficiently precise and detailed information may result in your application being rejected or delay in dealing with it. In particular, you MUST provide the following:

3 copies of a completed and dated application form. ☐

3 copies of a sketch plan showing the location of all tree(s). ☐

3 copies of a full and clear specification of the works to be carried out. ☐

3 copies of a statement of reasons for the proposed work. ☐

- evidence in support of statement of reasons. In particular, you should provide:

3 copies of a report by a tree professional (e.g. arboriculturist or horticultural adviser) if your reasons relate to the health and/or safety of the tree(s). ☐

3 copies of a report by an engineer or surveyor, together with one from a tree professional (arboriculturist) if you are alleging subsidence damage. ☐

For works to trees in conservation areas, it is important to supply precise and detailed information on your proposal. You may, therefore, wish to provide the following:

3 copies of a completed and dated form, with all questions answered. ☐

3 copies of a sketch plan showing the precise location of all tree(s). ☐

3 copies of a full and clear specification of the works to be carried out. ☐

Whether the trees are protected by a TPO or in a conservation area, please indicate which of the following types of additional information you are submitting (3 copies of each need to be provided):

- photographs. ☐

- report by a tree professional (arboriculturist) or other. ☐

- details of any assistance or advice sought from a Local Planning Authority officer prior to submitting this form. ☐

11. Declaration - Trees

I/we hereby apply for consent/give notice as described in this form and the accompanying plans and additional information.

Signed - Applicant:

Or signed - Agent:

Date (DD/MM/YYYY):

18/05/2016

(date cannot be pre-application)

12. Applicant Contact Details

Telephone number:

Country code:

Country code: Mobile number (optional):

Country code: Fax number (optional):

Email address (optional):

Extension number:

13. Agent Contact Details

Telephone numbers

Country code:

National number:

8365 7722

Extension number:

Country code: Mobile number (optional):

Country code: Fax number (optional):

Email address (optional):