

New partial basement extension to 14 Parliament Hill with raised garden terrace over. Overlooking & loss of privacy prevented through roof light & planting configuration to the raised terrace at 14 Parliament Hill. Demolition, temporary works, & groundworks construction along the boundary is simplified significantly through the coordination of works to 15a & 14 Parliament Hill. Construction work & time reduced.

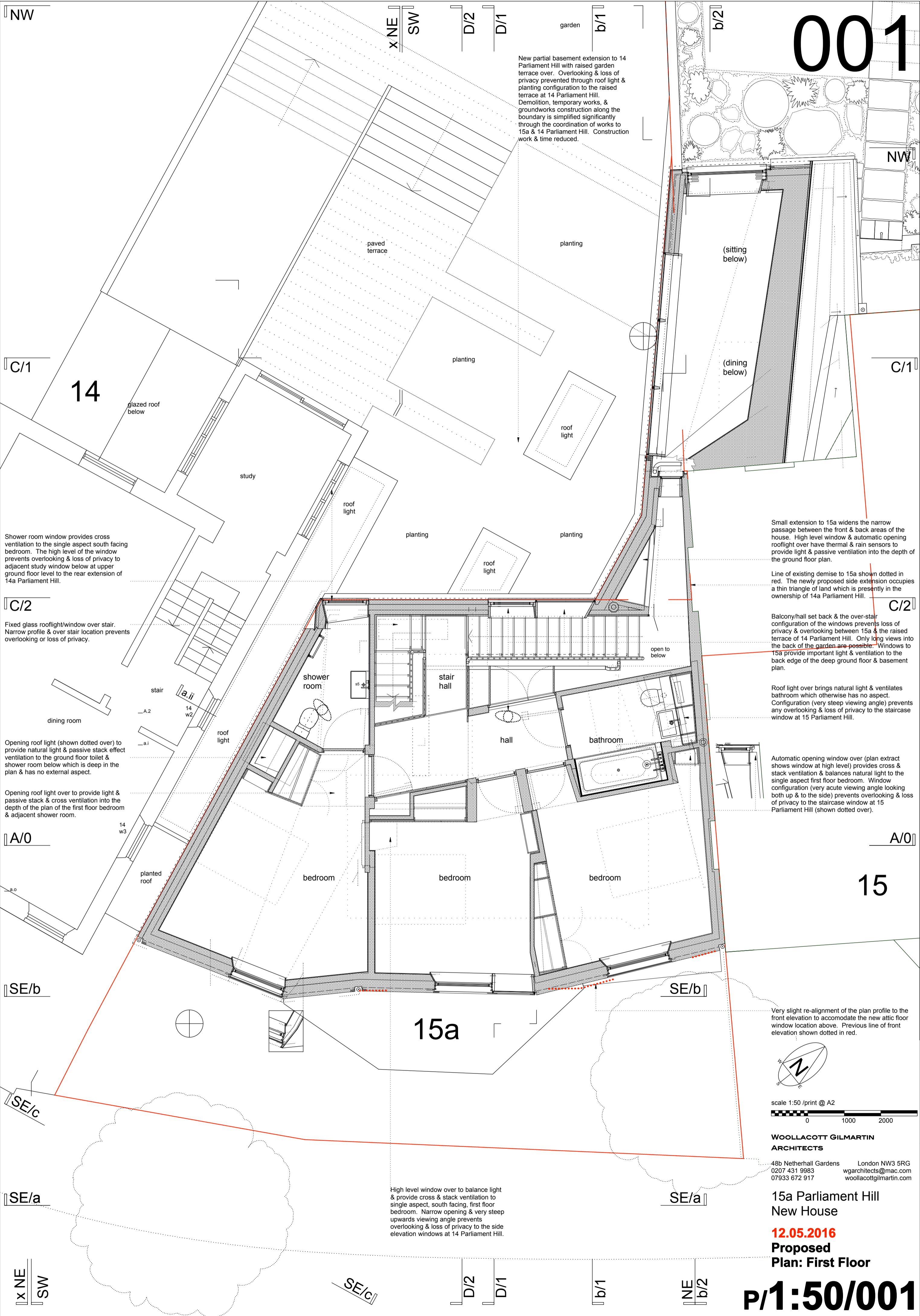

Shower room window provides cross ventilation to the single aspect south facing bedroom. The high level of the window prevents overlooking & loss of privacy to adjacent study window below at upper ground floor level to the rear extension of 14a Parliament Hill.

Fixed glass rooflight/window over stair. Narrow profile & over stair location prevents overlooking or loss of privacy.

Opening roof light (shown dotted over) to provide natural light & passive stack effect ventilation to the ground floor toilet & shower room below which is deep in the plan & has no external aspect.

Opening roof light over to provide light & passive stack & cross ventilation into the depth of the plan of the first floor bedroom & adjacent shower room.

High level window over to balance light & provide cross & stack ventilation to single aspect, south facing, first floor bedroom. Narrow opening & very steep upwards viewing angle prevents overlooking & loss of privacy to the side elevation windows at 14 Parliament Hill.

Small extension to 15a widens the narrow passage between the front & back areas of the house. High level window & automatic opening rooflight over have thermal & rain sensors to provide light & passive ventilation into the depth of the ground floor plan.

Line of existing demarcation to 15a shown dotted in red. The newly proposed side extension occupies a thin triangle of land which is presently in the ownership of 14a Parliament Hill.

Balcony/hall set back & the over-stair configuration of the windows prevents loss of privacy & overlooking between 15a & the raised terrace of 14 Parliament Hill. Only long views into the back of the garden are possible. Windows to 15a provide important light & ventilation to the back edge of the deep ground floor & basement plan.

Roof light over brings natural light & ventilates bathroom which otherwise has no aspect. Configuration (very steep viewing angle) prevents any overlooking & loss of privacy to the staircase window at 15 Parliament Hill.

Automatic opening window over (plan extract shows window at high level) provides cross & stack ventilation & balances natural light to the single aspect first floor bedroom. Window configuration (very acute viewing angle looking both up & to the side) prevents overlooking & loss of privacy to the staircase window at 15 Parliament Hill (shown dotted over).

Very slight re-alignment of the plan profile to the front elevation to accommodate the new attic floor window location above. Previous line of front elevation shown dotted in red.

scale 1:50 /print @ A2
0 1000 2000

WOOLLACOTT GILMARTIN ARCHITECTS

48b Netherhall Gardens London NW3 5RG
0207 431 9983 wgarchitects@mac.com
07933 672 917 woollacottgilmartin.com

15a Parliament Hill New House

12.05.2016
Proposed
Plan: First Floor