

- Notes:
1. All scaled dimensions are to be confirmed with the Architect / Project Manager.
 2. All notated dimensions are to be taken in preference to the scaled dimensions.
 3. All dimensions must be checked on site before fabrication.
 4. Any errors or omissions must be reported to the Architect / Project Manager.
 5. All rights described in Chapter IV of the Designs and Patents Act 1988 have been generally asserted.
 6. This drawing is not to be produced in part or whole without prior express permission of Gartner Lewin Ltd.
 7. Materials & workmanship shall be to the best of their respective kind and in accordance with all current British Standards & Codes of Practice Statutory Authority & Manufacturers Recommendations/specifications.

Rev	By	Chd	Date	Notes
-	-	-	-	-
-	-	-	-	-
-	-	-	-	-
-	-	-	-	-
-	-	-	-	-
-	-	-	-	-
-	-	-	-	-

Issued for
INFORMATION
Date
1ST, DECEMBER, 2015

Office
GARTNER LEWIN.
10 - 12 PERRINS COURT
LONDON, NW3 1QS
Shelagh@gartnerlewin.com
0207 435 5688

Client
PRIVATE CLIENT

Job title
25 CHESTER TERRACE
LONDON, NW1 4ND

Drawing title
SECOND FLOOR
- EXISTING PLAN

Scale 1:50@A3	Date drawn 12.01.2016		
Designed by SGL	Drawn by HR	Checked by SGL	Approved by SGL
Drawing number P1029-GL-104	Revision -		

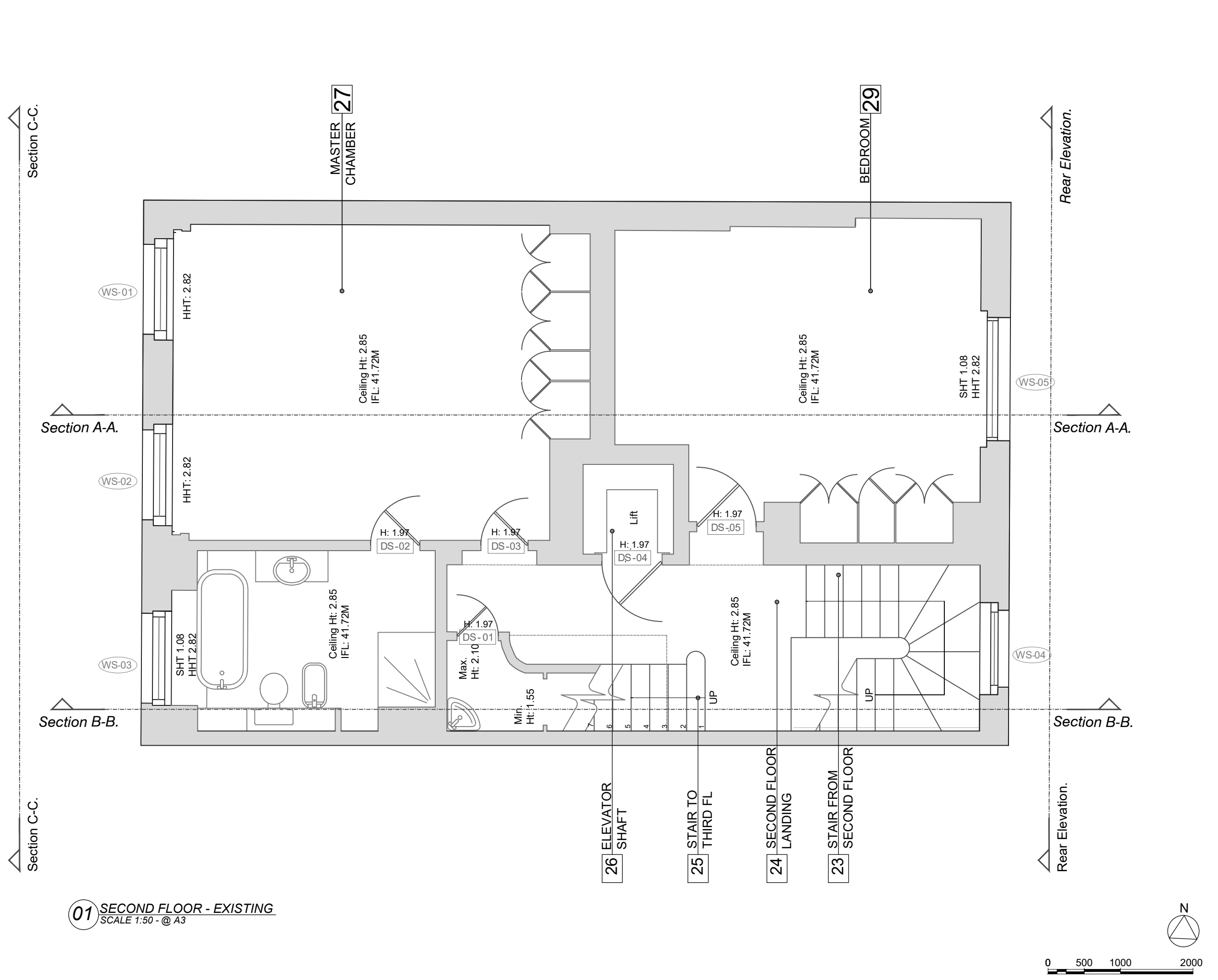

01 SECOND FLOOR - EXISTING
SCALE 1:50 - @ A3

