

**LOWER GROUND FLOOR STAIR & BALUSTRADE DETAILS**  
SCALE - 1:20

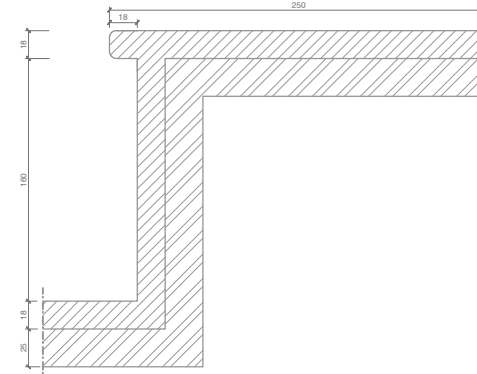

**STAIR DETAIL 03**  
SCALE - 1:5

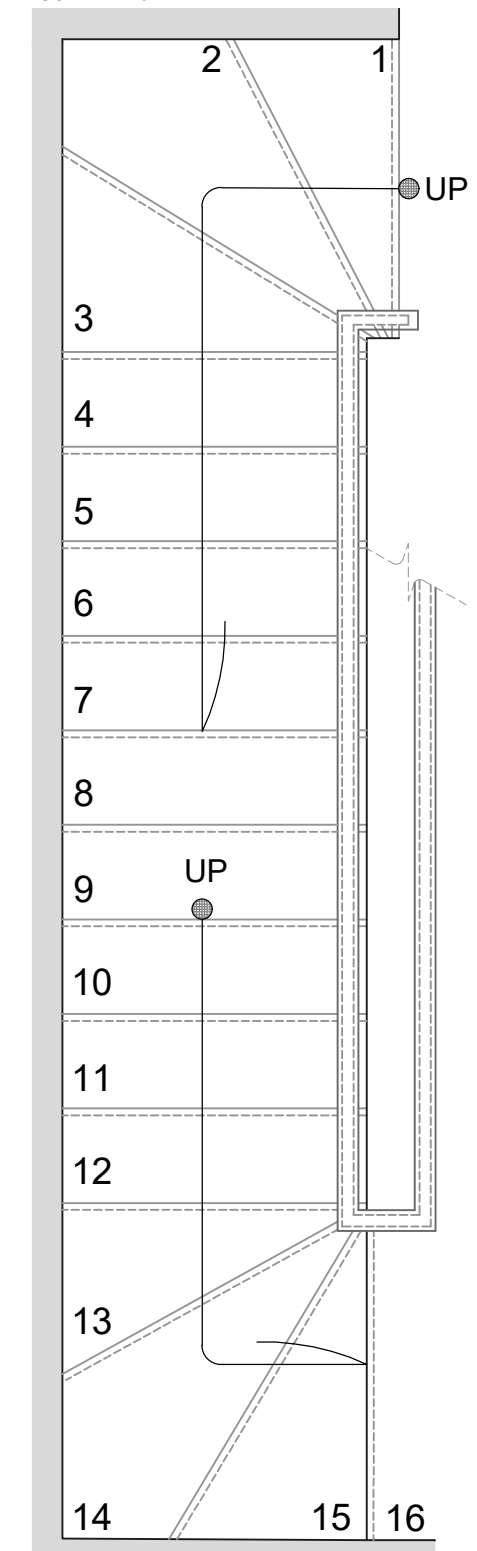

**STAIR PLAN**  
SCALE - 1:20

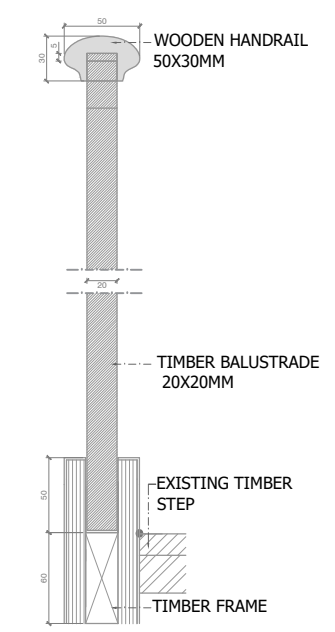

**BALUSTRADE DETAIL 02**  
SCALE - 1:5

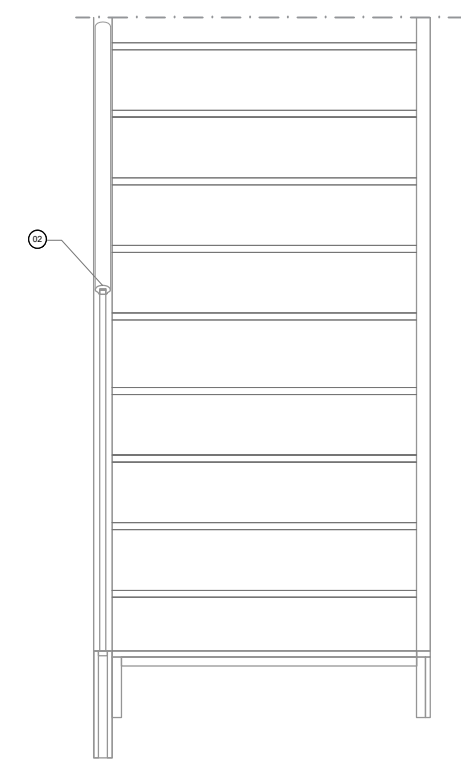

**STAIR DETAIL 01**  
SCALE - 1:20

- Note:**
- STAIR TO BE RETAINED
  - HANDRAIL AND BALUSTRADE TO MATCH AS EXISTING  
SEE DRAWING GL-909 - IMAGE NO 2
1. WOODEN HANDRAIL - DARK STAIN TIMBER
  2. BALUSTRADE/SPINDLES TIMBER PAINTED BLACK
  3. CARPET FINISH ON STAIR

**Notes:**

1. All scaled dimensions are to be confirmed with the Architect / Project Manager.
2. All notated dimensions are to be taken in preference to the scaled dimensions.
3. All dimensions must be checked on site before fabrication.
4. Any errors or omissions must be reported to the Architect / Project Manager.
5. All rights described in Chapter IV of the Designs and Patents Act 1988 have been generally asserted.
6. This drawing is not to be produced in part or whole without prior express permission of Gartner Lewin Ltd.
7. Materials & workmanship shall be to the best of their respective kind and in accordance with all current British Standards & Codes of Practice Statutory Authority & Manufacturers Recommendations/specifications.

Rev	By	Ch'd	Date
-	-	-	-
Notes			
-	-	-	-
Notes			
-	-	-	-
Notes			
-	-	-	-
Notes			
-	-	-	-
Notes			
-	-	-	-
Notes			

Issued for			
<b>INFORMATION</b>			
Date	1ST, DECEMBER, 2015		
Office	<b>GARTNER LEWIN.</b> 10 - 12 PERRINS COURT LONDON, NW3 1QS Shelagh@gartnerlewin.com 0207 435 5688		
Client	PRIVATE CLIENT		
Job title	25 CHESTER TERRACE LONDON, NW1 4ND		
Drawing title	PROPOSED BALUSTRADE GROUND FLOOR TO LOWER FLOOR		
Scale	Date drawn		
1:20@A3	12.01.2016		
Designed by	Drawn by	Checked by	Approved by
SGL	HR	SGL	SGL
Drawing number	Revision		
P1029-GL-806	-		