

Notes

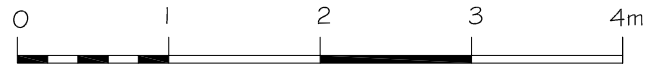

existing window to be removed

timber deck

window and Juliet balcony as part of previous planning permission 2015/2657/P

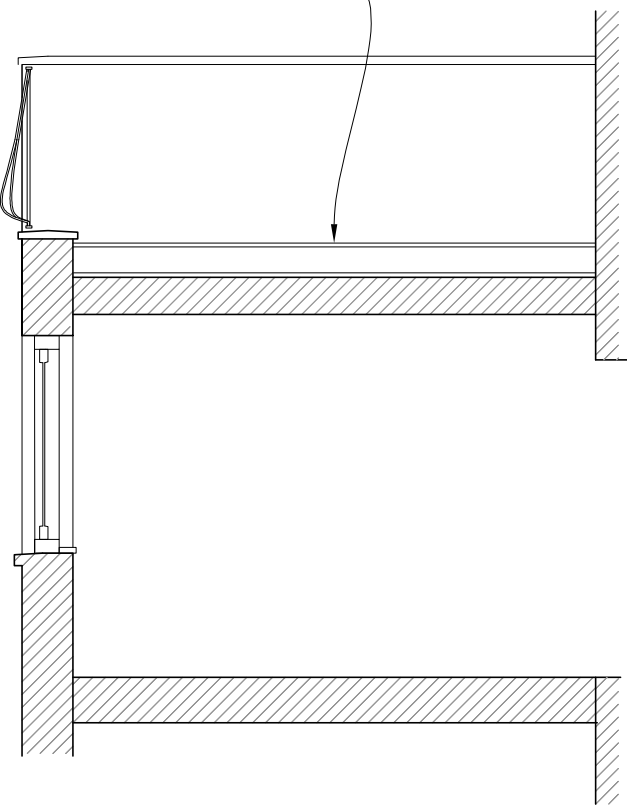

SECTION

section of wall to be removed

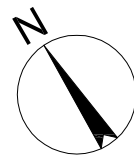
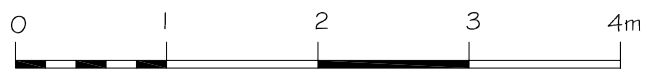

REAR ELEVATION

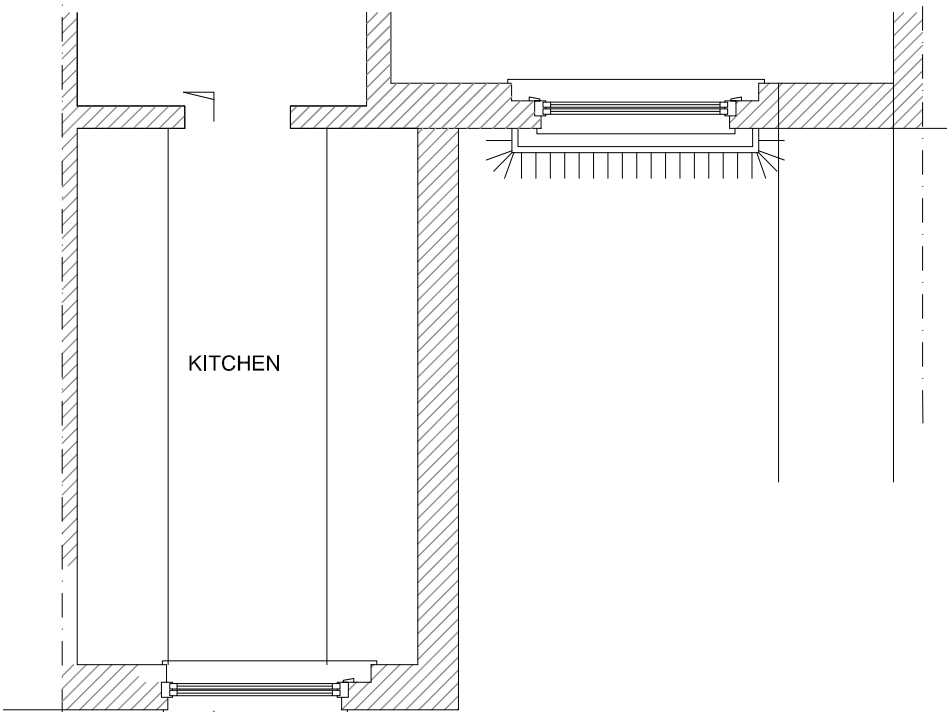

FIRST FLOOR PLAN

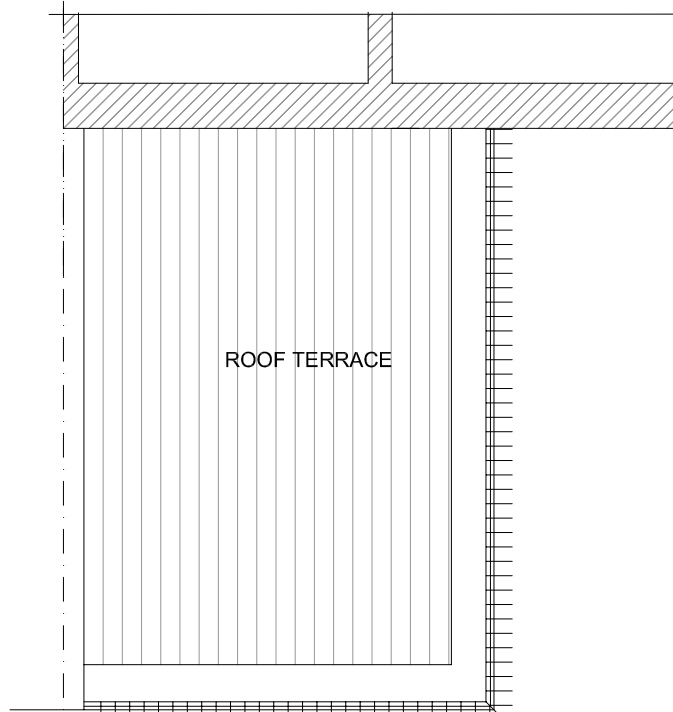

ROOF PLAN

Revisions

# AIVARS ARCHITECTS

Aivars Architect Ltd. Company No. 04648728

43B Eton Avenue . London NW3 3EP England  
Tel 44(0)20 7794 5411 - Fax 44(0)870 7061949  
ca@aivarsarchitects.com

**FIRST FLOOR FLAT  
157 GLOUCESTER AVE  
LONDON NW1 8LA**

Drawing Title

**EXISTING**

Scale: 1:50@A3 Issued: MAY 2015

Status: **PLANNING**

Job No. <b>211/P</b>	Dwg. No. <b>/ 04</b>	Rev.
-------------------------	-------------------------	------