

1 Gower PI Typical Window Elev
A1000 SCALE 1:20@A1

2 Ex Typical Window Sect
A1000 SCALE 1:20@A1

3 Prop Typical Window Sect
A1000 GOWER COURT - SCALE 1:20@A1

4 Prop Typical Window Section
A1000 WITH SECONDARY GLAZING - SCALE 1:20@A1

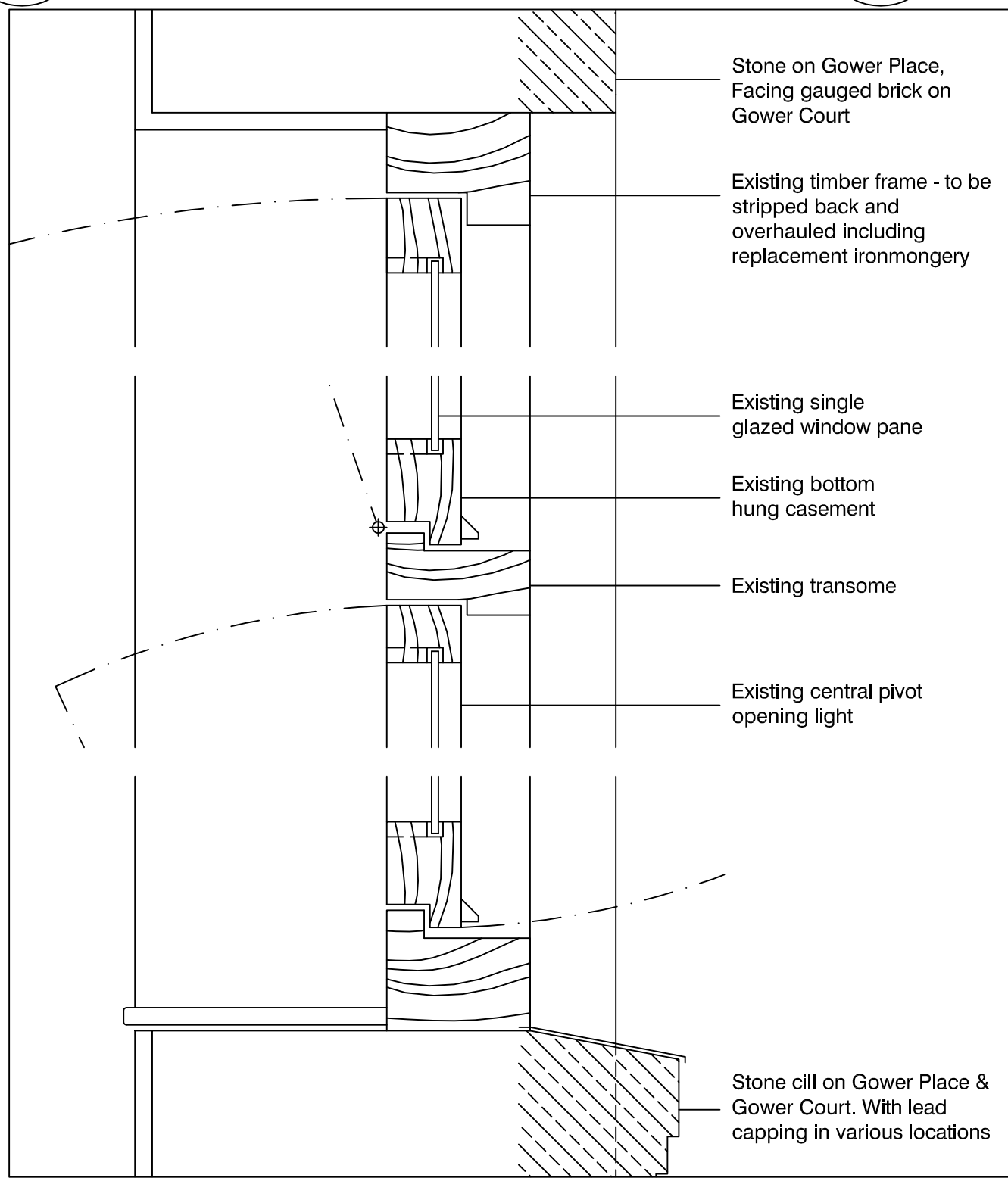

6 Gower PI & Ct Typical Window Section
A1000 SCALE 1:20@A1

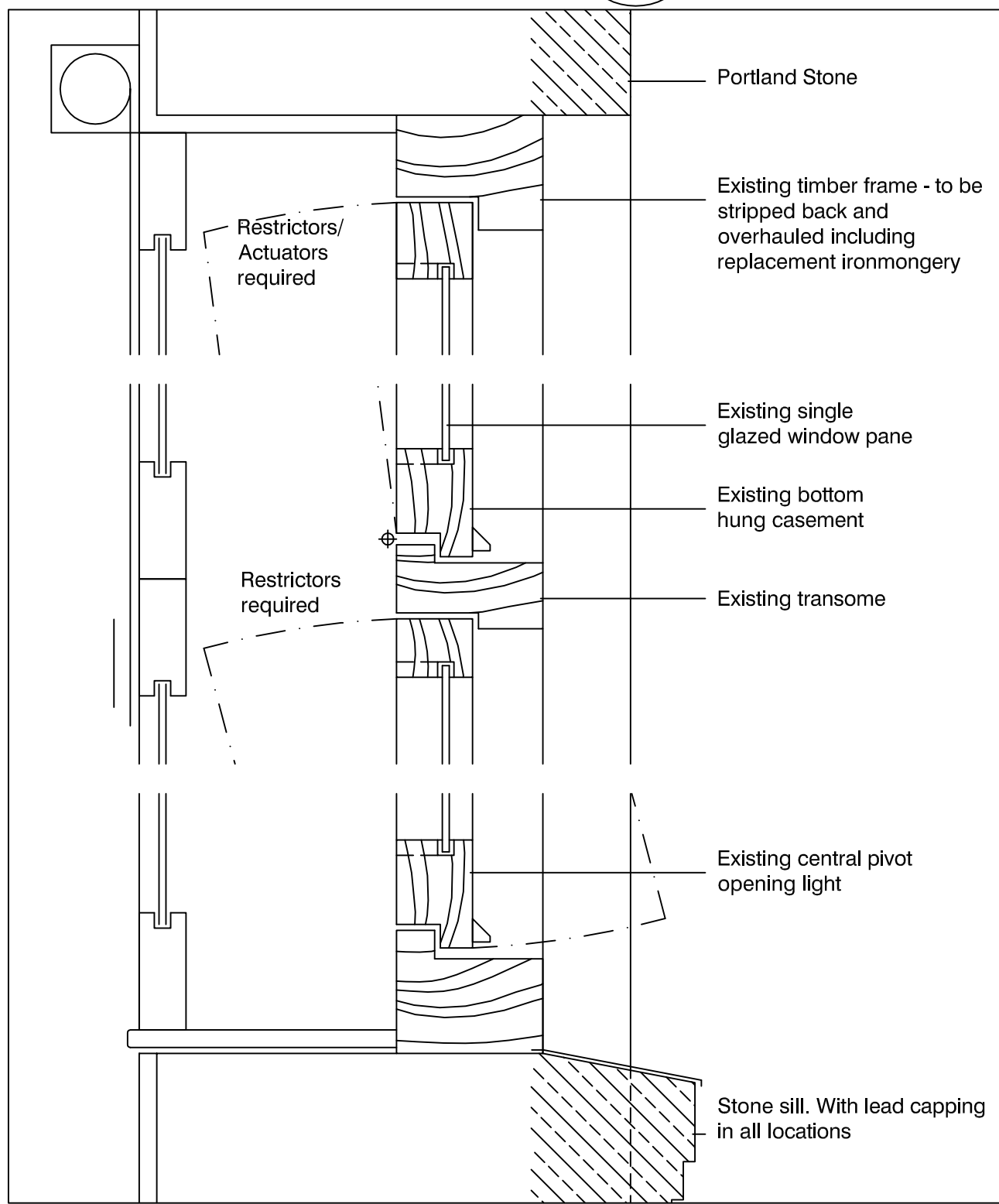

7 Gower PI Typical Window Section
A1000 WITH SECONDARY GLAZING - SCALE 1:20@A1

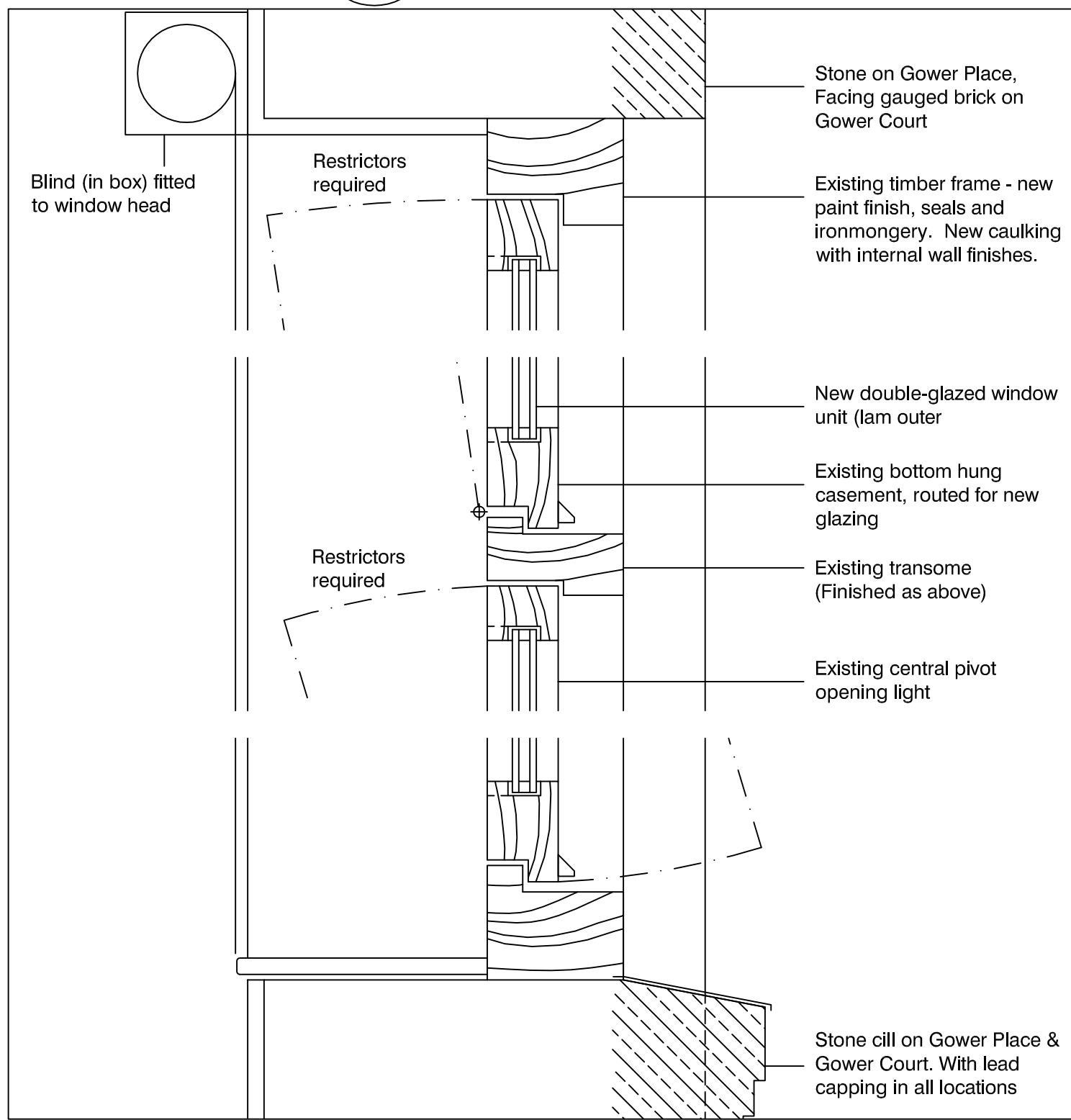

8 Gower Ct Typical Window Section
A1000 SCALE 1:20@A1

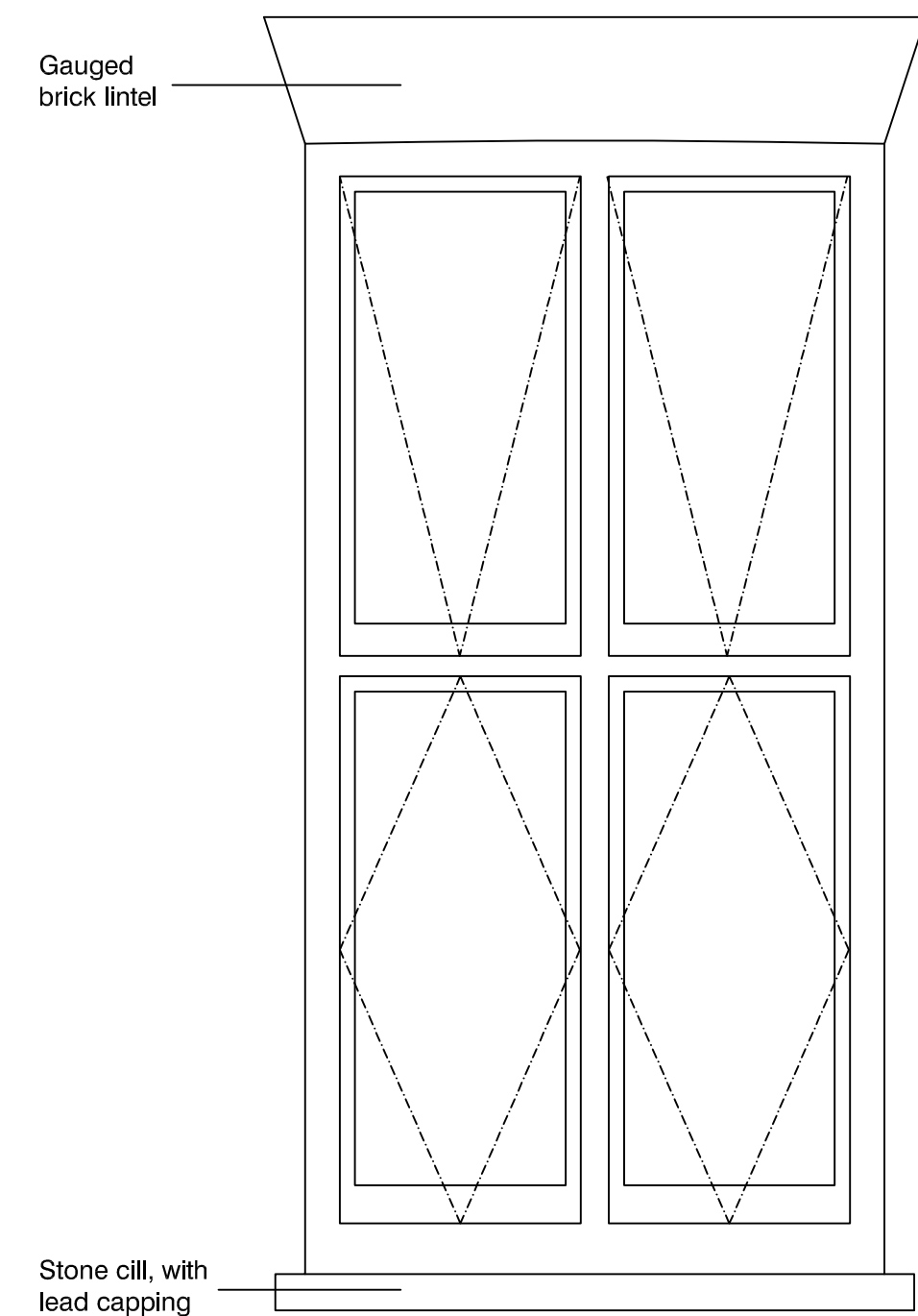

5 Gower Court Typical Window Elevation
A1000 SCALE 1:20@A1

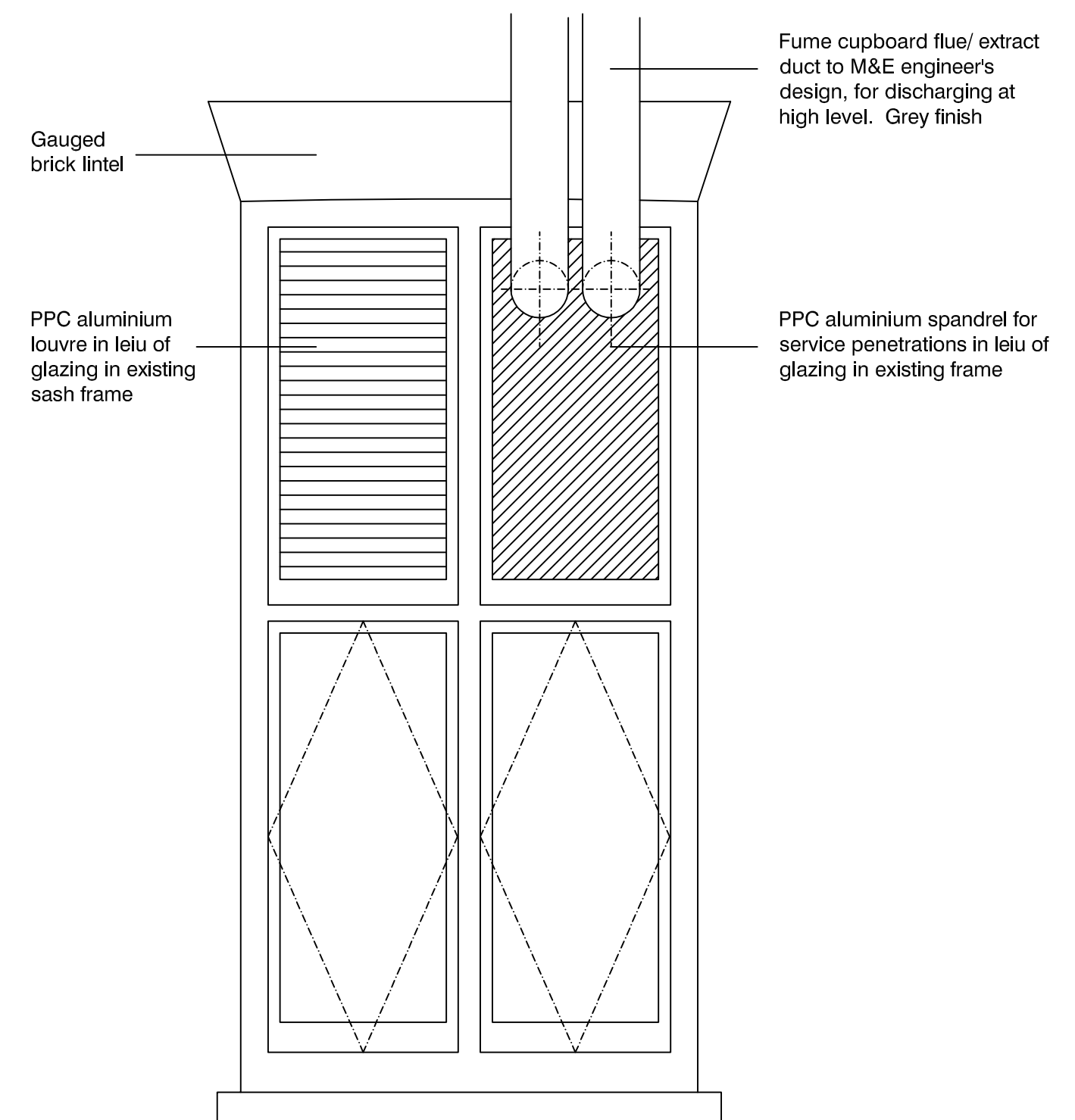

9 Gower Court Window with Services Elevation
A1000 SCALE 1:20@A1

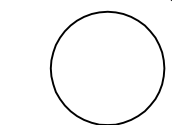

standard notes

1. Do not scale this drawing.
2. All dimensions must be checked on site and any discrepancies verified with the architect.
3. Unless shown otherwise, all dimensions are to structural surfaces.

THIS IS NOT A CONSTRUCTION DRAWING, IT IS UNSUITABLE FOR THE PURPOSE OF CONSTRUCTION AND MUST ON NO ACCOUNT BE USED AS SUCH.

drawing notes

Refer to Elevation drawings

CDMC Notes (Refer to Architects's RML)

- Falls through new unprotected holes in the floor slabs
- Injuries to University Staff while works are carried out in an occupied building.
- Possible asbestos containing materials in voids not yet inspected.
- Window cleaning
- Oversized/ large materials

Note.

EXACT SCOPE OF WINDOWS TO BE CONFIRMED AS PART OF VALUE ENGINEERING

revisions

P1	14.11.14	Planning Issue
T1	18.11.14	Issued for Planning and Listed Building Application
T2	01.12.14	Issued for costing
T3	17.12.14	Stage E Tender Issue
T4	20.01.16	Revised for 2016 Proposals Section 3 Detail 7 amended
T5	13.04.16	Revised Planning and Listed Building Application
T5	14.04.16	EMPLOYERS REQUIREMENTS AMENDMENT ISSUE

date
Nov' 2014

scale
Various

drawn
JC

File.location

client
UCL

drawing
Proposed Window Refurbishment Details

drawing number
3008 A1000

rev
T5

Levitt Bernstein

1 Kingstand Passage
London E8 2BB
t: 020 7275 7676
f: 020 7275 9348
w: levittbernstein.co.uk
e: post@levittbernstein.co.uk

desM
Architects

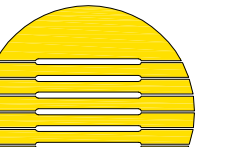

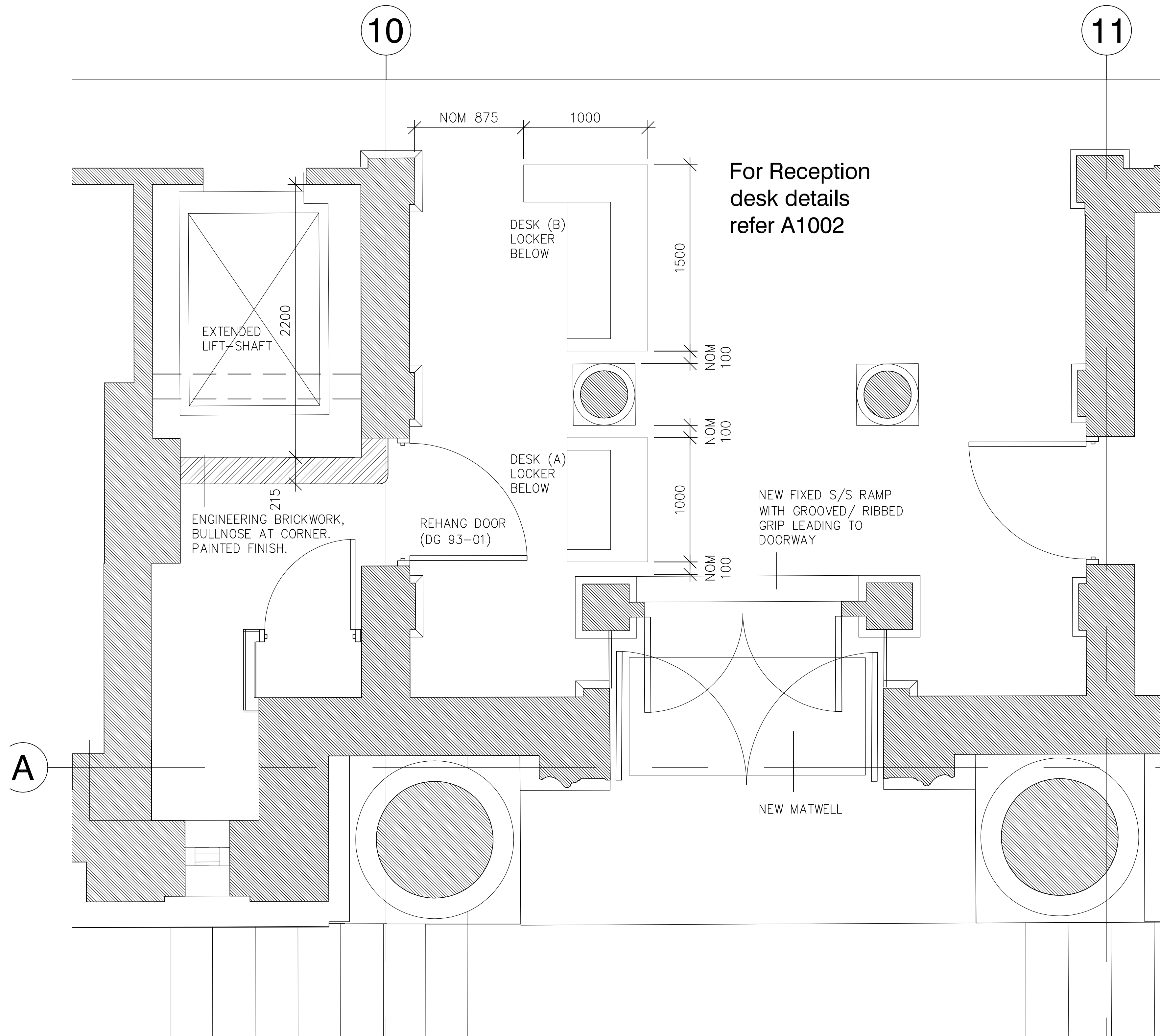

1 Ground Floor Reception Plan and Lift works
A1001 SCALE 1:20@A1

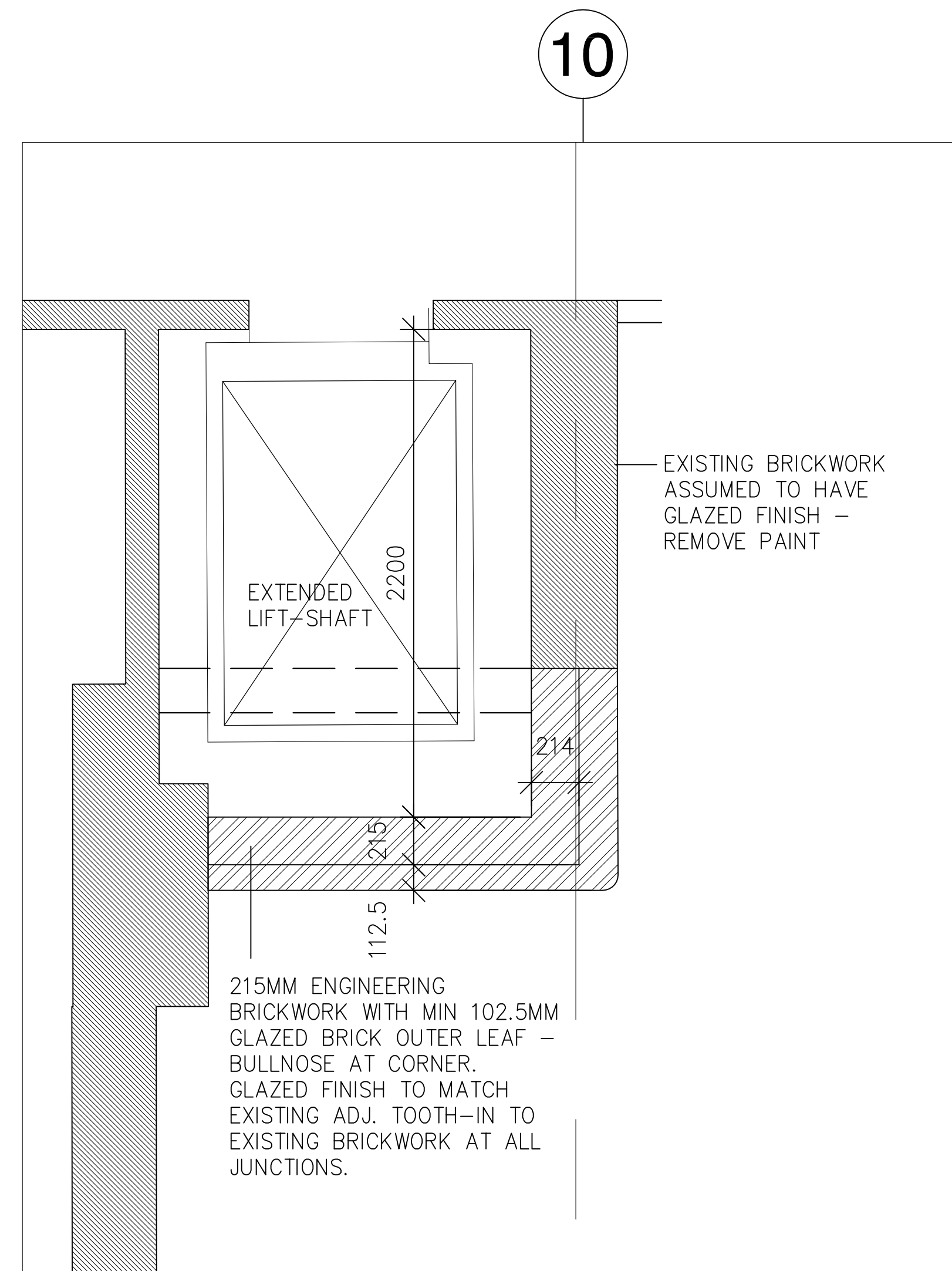

2 First Floor Lift works
A1001 SCALE 1:20@A1

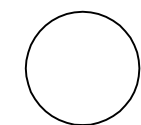

standard notes

1. Do not scale this drawing.
2. All dimensions must be checked on site and any discrepancies verified with the architect.
3. Unless shown otherwise, all dimensions are to structural surfaces.

THIS IS NOT A CONSTRUCTION DRAWING, IT IS UNSUITABLE FOR THE PURPOSE OF CONSTRUCTION AND MUST ON NO ACCOUNT BE USED AS SUCH.

drawing notes

CDMC Notes (Refer to Architects's RML)

- Falls through new unprotected holes in the floor slabs
- Injuries to University Staff while works are carried out in an occupied building.
- Possible asbestos containing materials in voids not yet inspected.
- Window cleaning
- Oversized/ large materials

PLANNING AND LISTED BUILDING APPLICATION

FOR FURTHER INFORMATION WITH REGARDS TO PREVIOUSLY ASSOCIATED APPLICATIONS IN RELATION TO THE PROPOSED REFURBISHMENT WORKS AT THE KATHLEEN LONSDALE BUILDING, PLEASE REFER TO THE FOLLOWING

KATHLEEN LONSDALE APPLICATION (APPROVED Jan 2015) - REF. 2014/7220/P & 2014/7310/L
GMP APPLICATION (APPROVED Oct 2015) - REF. 2014/4924/L & 2015/4345/P
GOWER COURT ELEVATION (APPROVED Oct 2015) - REF. 2015/4893/L & 2015/4346/P

revisions

P1	14.11.14	Planning Issue
T1	18.11.14	Issued for Planning and Listed Building Application
T2	01.12.14	Issued for costing
T3	17.12.14	Stage E Tender Issue
T4	13.04.16	Revised Planning and Listed Building Application
T4	14.04.16	EMPLOYERS REQUIREMENTS AMENDMENT ISSUE

KLB Refurbishment UCL

Gower Place, London

date
Nov' 2014

client
UCL

scale
Various

drawing
Proposed Reception Plan and Lift Works

drawn
JC

checked
TG

drawing number
3008 A1001

rev
T4

File location

Levitt Bernstein

Levitt Bernstein
1 Kingsland Passage
London
E8 2BB
t: 020 7275 7676
f: 020 7275 9348
w: levittbernstein.co.uk
e: post@levittbernstein.co.uk

desM
Architects

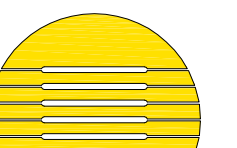

LEGEND

- ① LAMINATE FACED LOCKABLE CABINET WITH BAR TYPE STAINLESS PULL HANDLE
- ② PAINTED MDF LININGS TO LEG RECESS ZONE
- ③ LG HI MACS 13mm FACING OVER MDF SUBSTRATE
- ④ STAINLESS STEEL CABLE OUTLETS IN DESKTOP
- ⑤ STAINLESS STEEL KICK PLATES
- ⑥ STAINLESS STEEL FACED SOCKETS / DATA POINTS
- ⑦ FORBO DESKTOP LINO WITH WRAPPED BULLNOSE SOLID COLOUR

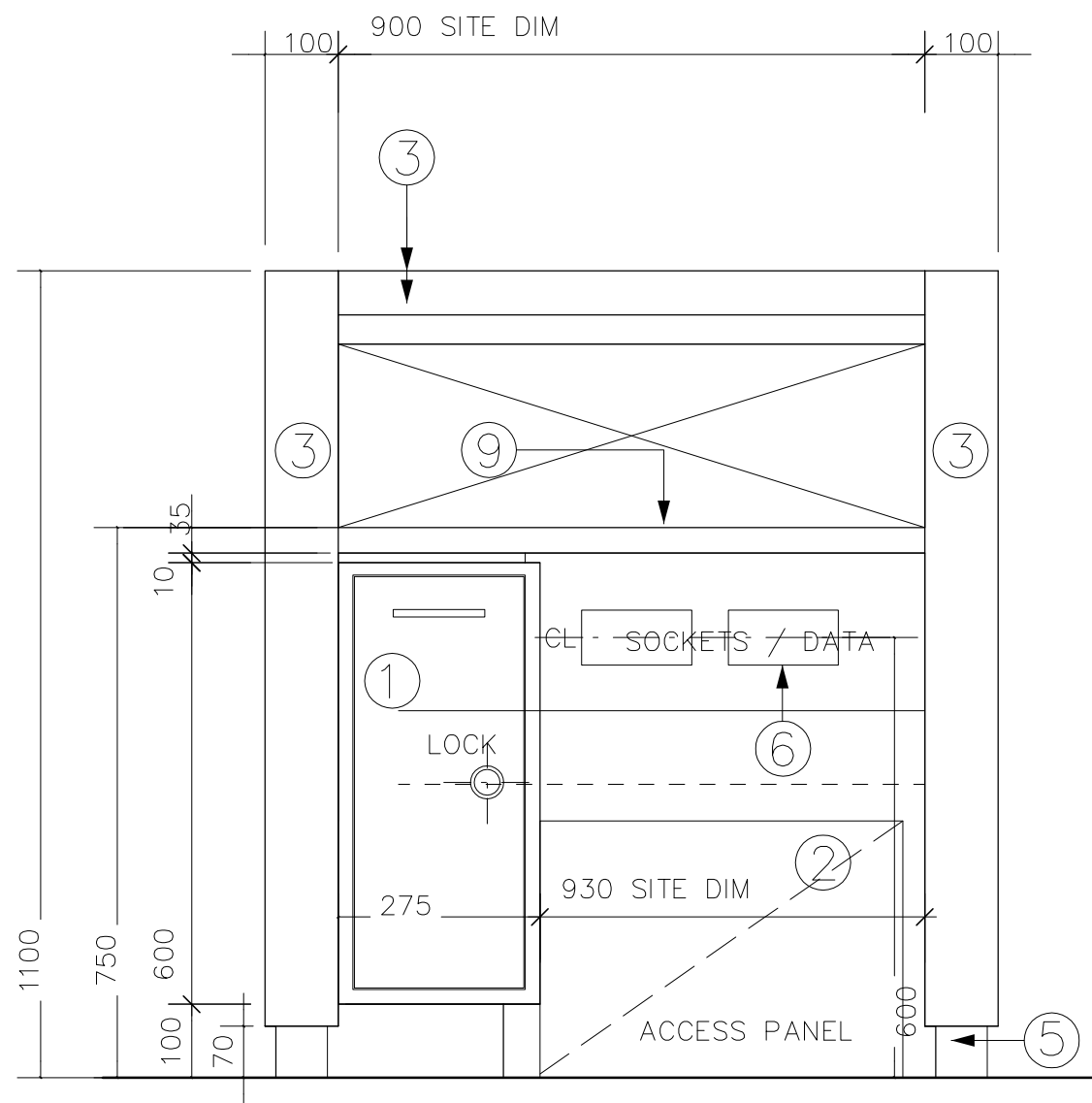

UNIT A: REAR ELEVATION
SCALE 1:20

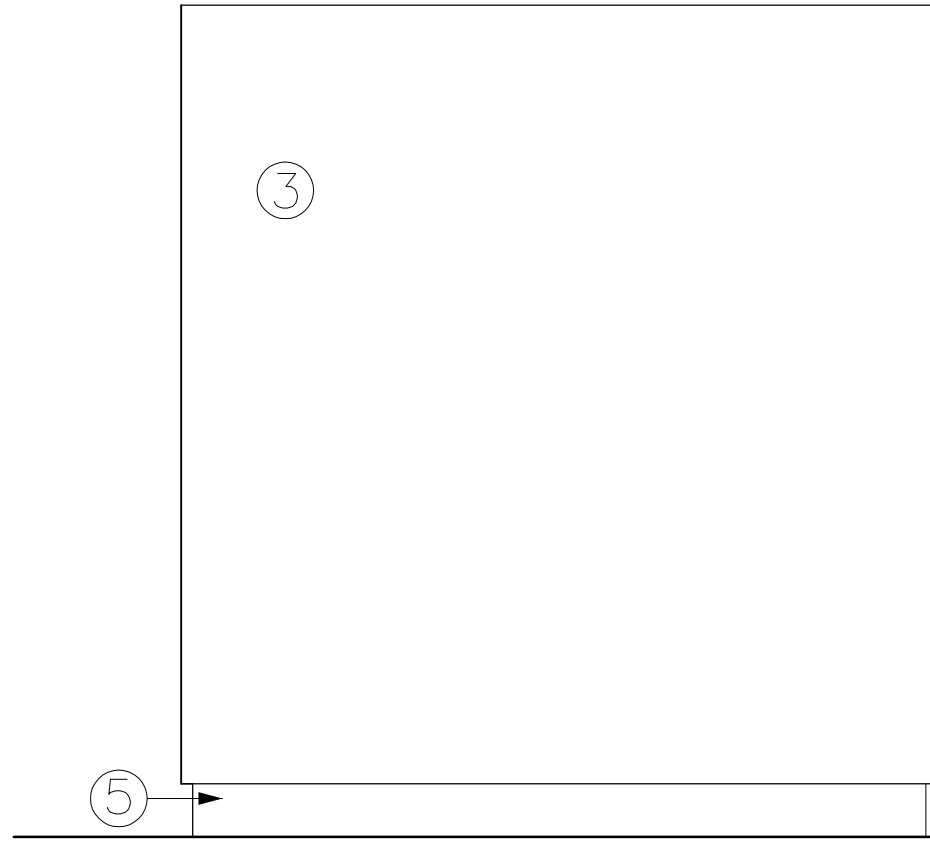

UNIT A: FRONT ELEVATION
SCALE 1:20

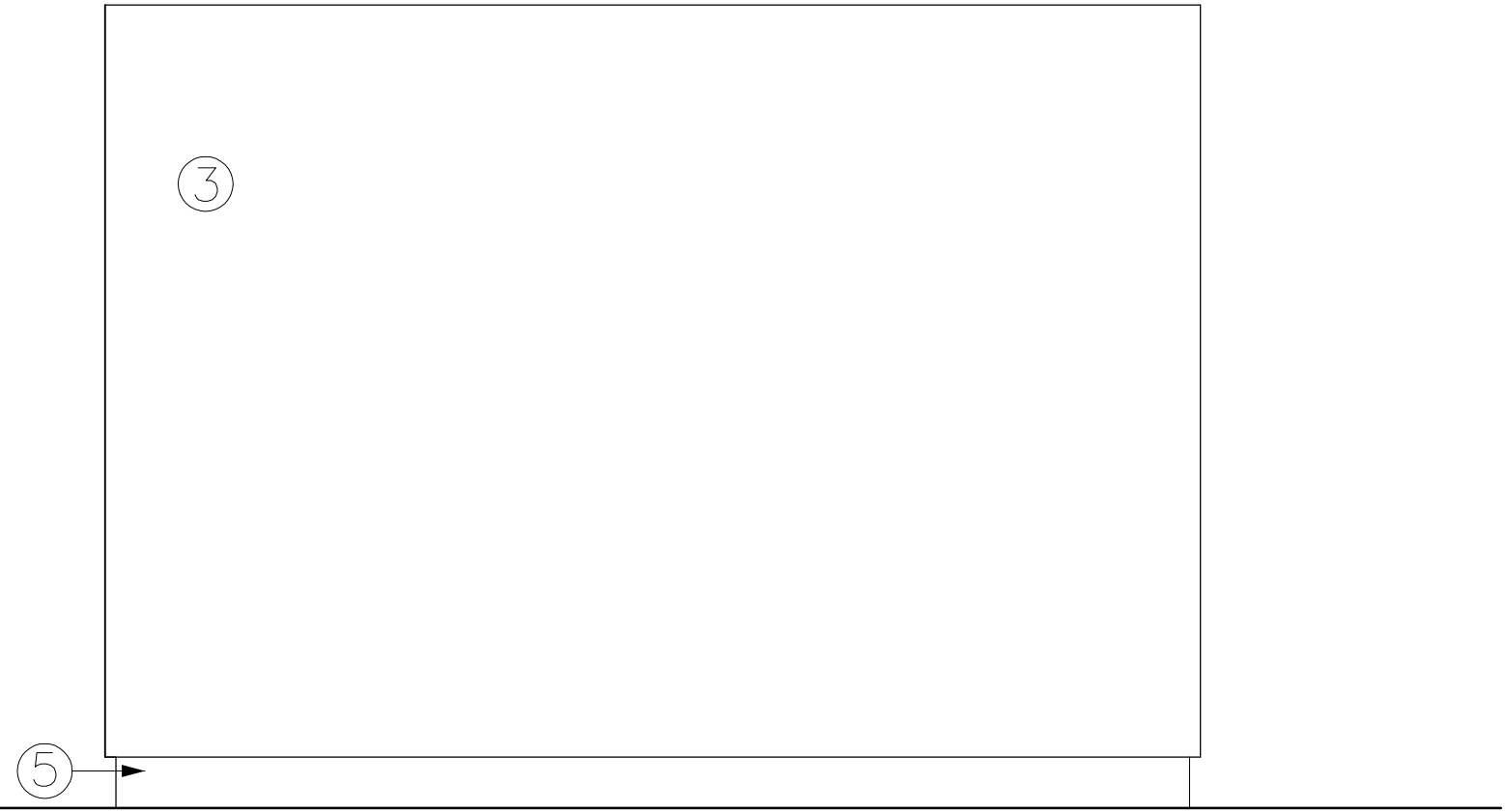

UNIT A: FRONT ELEVATION
SCALE 1:20

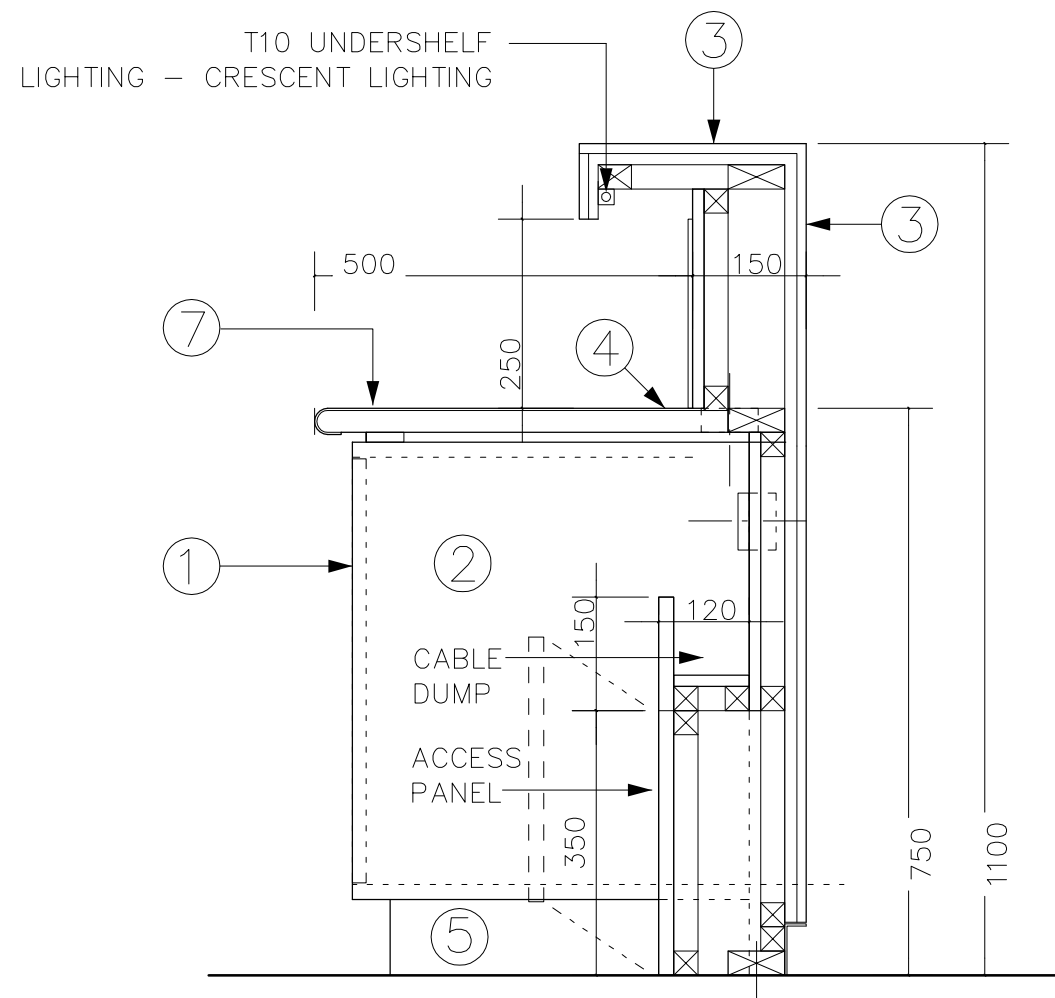

SECTION A - THROUGH COUNTER
SCALE 1:20

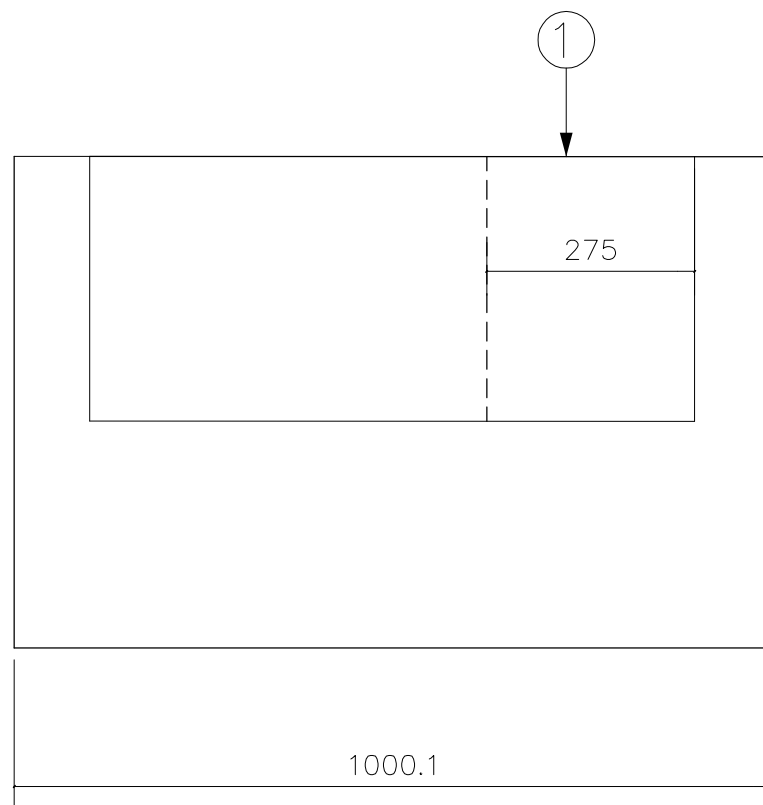

UNIT A: PLAN
SCALE 1:20

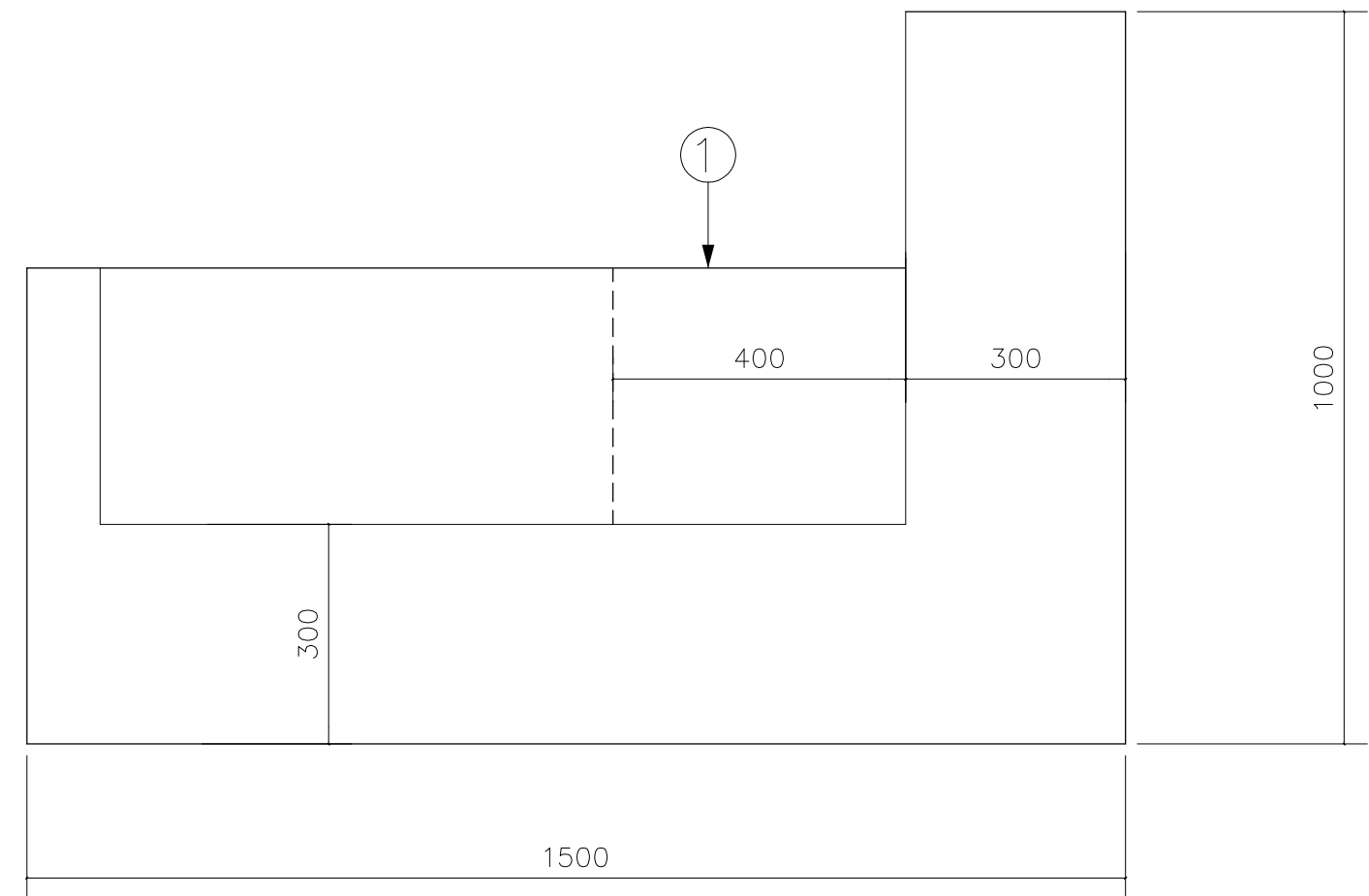

UNIT A: PLAN
SCALE 1:20

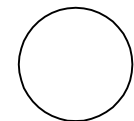

standard notes

- 1. Do not scale this drawing.
- 2. All dimensions must be checked on site and any discrepancies verified with the architect.
- 3. Unless shown otherwise, all dimensions are to structural surfaces.

THIS IS NOT A CONSTRUCTION DRAWING, IT IS UNSUITABLE FOR THE PURPOSE OF CONSTRUCTION AND MUST ON NO ACCOUNT BE USED AS SUCH.

drawing notes

CDMC Notes (Refer to Architects's RML)

- Falls through new unprotected holes in the floor slabs
- Injuries to University Staff while works are carried out in an occupied building.
- Possible asbestos containing materials in voids not yet inspected.
- Window cleaning
- Oversized/ large materials

revisions

P1	14.11.14	Planning Issue
T1	18.11.14	Issued for Planning and Listed Building Application
T2	01.12.14	Issued for costing
T3	17.12.14	Stage E Tender Issue
T4	13.04.16	Revised Planning and Listed Building Application
T4	14.04.16	EMPLOYERS REQUIREMENTS AMENDMENT ISSUE

PLANNING AND LISTED BUILDING APPLICATION

FOR FURTHER INFORMATION WITH REGARDS TO PREVIOUSLY ASSOCIATED APPLICATIONS IN RELATION TO THE PROPOSED REFURBISHMENT WORKS AT THE KATHLEEN LONSDALE BUILDING, PLEASE REFER TO THE FOLLOWING
KATHLEEN LONSDALE APPLICATION (APPROVED Jun 2010) - REF: 2014/7223/P & 2014/7310/L
GMP APPLICATION (APPROVED Oct 2015) - REF: 2014/4924/L & 2015/4348/P
GOWER COURT ELEVATION (APPROVED Oct 2015) - REF: 2015/4931/L & 2015/4348/P

KLB Refurbishment UCL

Gower Place, London

date
Nov' 2014

scale
Various

drawn
JC

File Location

client
UCL

drawing
Proposed Reception Desk Details

drawing number
3008 A1002

rev
T4

Levitt Bernstein

Levitt Bernstein
1 Kingsland Passage
London
E8 2BB
t: 020 7275 7676
f: 020 7275 9348
w: levittbernstein.co.uk
e: post@levittbernstein.co.uk

desM
Architects

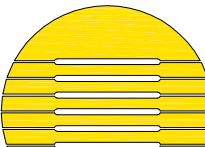

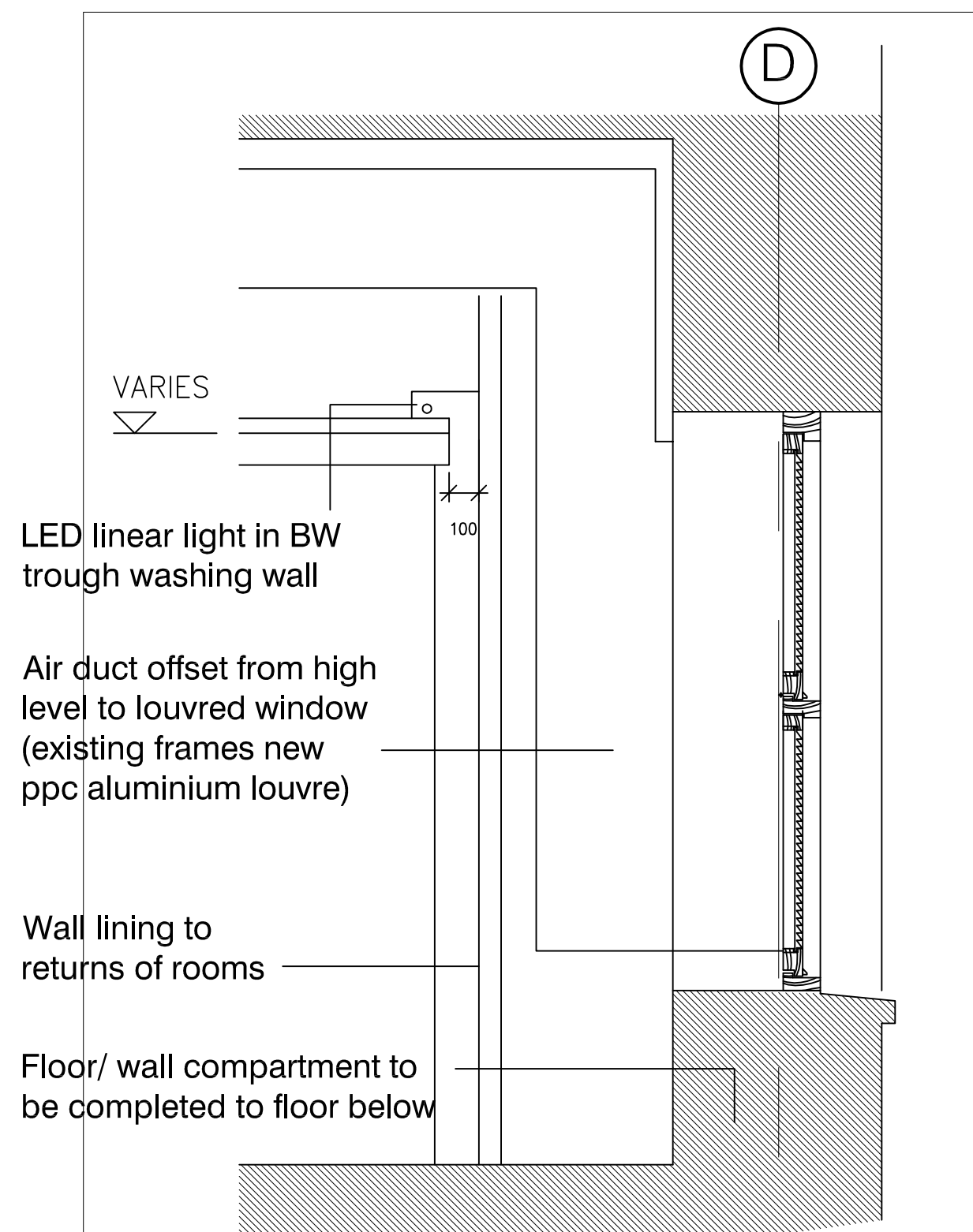

1 Section through Gower Ct Window
A1003 SCALE 1:20@A1

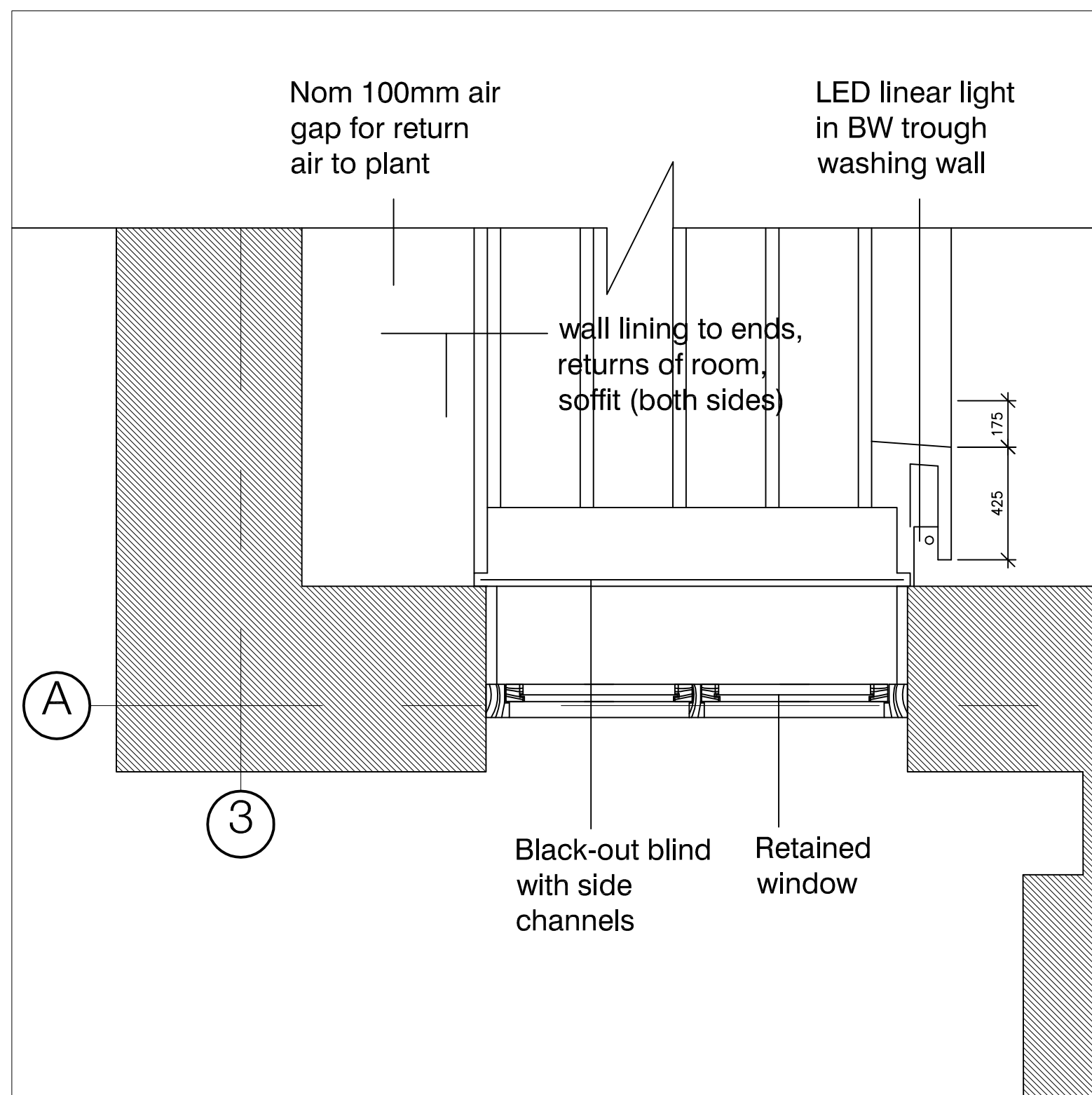

2 Part RCP at window Gower Place
A1003 SCALE 1:20@A1

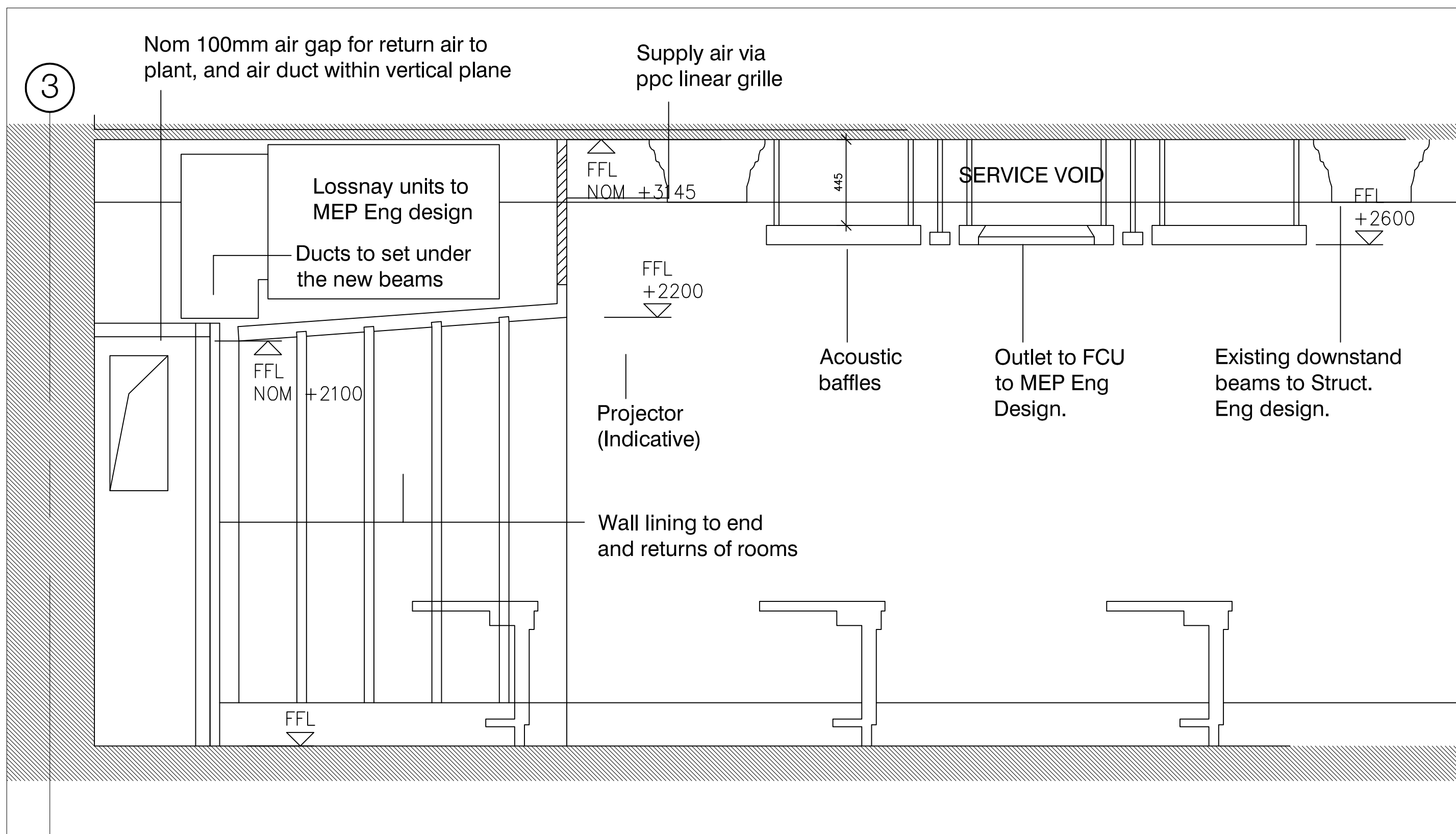

3 Section through Teaching Laboratory
A1003 SCALE 1:20@A1

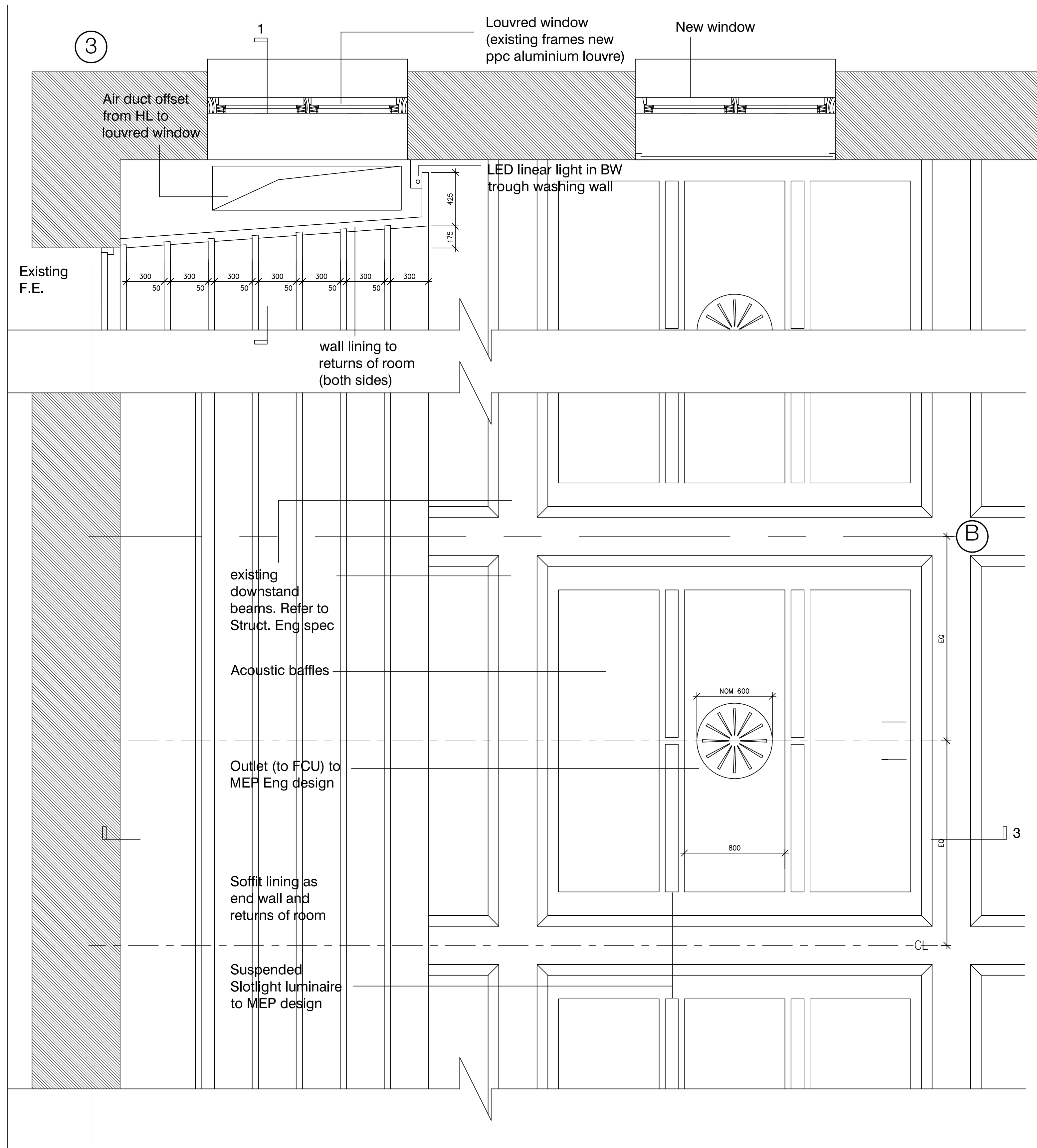

4 RCP of east end of Teaching Laboratory
A1003 SCALE 1:20@A1

PLANNING AND LISTED BUILDING APPLICATION
FOR FURTHER INFORMATION WITH REGARDS TO PREVIOUSLY ASSOCIATED APPLICATIONS IN RELATION TO THE PROPOSED REFURBISHMENT WORKS AT THE KATHLEEN LONSDALE BUILDING, PLEASE REFER TO THE FOLLOWING:
KATHLEEN LONSDALE APPLICATION (APPROVED Jan 2015) - REF: 2014/7223/P & 2014/7310/L
CMP APPLICATION (APPROVED Oct 2015) - REF: 2014/4024/L & 2015/4348/P
GOWER COURT ELEVATION (APPROVED Oct 2015) - REF: 2015/4601/L & 2015/4348/P

KLB Refurbishment UCL Gower Place, London

standard notes

1. Do not scale this drawing.
2. All dimensions must be checked on site and any discrepancies verified with the architect.
3. Unless shown otherwise, all dimensions are to structural surfaces.

THIS IS NOT A CONSTRUCTION DRAWING, IT IS UNSUITABLE FOR THE PURPOSE OF CONSTRUCTION AND MUST ON NO ACCOUNT BE USED AS SUCH.

drawing notes

CDMC Notes (Refer to Architects's RML)

- Falls through new unprotected holes in the floor slabs
- Injuries to University Staff while works are carried out in an occupied building.
- Possible asbestos containing materials in voids not yet inspected.
- Window cleaning
- Oversized/ large materials

revisions

P1	14.11.14	Planning Issue
T1	18.11.14	Issued for Planning and Listed Building Application
T2	01.12.14	Issued for costing
T3	17.12.14	Stage E Tender Issue
T4	20.01.16	Revised for Costing
T5	13.04.16	Revised Planning and Listed Building Application
T5	14.04.16	EMPLOYERS REQUIREMENTS AMENDMENT ISSUE

date
Nov 2014

scale
Various

drawn
JC

File:Location

client
UCL

drawing
Proposed Teaching Lab Details

checked
TG

drawing number
3008 A1003

rev
T5

rev
T5

Levitt Bernstein

Levitt Bernstein
1 Kingsland Passage
London
E8 2BB
t: 020 7275 7676
f: 020 7275 9348
w: levittbernstein.co.uk
e: post@levittbernstein.co.uk

desM
Architects

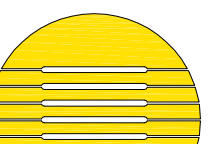

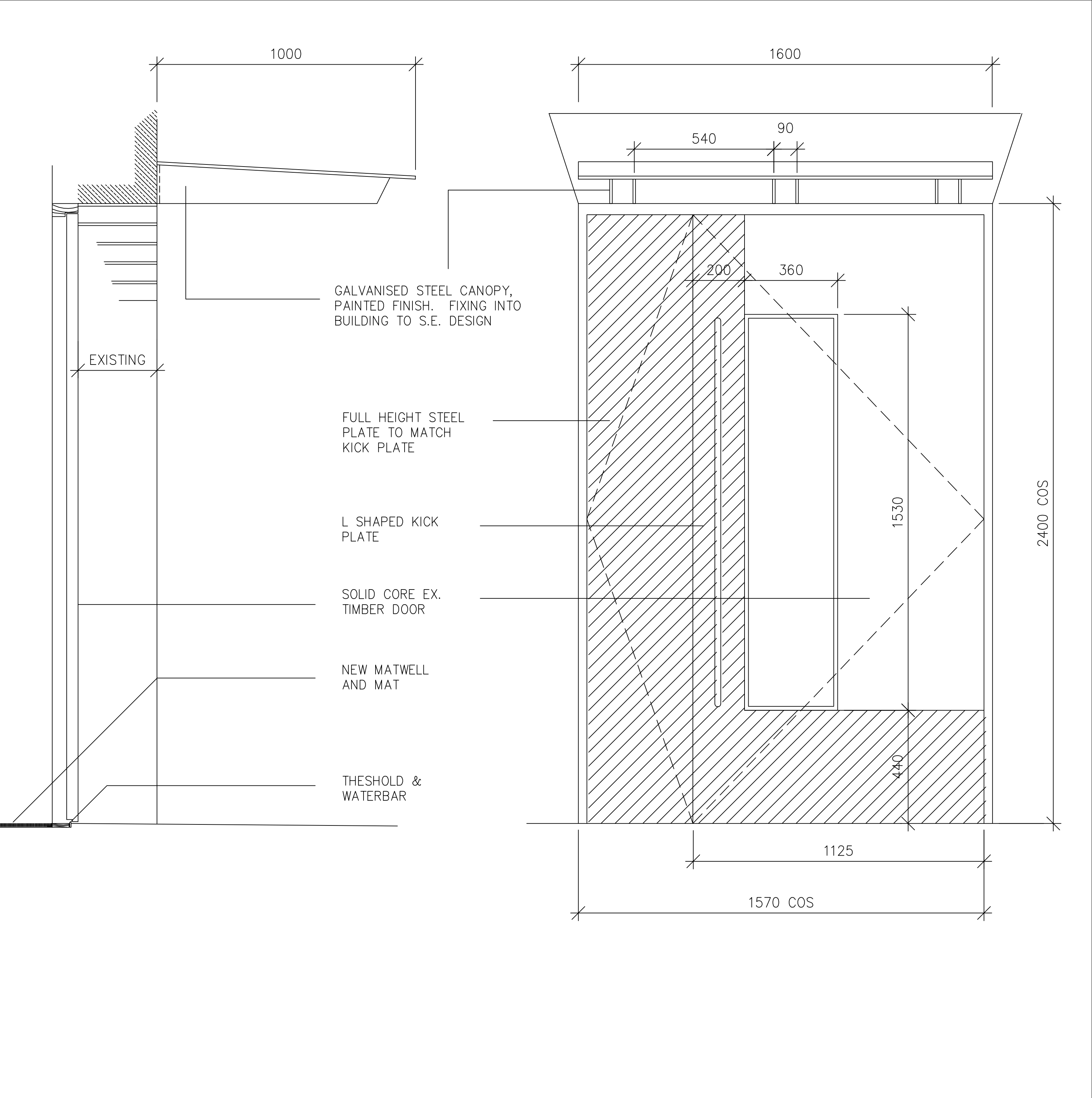

1 New external doors and canopy
A1004 SCALE 1:10@A1 (Also refer to External door type drawing)

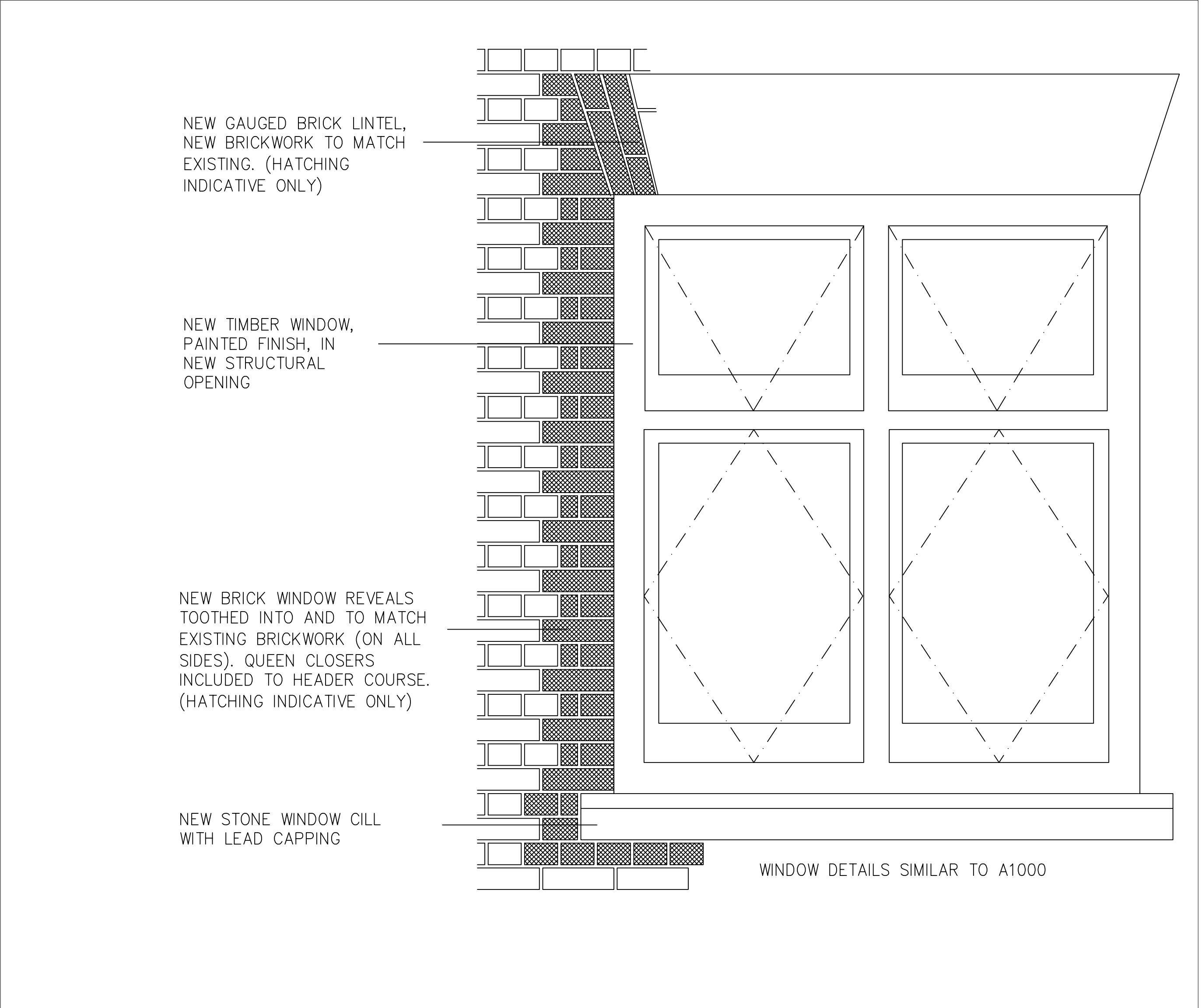

1 New windows
A1004 SCALE 1:10@A1

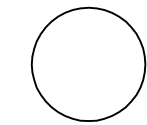

standard notes

1. Do not scale this drawing.
2. All dimensions must be checked on site and any discrepancies verified with the architect.
3. Unless shown otherwise, all dimensions are to structural surfaces.

THIS IS NOT A CONSTRUCTION DRAWING, IT IS UNSUITABLE FOR THE PURPOSE OF CONSTRUCTION AND MUST ON NO ACCOUNT BE USED AS SUCH.

drawing notes

- CDMC Notes (Refer to Architects's RML)
- Falls through new unprotected holes in the floor slabs
 - Injuries to University Staff while works are carried out in an occupied building.
 - Possible asbestos containing materials in voids not yet inspected.
 - Window cleaning
 - Oversized/ large materials

Note:
EXACT SCOPE OF WINDOWS TO BE CONFIRMED AS PART OF VALUE ENGINEERING

PLANNING AND LISTED BUILDING APPLICATION

FOR FURTHER INFORMATION WITH REGARDS TO PREVIOUSLY ASSOCIATED APPLICATIONS IN RELATION TO THE PROPOSED REFURBISHMENT WORKS AT THE KATHLEEN LONSDALE BUILDING, PLEASE REFER TO THE FOLLOWING

KATHLEEN LONSDALE APPLICATION (APPROVED Jan 2015) - REF. 2014/7223/P & 2014/7310/L
GMP APPLICATION (APPROVED Oct 2015) - REF. 2014/4924/L & 2015/4348/P
GOWER COURT ELEVATION (APPROVED Oct 2015) - REF. 2015/4931/L & 2015/4348/P

revisions

T1	18.11.14	Issued for Planning and Listed Building Application
T2	01.12.14	Issued for costing
T3	17.12.14	Stage E Tender Issue
T4	13.04.16	Revised Planning and Listed Building Application
T4	14.04.16	EMPLOYERS REQUIREMENTS AMENDMENT ISSUE

KLB Refurbishment UCL

Gower Place, London

date
Nov' 2014

scale
Various

drawn
TG

File:Location

client
UCL

drawing
Proposed Ext Door & Window Details

drawing number
3008 A1006

rev
T4

Levitt Bernstein

Levitt Bernstein
1 Kingsland Passage
London
E8 2BB
t: 020 7275 7676
f: 020 7275 9348
w: levittbernstein.co.uk
e: post@levittbernstein.co.uk

desM
Architects

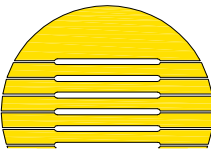

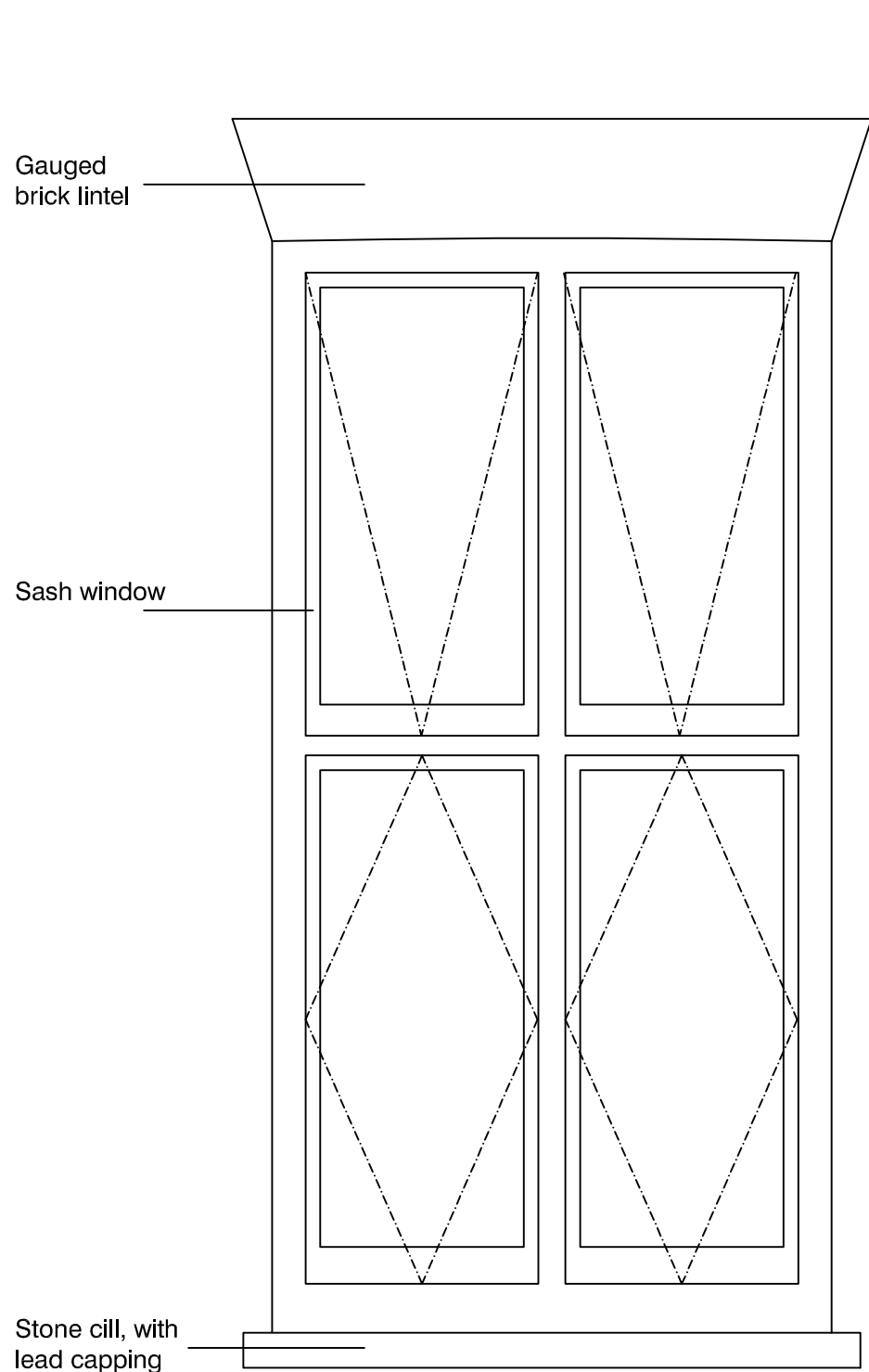

1

A1009

Gower Court West

Existing First Flr Plant Room Window Elevation

SCALE 1:20@A1

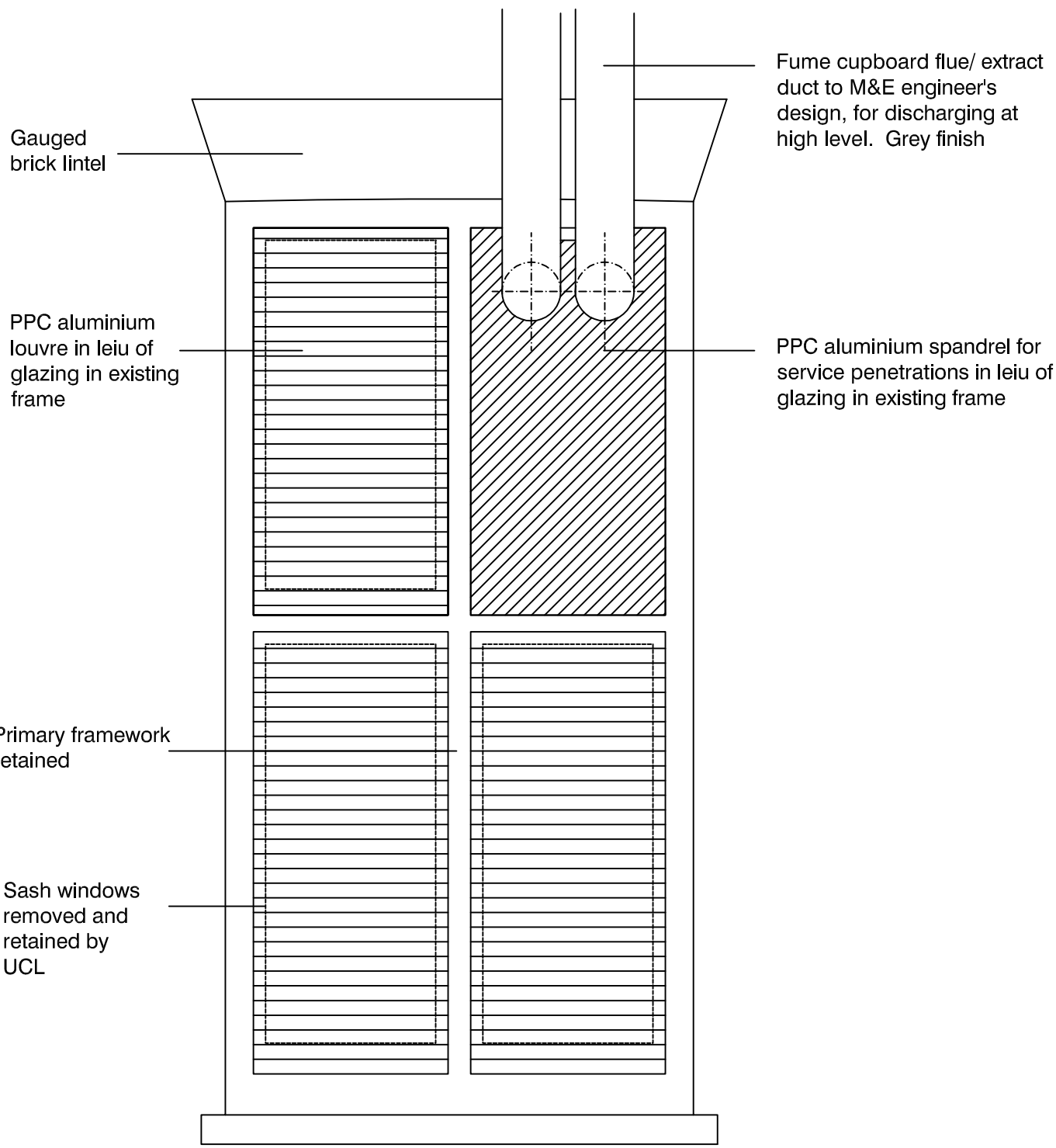

2

A1009

Gower Court West

Proposed First Flr Plant Room Window Elevation

SCALE 1:20@A1

Note
Sash windows which at to be removed are to be retained by UCL for future reuse / installtion

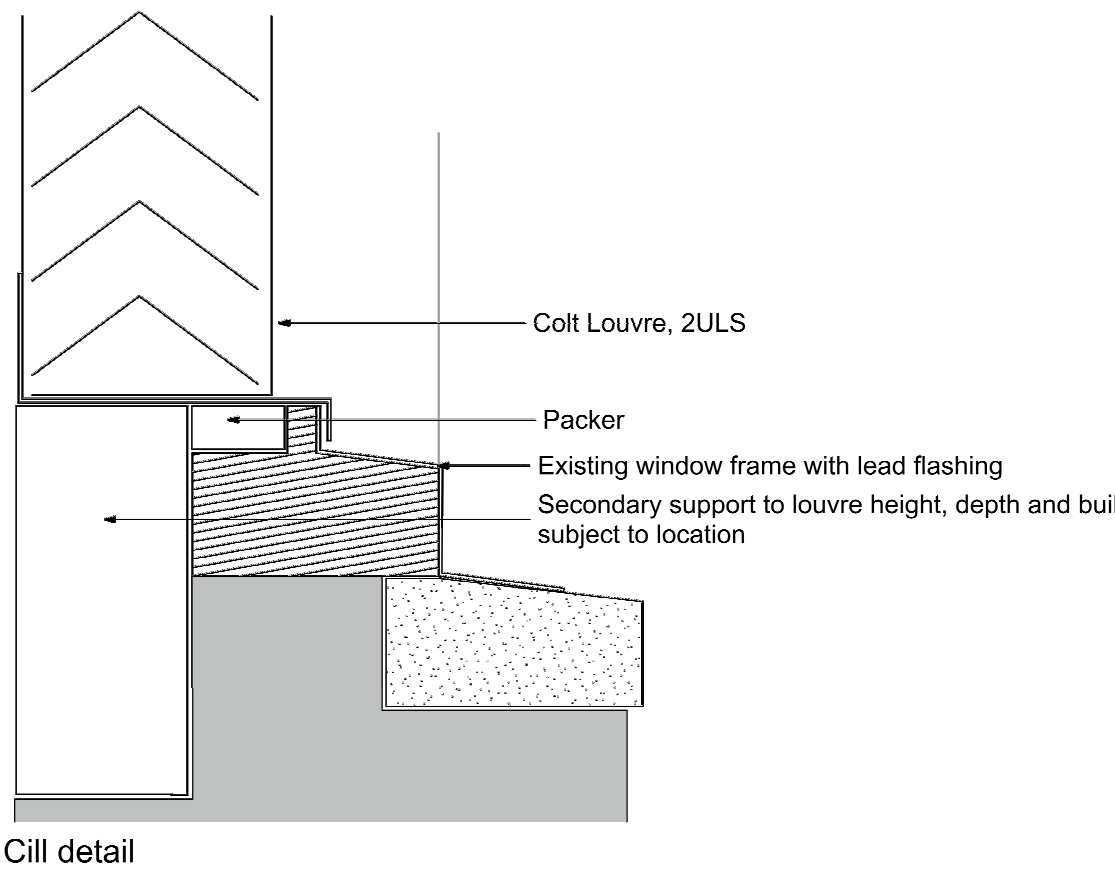

3

A1009

Gower Court West First Flr Plant Room Window

Exisitng Framework & Louvre Junction Detail (Contractor Proposal)

SCALE 1:10@A1

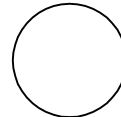
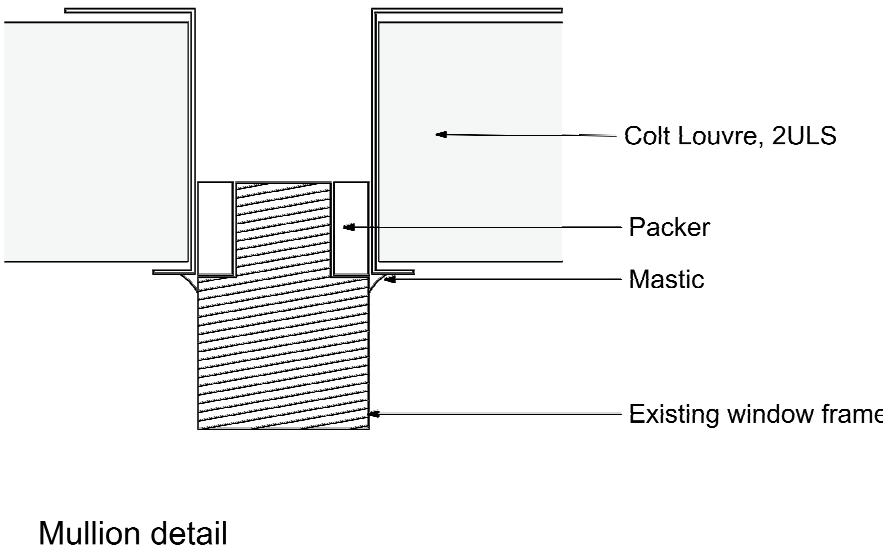

standard notes

1. Do not scale this drawing.
2. All dimensions must be checked on site and any discrepancies verified with the architect.
3. Unless shown otherwise, all dimensions are to structural surfaces.

THIS IS NOT A CONSTRUCTION DRAWING, IT IS UNSUITABLE FOR THE PURPOSE OF CONSTRUCTION AND MUST ON NO ACCOUNT BE USED AS SUCH.

drawing notes

Refer to Elevation drawings

CDMC Notes (Refer to Architects's RML)

- Falls through new unprotected holes in the floor slabs
- Injuries to University Staff while works are carried out in an occupied building.
- Possible asbestos containing materials in voids not yet inspected.
- Window cleaning
- Oversized/ large materials

Note.

EXACT SCOPE OF WINDOWS TO BE CONFIRMED AS PART OF VALUE ENGINEERING

PLANNING AND LISTED BUILDING APPLICATION

FOR FURTHER INFORMATION WITH REGARDS TO PREVIOUSLY ASSOCIATED APPLICATIONS IN RELATION TO THE PROPOSED REFURBISHMENT WORKS AT THE KATHLEEN LONSDALE BUILDING, PLEASE REFER TO THE FOLLOWING

KATHLEEN LONSDALE APPLICATION (APPROVED Jan 2015) - REF. 2014/72203/P & 2014/7310/L
GMP APPLICATION (APPROVED Oct 2015) - REF. 2014/44924/L & 2015/4349/P
GOWER COURT ELEVATION (APPROVED Oct 2015) - REF. 2015/44931/L & 2015/4349/P

revisions

T1	13.04.16	Revised Planning and Listed Building Application
T1	14.04.16	EMPLOYERS REQUIREMENTS AMENDMENT ISSUE
T2	15.04.16	Revised Planning and Listed Building Application

KLB Refurbishment UCL

Gower Place, London

date
Nov' 2014

client
UCL

scale
Various

drawing
Gower Court Plant Room Window Refurb

drawn
JC

checked
TG

drawing number
3008 A1009

rev
T2

File:Location

Levitt Bernstein

Levitt Bernstein
1 Kingsland Passage
London
E8 2BB
t: 020 7275 7676
f: 020 7275 9348
w: levittbernstein.co.uk
e: post@levittbernstein.co.uk

desM
Architects

