

Revisions	
ISSUED FOR CONSTRUCTION	A
YK	28.04.15
ISSUED FOR CONSTRUCTION	Checked CD
Date 28.04.15	
TREE DETAILS ADDED FOR PLANNING	B
CD	12.06.15
PLINTH DETAILS ADDED FOR PLANNING & BLOCK PAVING EXTENDED UP RAMP	C
CD	19.04.16

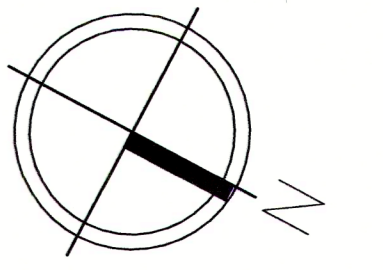

MEDIUM ETCH WET CAST PORTLAND STONE PLINTH (STONE TO MATCH OTHER STONE ELEMENTS) WITH ORIGINAL EXISTING BOUNDARY ORNAMENTAL RAILING REINSTATED AT OP

Note
Do not scale from this drawing.
All dimensions to be checked on site.
Report any discrepancies to the Architect.

2684 L100 C

THE CAVENDISH SCHOOL
NEW HALL AND CLASSROOM BLOCK

GENERAL LANDSCAPING PLAN

Scale 1:50@A1	Checked
Date FEB 15	Drawn CD

BH & M
BARNSELY HEWETT & MALLINSON
CHARTERED ARCHITECTS
1 White Hart Lane, London SW13 0RA
Telephone: 0181 878 4667 Fax: 0181 878 8907
e-mail mail@bhmtltd.co.uk http://www.bhmtltd.co.uk

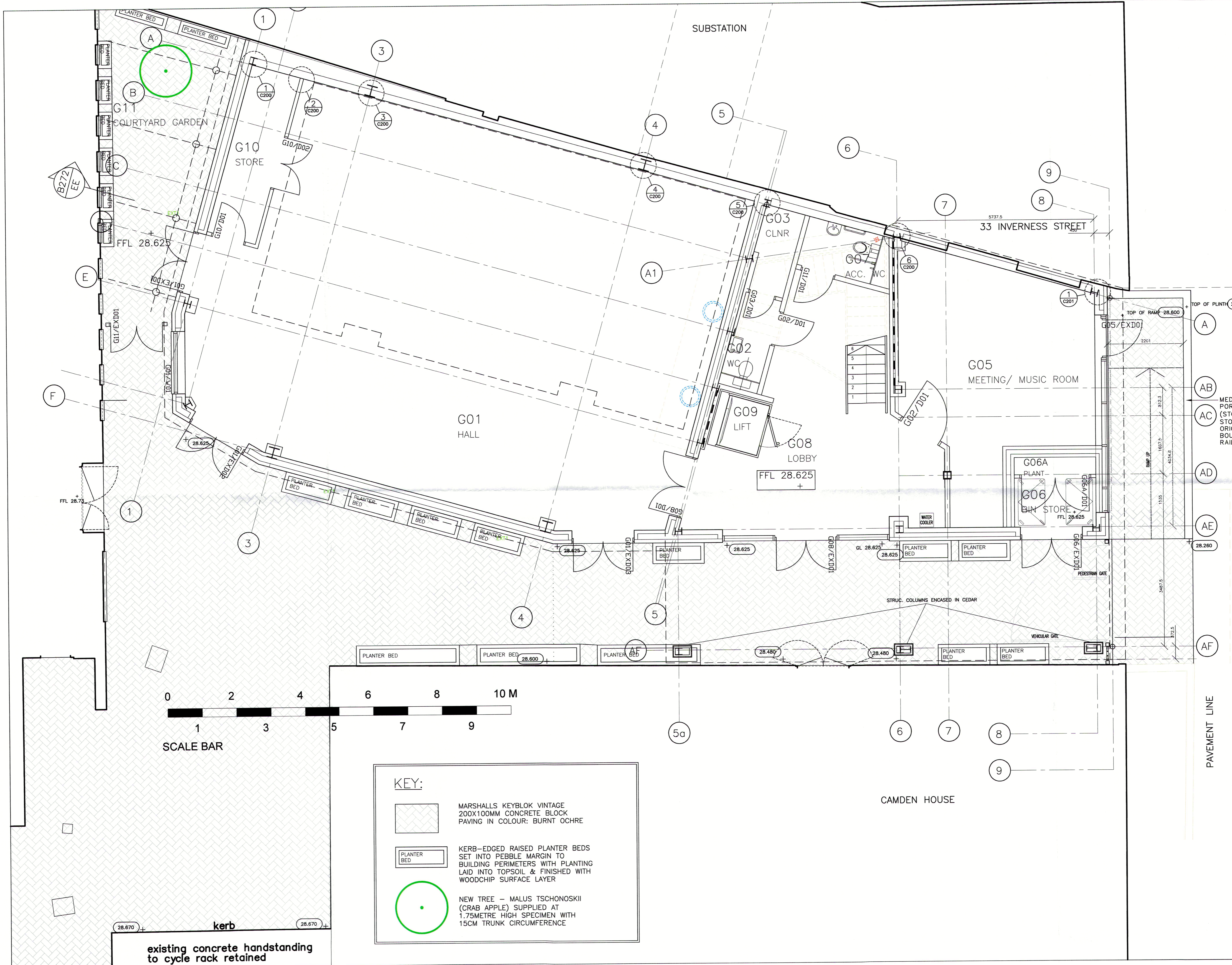

N:\2684\2684_L100.dwg, 28/04/2015 16:55:44, cd, \BHM\CD\PPD 4500_150 A1 (landscape), L11