

**General Notes**

1. All drawings remain the copyright of Tsolakis Architects, and cannot be reproduced without approval.
2. This Drawing must not be scaled.
3. Documents/drawings transferred by electronic mail are not to be altered without the consent of Tsolakis Architects.
4. Dimensional/level accuracy only applies to the written notation.
5. The drawings/information are to be cross referenced where necessary with other relevant Consultants information.
6. If in doubt ask.
7. All dimensions to be checked on site.
8. All omissions and discrepancies to be reported to the architect immediately



**Drawing Notes**

- Fire Rated Wall
- Proposed Brick Infill
- W4 Existing rendered wall to be repaired and painted colour to be approved by the architect

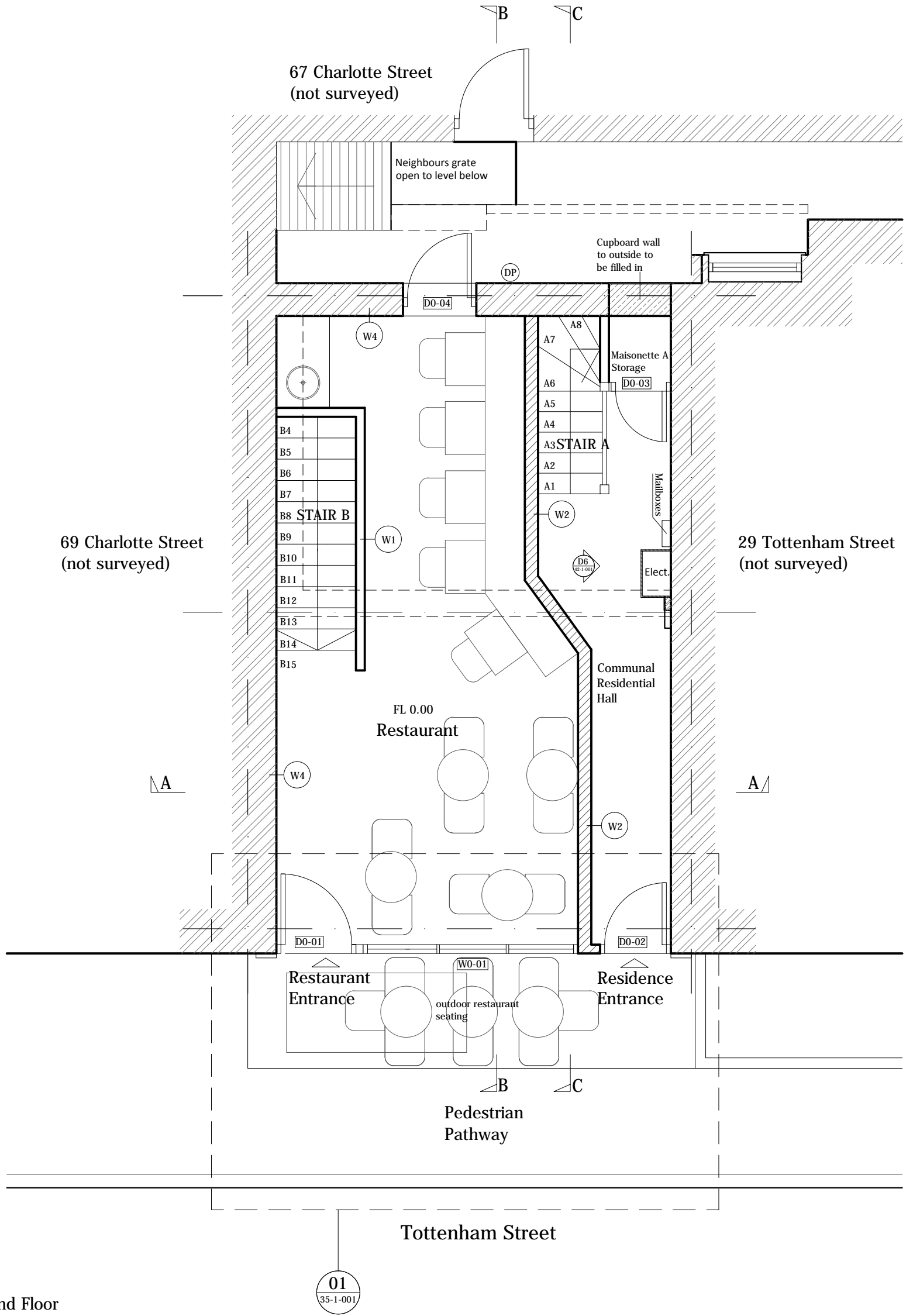

Existing Ground Floor

**Myria Constantinidou Architects**

8 Stasinou Avenue, Photiades Business Center  
3rd Floor Office 302, 1060 Nicosia, Cyprus

Tel. +357 22460505  
Mob. +357 99665656  
Fax. +357 22760706

email: myria@myria.com.cy  
website: www.myria.com.cy

Project  
27 Tottenham Street,  
London W1T 4RW



Client/ Organisation  
**Fastlane Productions Ltd**  
Project Number  
1137

Drawing Title  
Existing Ground Floor Plan  
Drawing Number  
**002**

Date  
May 2016  
Revision  
C

Scale  
1:50 @ A3  
Drawn by  
AT