



**ARTEMIS
TREE
SERVICES**

Tree Type & Number	Location	Work Required	Price/Time
		reason	
		reason	
		reason	
		reason	

Which Kit is required?

Notes To Team On Day Of Work:

14" Bar	<input checked="" type="checkbox"/>	Rayco Grinder 66cm	
16" or 18" Bar	<input checked="" type="checkbox"/>	Predator 82cm	
25" Bar	<input type="checkbox"/>	Wheel Barrow	
36" Bar	<input type="checkbox"/>	Sack Barrow	
48" Bar	<input type="checkbox"/>	Rigging Kit	
Small hedge trimmers	<input type="checkbox"/>	Dust sheets/Bags	
Medium Hedge trimmers	<input type="checkbox"/>	Stump Treatment	
Pole Trimmers	<input type="checkbox"/>	Chainsaw Attachment	
Brushcutter	<input type="checkbox"/>	Trimmer Attachment	
Access for Ranger 1.6m?	<input checked="" type="checkbox"/>	Access for 7.5t 2.15m?	
Access for 3.5t 1.90m?	<input checked="" type="checkbox"/>	Access for Grab 2.60m?	

MAP:

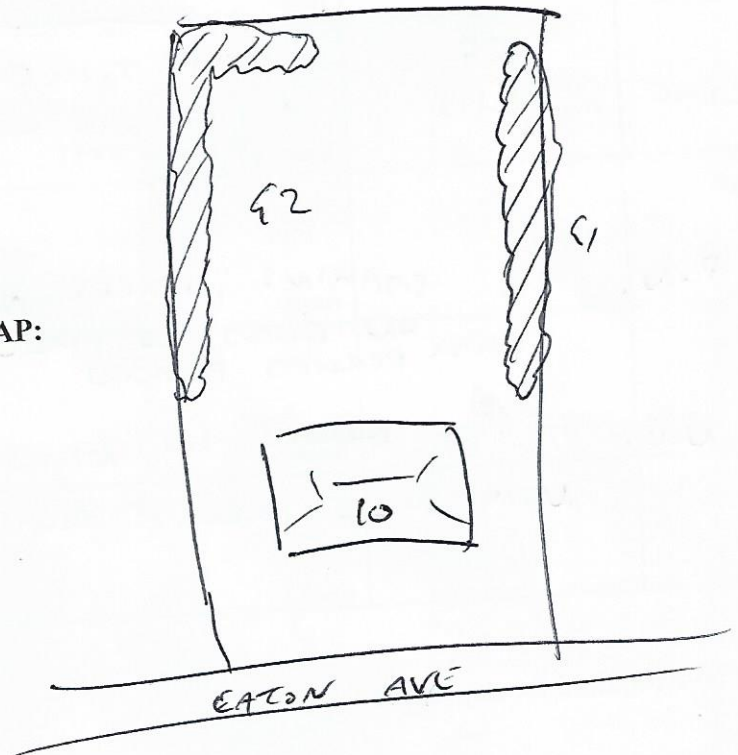

		Comments
TPO or CA?	Y	
OBSTACLES?	N	
Parking Restrictions?		
Did you take a photo of bays that need suspending?	Y	P.H.
How many loads? % of 3.5t		100%
REMOVE THETFORD?		

P.N. = Please Note: (note to client) N.B. = (note to Artemis office when booking in work)
Skill level (circle) 1 2 3 4 5

Total