

**ENABLING WORKS STRIP-OUT  
LEGEND NOTES**

**WALLS**

Remove section of wall.

**FLOORS/ LOW-LEVEL ELEMENTS**

Remove section of slab/ staircase/ roof etc.

All areas to be stripped of all ceiling, floor and wall finishes and made good to receive new.

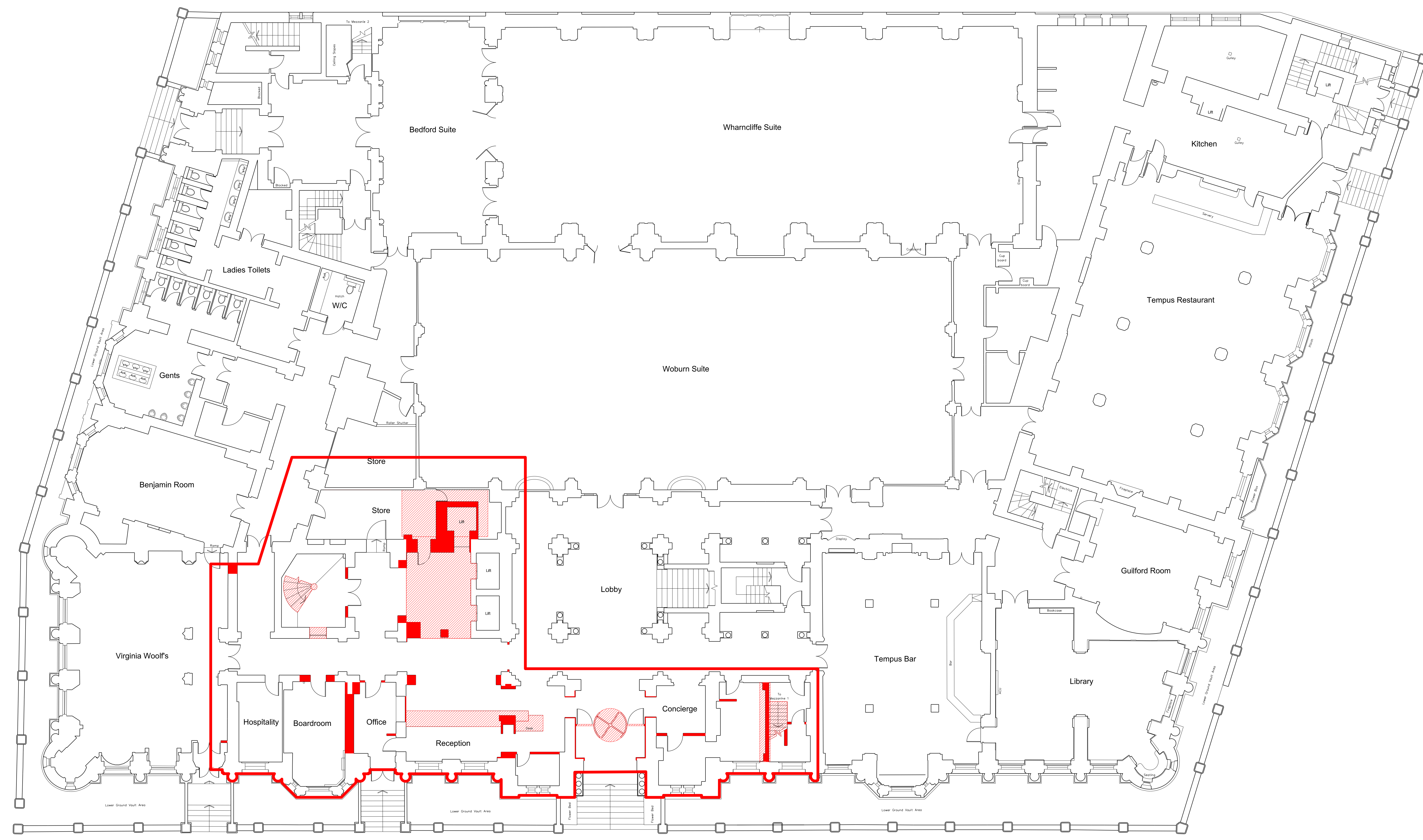

Keyplan	North	
<p>Notes:</p> <p>1. Do not scale</p> <p>2. Contractor to Check all dimensions and report omissions and errors to the Architect</p>		
		<p>09 Red line amended Issued for Planning 01.04.16 MG</p> <p>08 Red line amended Issued for Planning 23.03.16 IAG</p> <p>07 Revised &amp; Issued for Planning 14.03.16 MG</p> <p>06 Issued for Planning 11.03.16 MG</p> <p>05 REVISED &amp; ISSUED FOR PLANNING 01.10.15 MG</p> <p>04 REVISED &amp; ISSUED FOR PLANNING 19.08.15 MG</p> <p>03 REVISED &amp; ISSUED FOR PLANNING 11.08.15 TN</p> <p>02 REVISED &amp; ISSUED FOR PLANNING 09.03.15 MG</p> <p>01 ISSUED FOR PLANNING 03.03.15 MG TN</p> <p>No. Revision Date Initial Chkd</p>

— Extent of Planning Application

**EPR**  
architects

30 Millbank  
London SW1P 4DU  
+44 (0) 20 7932 7600  
www.epr.co.uk

Russell Hotel  
Bloomsbury

Ground Floor  
Strip-out Plan

PLANNING 1:100 @ A0 15.09.14

Project No	Type	Btg	Number	Zone/Lvl	Rev
10089 - T - 01 - 1401 - Z00					09