

DETAIL 1 - LINEAR CONCRETE SLABS OVER RC SLAB
SCALE 1:10

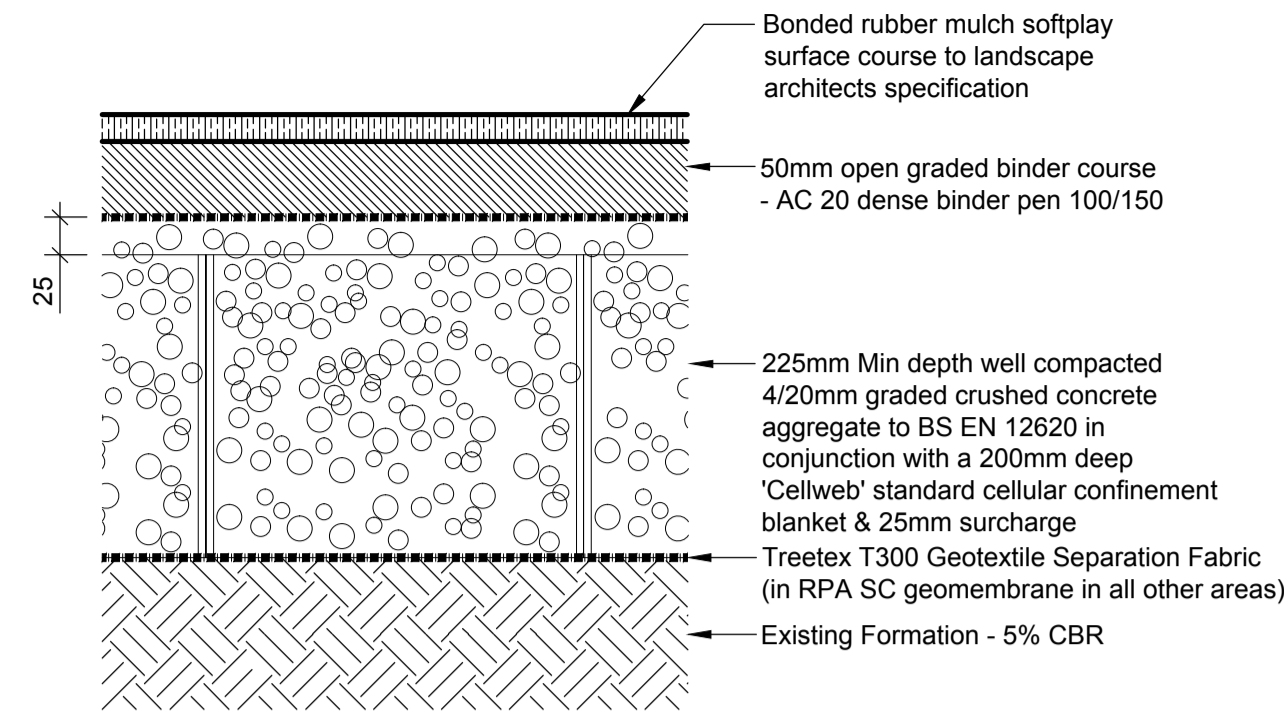

DETAIL 2 - BONDED RUBBER MULCH SOFTPLAY SURFACE (POROUS)

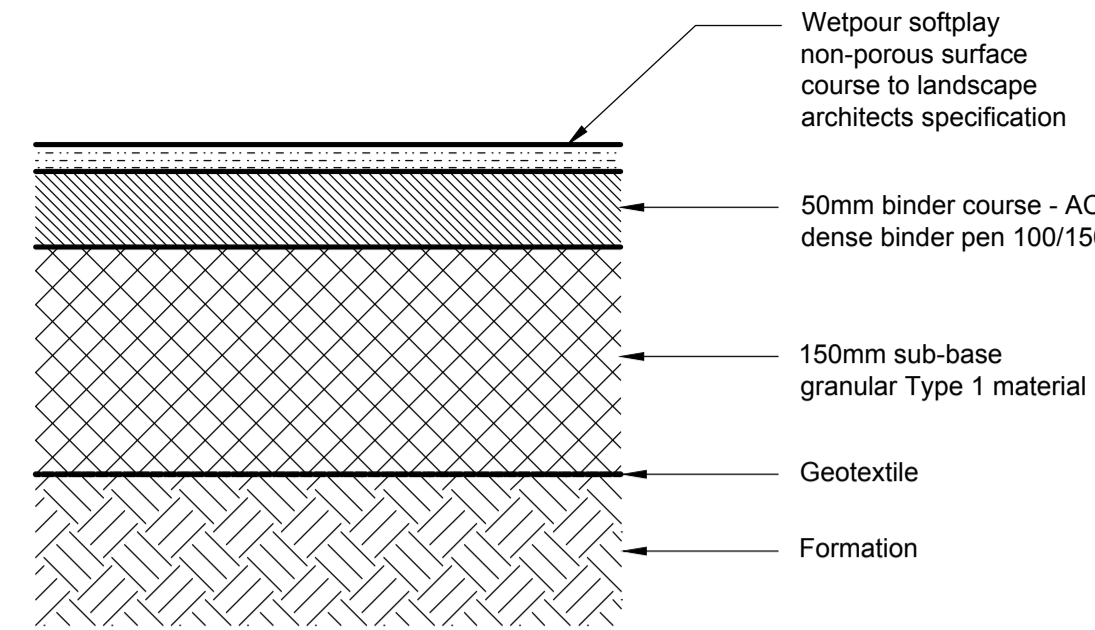

DETAIL 3 - WETPOUR SOFTPLAY SURFACE (NON-POROUS)

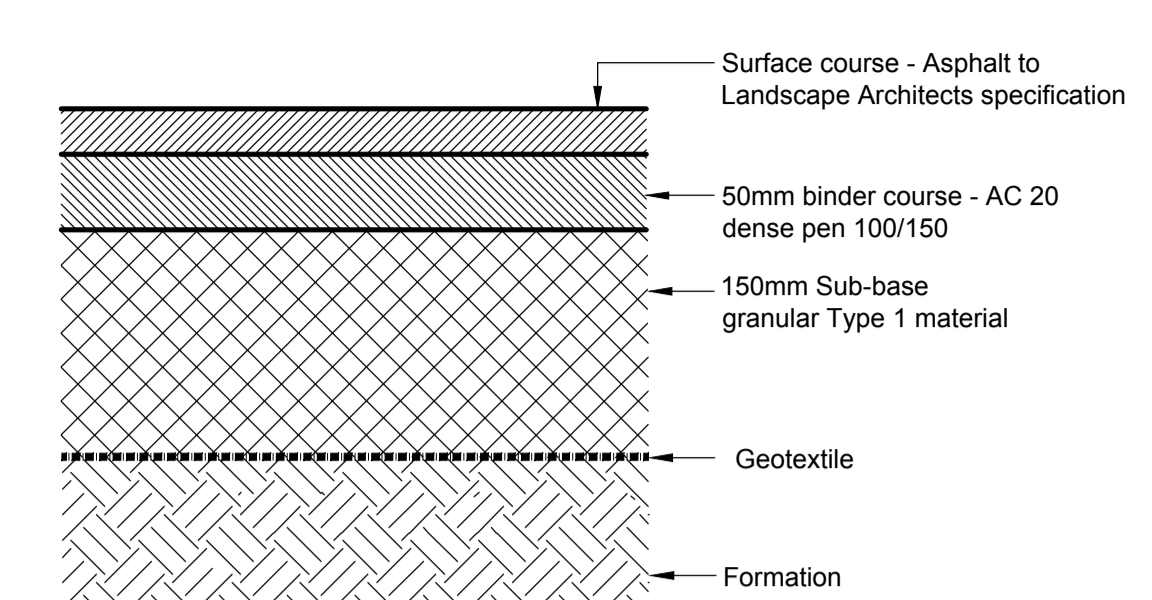

DETAIL 8 - ULTICOLOUR PEDESTRIAN TARMAC (NON POROUS)

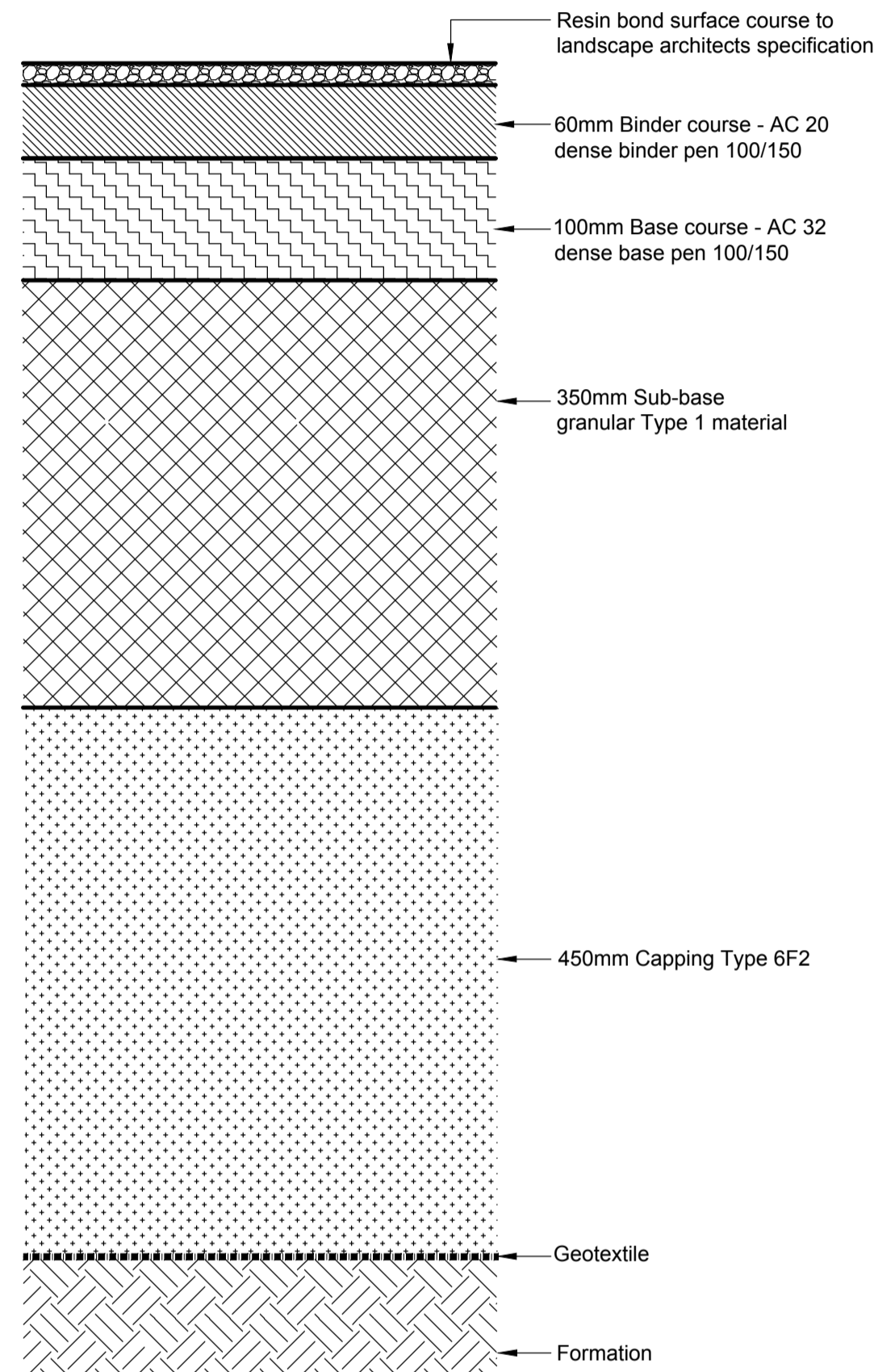

DETAIL 5 - RESIN-BONDED VEHICULAR SURFACE (NON-POROUS)

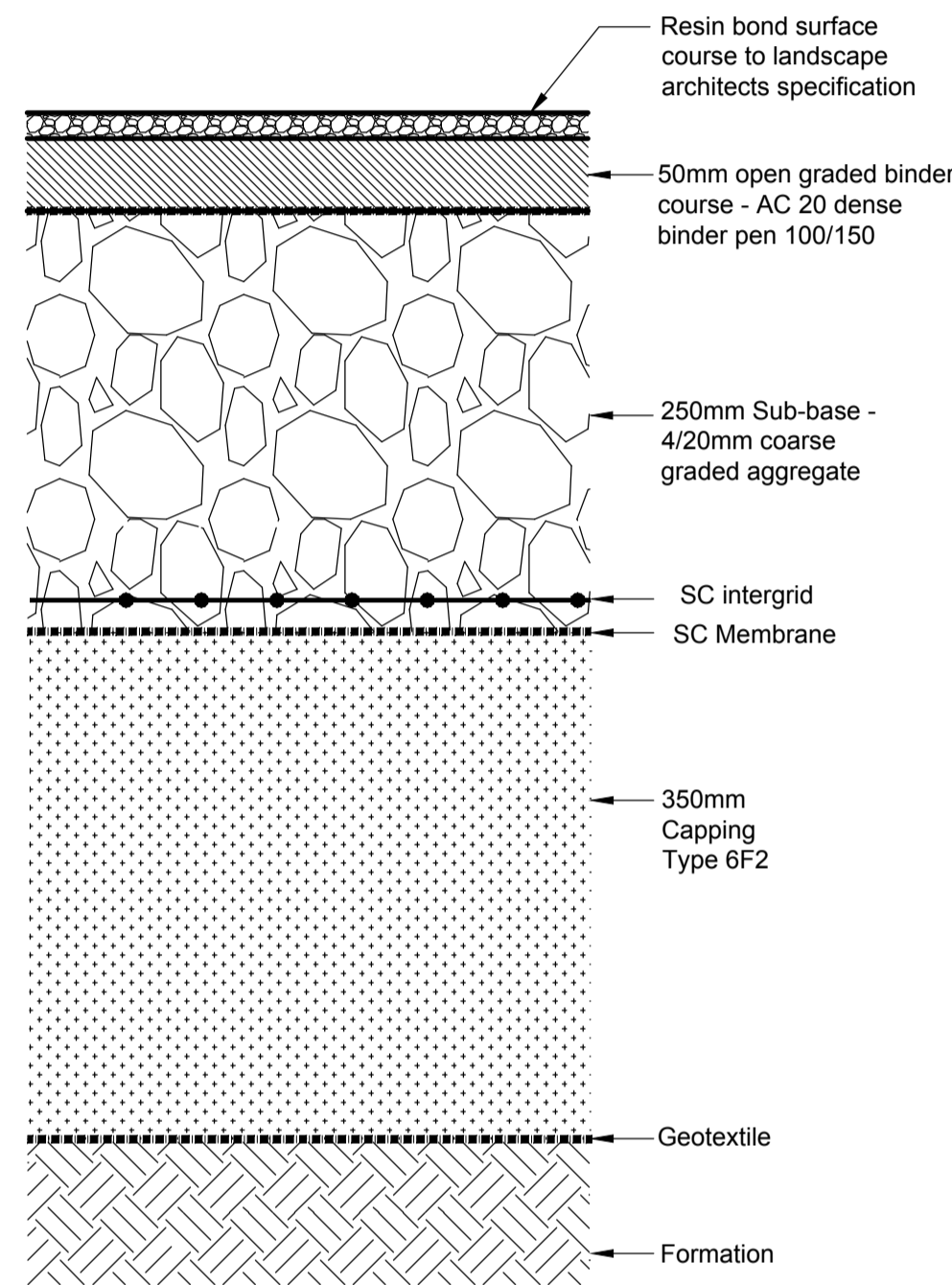

DETAIL 9 - RESIN-BOND PEDESTRIAN SURFACE (POROUS)

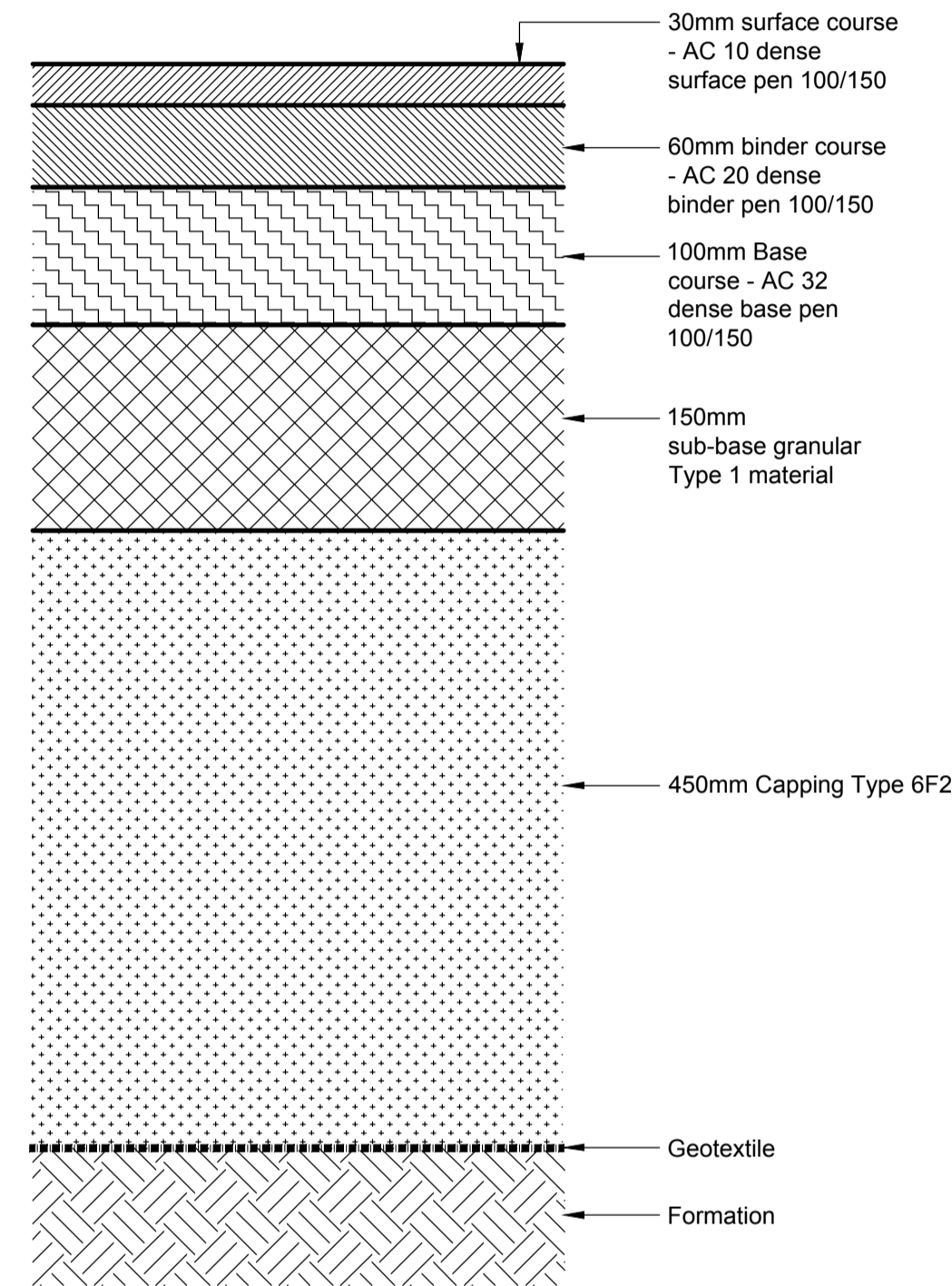

DETAIL 10 - ULTICOLOUR VEHICULAR TARMAC (NON-POUROUS)

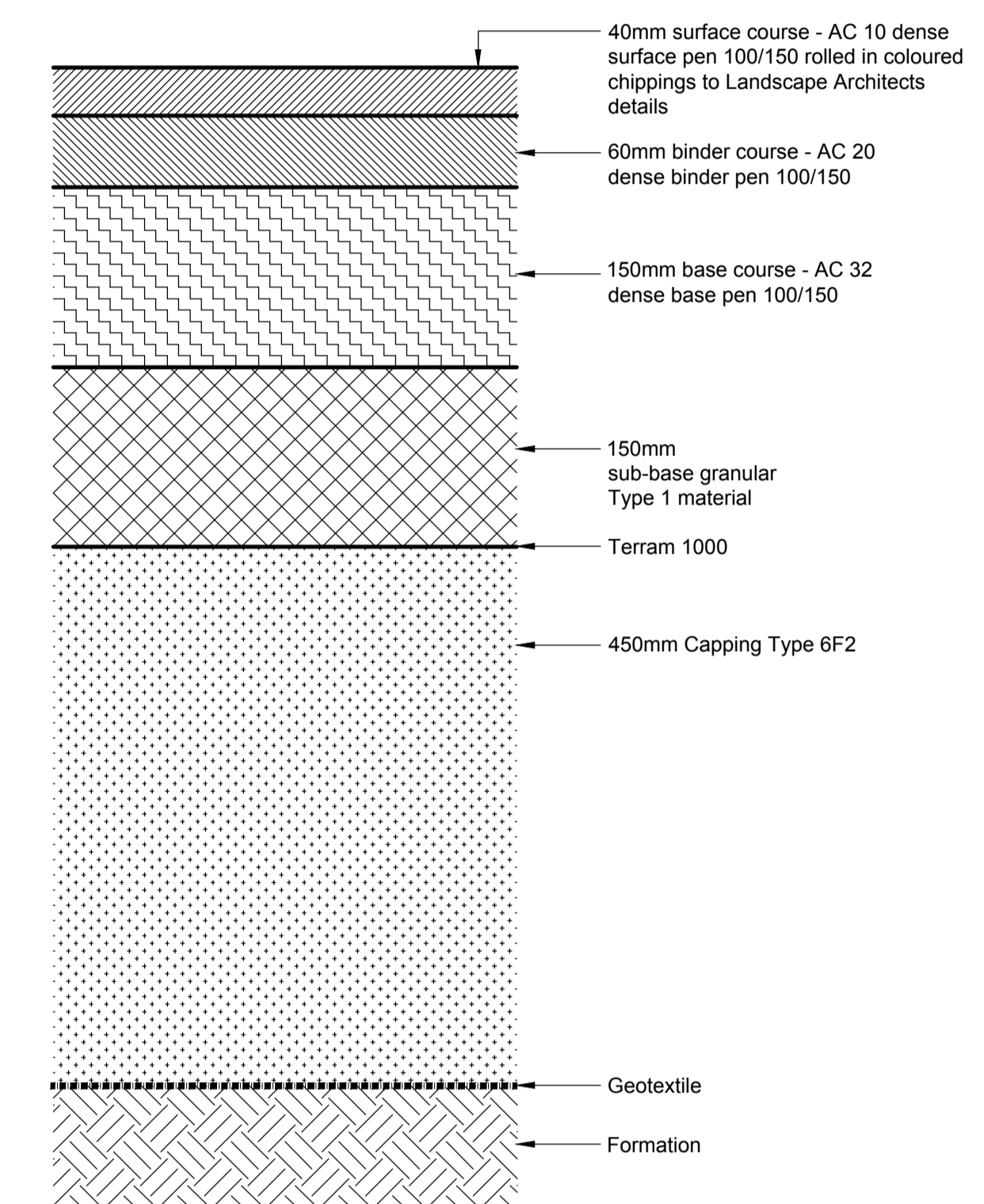

D13 - TEMPORARY VEHICULAR TARMAC ACCESS ROAD

- GENERAL NOTES**
- Pavement build ups are based on a CBR of 2% as set out in the Ground Investigation Report, Ref J14212. CBR tests need to be carried out in-situ at the proposed formation level, prior to final design and construction.
 - All material is to be non frost susceptible.
 - Laying course and sub-base granular material in accordance with BS 13242.
 - Road formation to be checked for soft spots. Soft spots to be removed and replaced with Type 1 material for attenuation or 4/20mm clean stone for filtration.

VEHICLE TYPE DEFINITIONS		
TYPE	WEIGHT (Tonnes)	EXAMPLES
Cars	< 3.5	Cars
Light Commercial Vehicle (LCV)	3.5 - 7.5	Vans
Medium Commercial Vehicle (MCV)	7.5 - 16	Fire Engine, School Bus
Heavy Commercial Vehicle (HCV)	> 16	Bin/Skip Lorry, Removal Lorry, Tanker and larger

TABLE A								
Existing formation CBR		<2.0	2	3	4	5	9	>15
Standard Construction	Depth of sub-base (mm)		150	150	150	150	150	150
	Depth of capping (mm)	Requires special treatment	450	350	300	250	200	Not required
Increase depth of Type 1 sub-base and delete capping		-	-	325	275	225	175	150

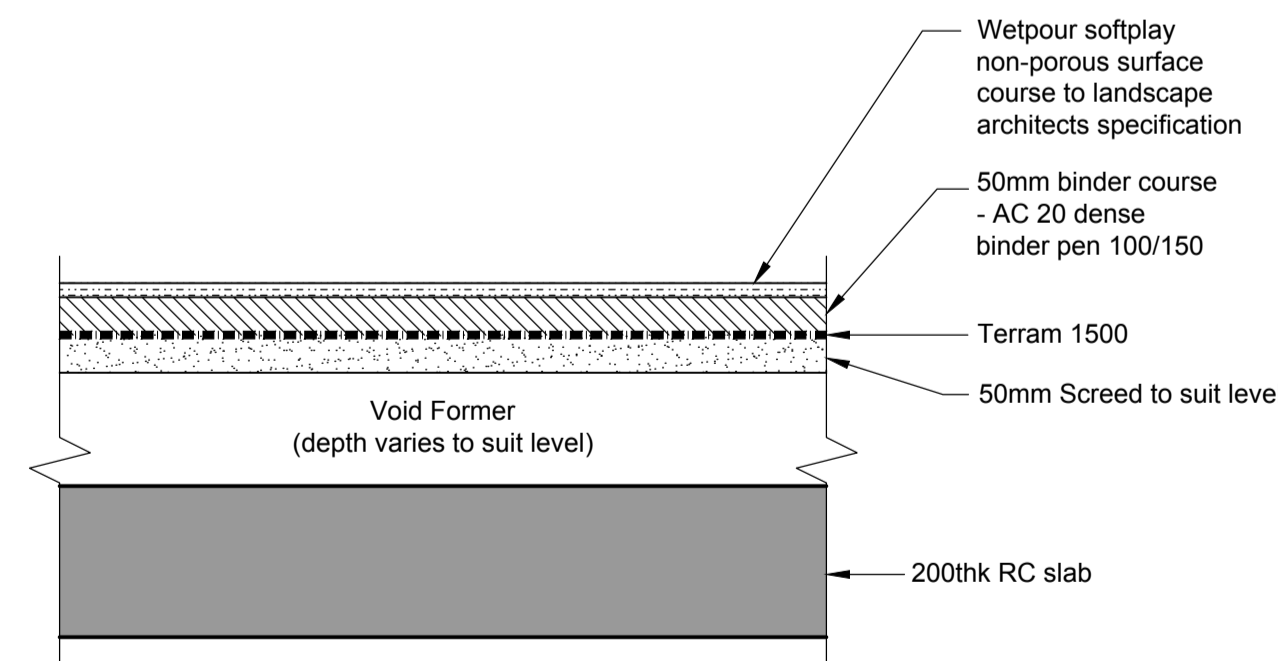

DETAIL 11 - WETPOUR SOFTPLAY SURFACE (NON-POROUS) OVER RC SLAB
SCALE 1:10

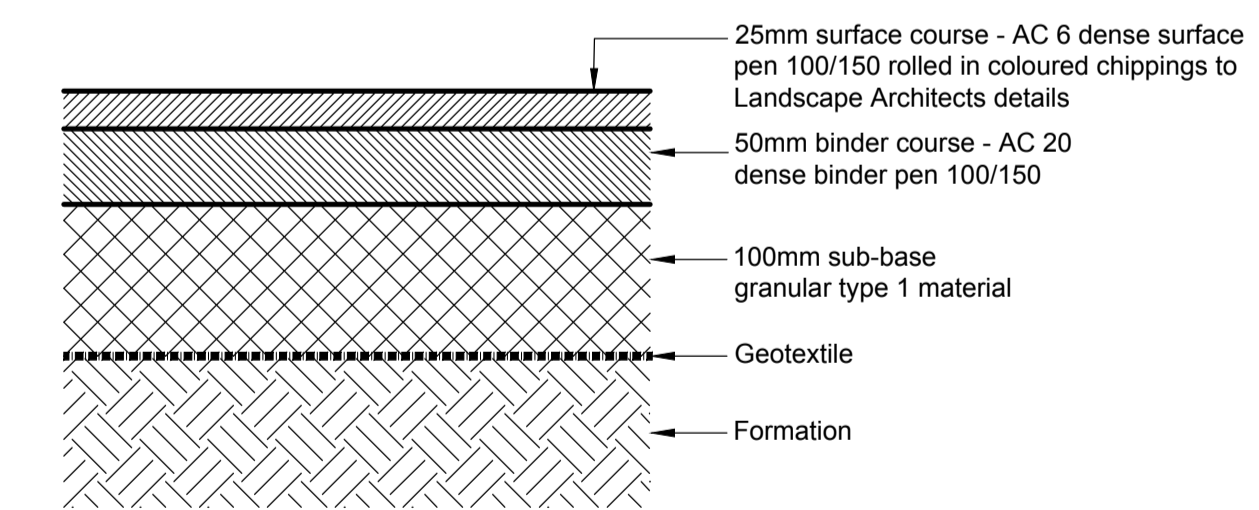

D14 - TEMPORARY ASPHALT - FOOTPATH

INFILTRATION		ATTENUATION	
CBR (%)	Coarse graded material (mm)	CBR (%)	Capping material (mm)
1%	+ 300	1%	600
2%	+ 175	2%	350
3%	+ 125	3%	250
4%	+ 100	4%	200
5%	-	5%	-

ADJUSTMENT TO PAVEMENT DESIGN FOR LOW CBR SUBGRADE

- Notes :**
- This Drawing is to be read in conjunction with all relevant Architect's Engineer's and specialists' drawings and specifications.
 - Do not scale from this drawing in either paper or digital form. Use written dimensions only. To check drawing has been printed to the intended scale this bar should be 50mm long @ A1 or 25mm long @ A3.
 - Health & Safety : All specific drawing notes are to be read in conjunction with the project "Information Pack" and "Site Rules".
 - Refer to drawing no. 22885-700 and 701 for locations.

Ver	Date	Drawn	Eng	Amendment
8	11.04.16	DLA	KB	Issued for Construction
7	08.04.16	DLA	KB	Issued for Draft Construction
6	12.02.16	AH	KB	Issued for Construction
5	26.10.15	DLA	KB	Issued for Tender
4	18.08.15	DLA	KB	Issued for Tender
3	28.04.15	DLA	KB	Issued for Tender
2	21.04.15	DLA	KB	Issued for Tender
1	20.03.15	DLA	KB	Stage 3 Issue

**KINGSGATE SCHOOL
LIDDELL ROAD**

**PAVEMENT BUILD-UPS
DETAILS SHEET 1**

Status **FOR CONSTRUCTION**

Drawn	DLA	Eng	KB
Scales 1:5 at A1		1:10 at A3	
Drawing No		Ver	
22885-710		8	