

Lifetime Homes Statement: 111 Kentish Town Road

**Lifetime Homes Statement**

In respect of:

111 Kentish Town Road,  
London  
NW1 8PB

Prepared by:

**Koupparis Associates**

0207 267 6909

0207 267 6874

## Lifetime Homes Diagram

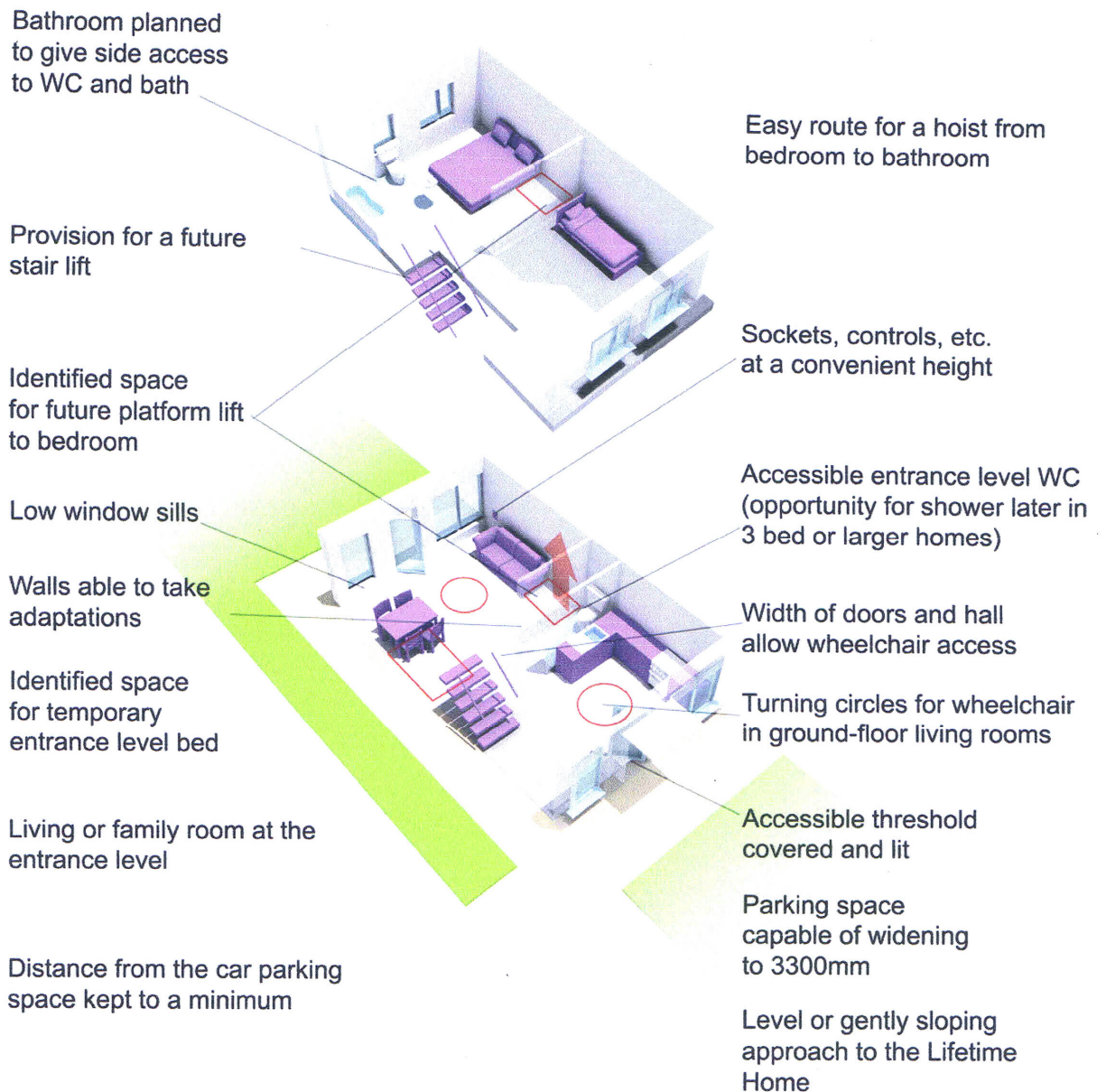

- 1.0 **Car parking width**  
N/A
- 2.0 **Approach to dwelling from parking (distance, gradients and widths.)**  
N/A
- 3.0 **Approach to all entrances**  
Level access threshold at entry with minimal steps to the dwelling.  
Entry directly from the Street and the entry is to be illuminated to the appropriate standard from this location.
- 4.0 **Entrances:** The entrance is to be illuminated with diffused luminaries and will be provided with 825mm effective clear width at right angles to the communal entrance and 800mm to the flat entrance.
- 5.0 **Communal stairs and Lifts:** Ground Floor Unit so not applicable.
- 6.0 **Internal doorways and hallways:** Existing and new doors are standard size i.e. 762 mm wide. We can provide minimum corridor widths of 900mm within the dwelling and 1050mm within the communal corridor
- 7.0 **Circulation space:** Turning circles are feasible within the rooms as they are large enough.
- 8.0 **Entrance level living space:** The living area is almost level from the entrance door of the dwelling with turning circles possible within the living space.
- 9.0 **Potential for entrance level bed space;** The flat has the bedrooms at entrance level.
- 10.0 **Entrance level WC and shower drainage:** The studio has entrance level WC/Shower/bath.

- 11.0 **WC and bathroom walls:** To be strengthened where possible at 300mm and 1500mm high.
- 12.0 **Stairs and potential through- floor lift in dwelling:** N/A
- 13.0 **Potential for fitting of hoists and bedroom/bathroom:** A Hoist can be provided in the future with some modifications.
- 14.0 **Bathrooms:** All the Bathrooms/WCs have simple clean layouts and have stud walls which can be adapted in the future.
- 15.0 **Glazing and window handles:** All existing and new windows will have 800 mm high cills with easy to reach mechanism.
- 16.0 **Location of service controls;** Service controls to be easily accessible. To be positioned at appropriate accessible heights as per ADM (450mm-1200mm high).