

**TOTAL COVERS:
63no.**

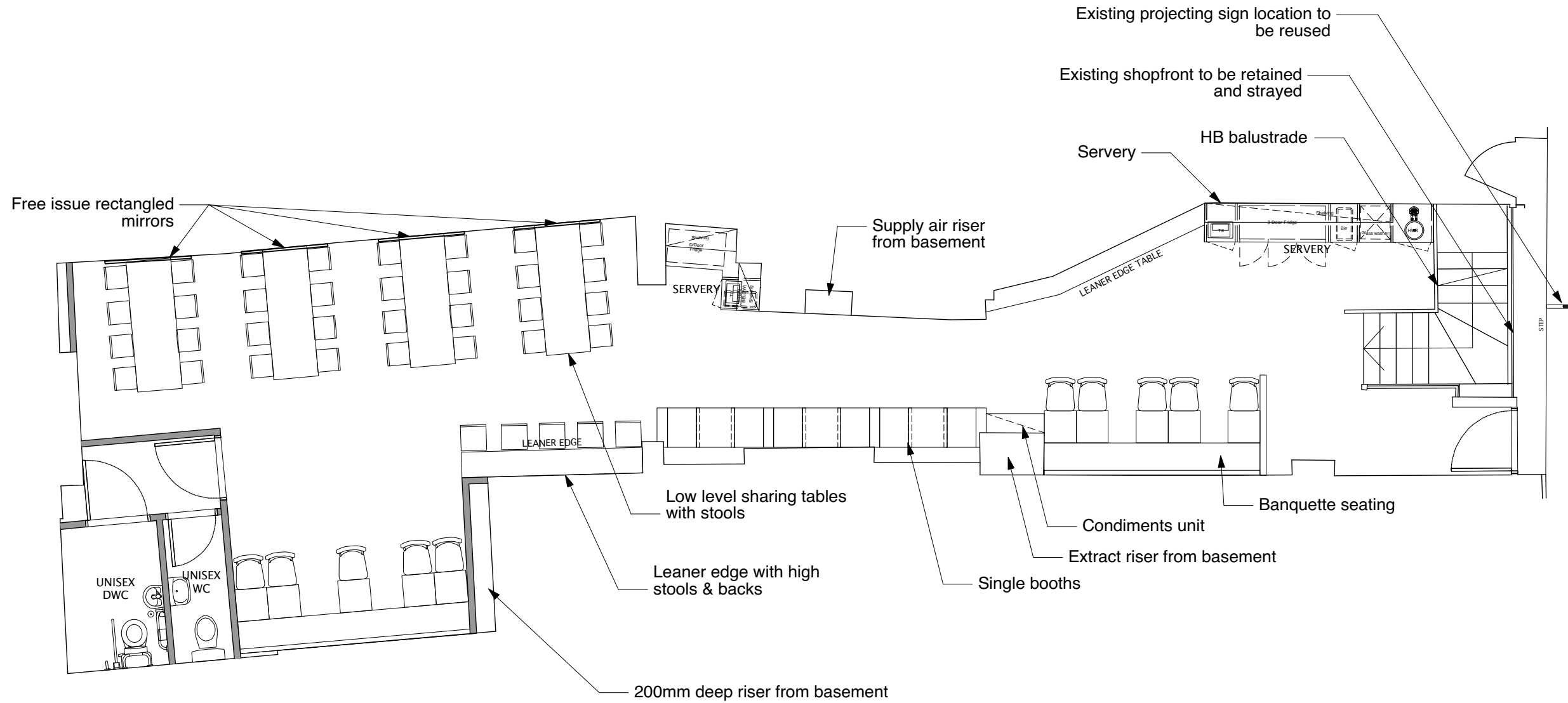

- GENERAL NOTES**
1. ALL FINISHES ARE TO CONFORM TO THE REQUIRED CURRENT BUILDING REGULATIONS IN THE APPLICABLE COUNTRY (IN A U.K. RESTAURANT ALL FINISHES ARE TO BE CLASS 1 OR EQUIVALENT)
 2. CONTRACTORS MUST VERIFY ALL SITE DIMENSIONS, DRAWINGS, DETAILS AND SPECIFICATIONS AND REPORT ANY DISCREPANCIES TO STONEBLUE PROJECTS LTD. BEFORE PROCEEDING WITH ANY WORK
 3. ALL REQUESTED DRAWINGS SHOWING FIXINGS AND CONSTRUCTION DETAILS ARE TO BE APPROVED BY STONEBLUE PROJECTS LTD. PRIOR TO COMMENCEMENT OF WORK
 4. ALL SPECIFIED ITEMS ARE TO BE INSTALLED IN ACCORDANCE WITH THE MANUFACTURERS RECOMMENDATIONS
 5. CONTRACTOR TO PROVIDE A WORKING ENVIRONMENT WHICH CONFORMS TO THE CURRENT HEALTH AND SAFETY AT WORK CONDITIONS AND LOCAL AUTHORITY REGULATIONS
 6. ALL FINISHES ARE TO BE CARRIED OUT TO A HIGH STANDARD
 7. ANY DIMENSIONS ARE TO BE TAKEN FROM THE SETTING OUT PLAN ONLY AND ARE NOT TO BE SCALED FROM THE DRAWINGS
 8. IT IS THE CONTRACTORS RESPONSIBILITY TO UNDERTAKE AND ENSURE THAT ANY BUILDING WORK IS CARRIED OUT UNDER LOCAL AUTHORITY REQUIREMENTS
 9. THE CONTRACTOR IS TO CHECK AND APPRAISE ALL DESIGN, SHOPFITTING AND CONSTRUCTION DETAILS AND OFFER ALTERNATIVES TO THE DESIGNER FOR APPROVAL
 10. IN THE EVENT THAT DRAWING INFORMATION IS NOT THE SAME AND IF THE DESIGNER AND/OR SUPERVISING OFFICER ARE UNAVAILABLE FOR COMMENT THE PROPOSED PLAN IS TO BE READ AS CORRECT
 11. THIS DRAWING IS TO BE READ IN CONJUNCTION WITH THE OTHER RELEVANT CONSULTANTS DRAWINGS
 12. COPYRIGHT OF STONEBLUE PROJECTS LTD. NOT TO BE REPRODUCED

REV	DATE	ITEM

- | | |
|-------------------------------------|---------------------------------|
| <input checked="" type="checkbox"/> | INFORMATION ONLY |
| <input type="checkbox"/> | APPLICATION FOR LOCAL AUTHORITY |
| <input type="checkbox"/> | TENDER |
| <input type="checkbox"/> | CONSTRUCTION |

PROJECT
Honest Burger
Tottenham Court Road
London

TITLE
**Proposed Ground Floor
- GA**

DRAWN	DATE	SCALE
RD	Jan 2016	1:75@A3

PROJECT	NUMBER	REVISION
s2457	04.01	-

Stoneblue Projects I
design, project management, cost consultants

12 Bedford Road
Twickenham
Middlesex
TW2 5EW

ray@stoneblueprojects.co.uk

