

**BASEMENT PLAN
EXISTING**

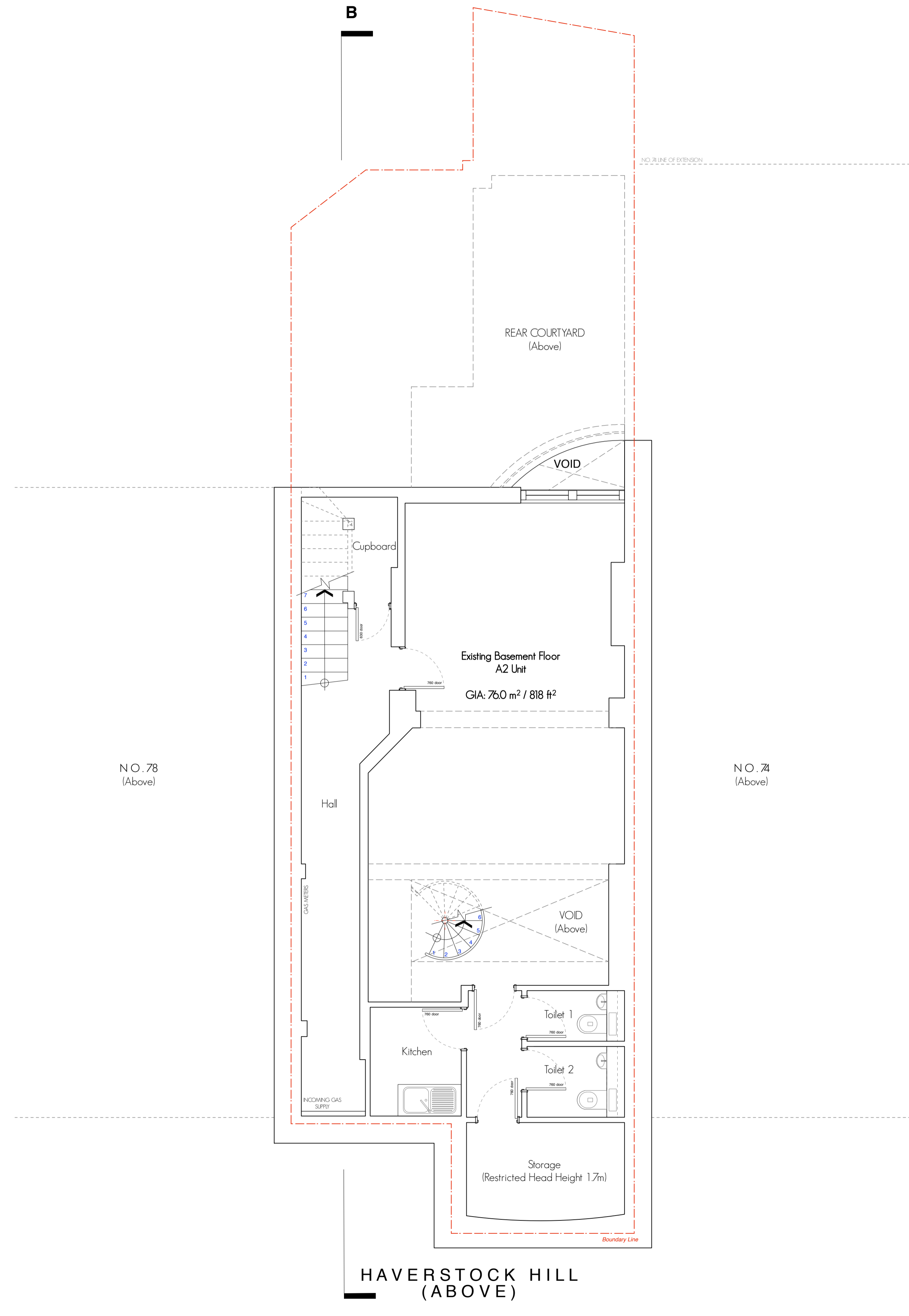

**HAVERSTOCK HILL
(ABOVE)**

rev.	date	notes
A	11.02.16	B2 unit retabled as A2 unit.



CLIENT
ADAM ANDREWS

PROJECT
76 HAVERSTOCK HILL,
LONDON
NW3 2BE

TITLE
EXISTING BASEMENT PLAN

DWG NO 513-PA.04 **REV** A

DRAWN BY SF **SCALE** 1:50 @ A1

CHECKED BY JW **DATE** FEB 2016

T: 020 7549 2133 Unit 1
F: 020 7549 2144 9a Dollington Street
E: info@gpadltd.com Clerkenwell
W: www.gpadltd.com London EC1V 0BQ

This drawing is the copyright of gpad architecture & interior design. Not to be reproduced, stored or disclosed to any unauthorised person either wholly or in part without written permission. Do not scale off this drawing. All indicated dimensions to be checked and verified on site by the contractor before commencement of any fabrication, drawing or work whatsoever. Report any discrepancies to the Architect immediately. Drawings to be read in conjunction with relevant drawings and specifications.

FILE NAME **PRINT SIZE** A1