

A DETAIL
JOINTING CHAMBER DETAIL NTS

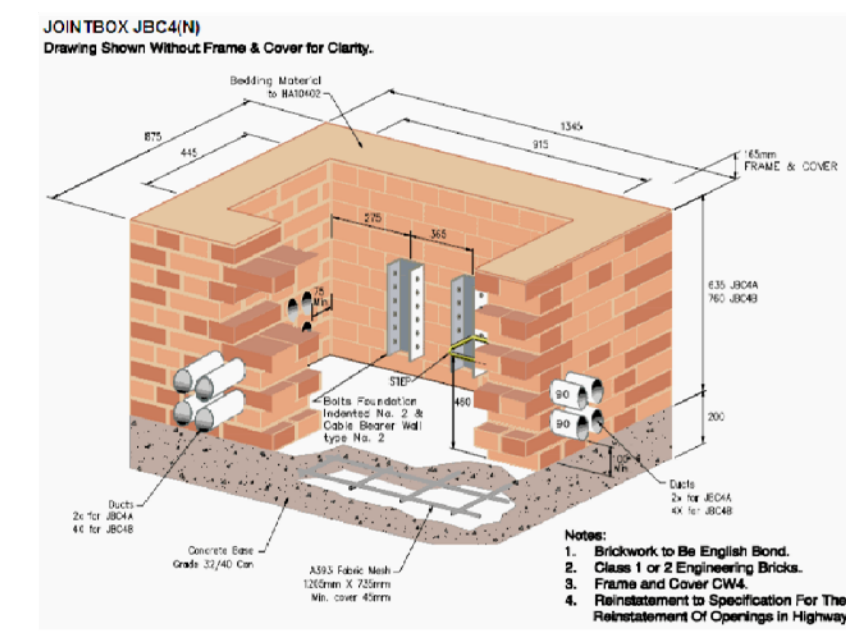

B DETAIL
BT DEVELOPERS GUIDE
TYPICAL JOINTING
CHAMBER CONSTRUCTION NTS

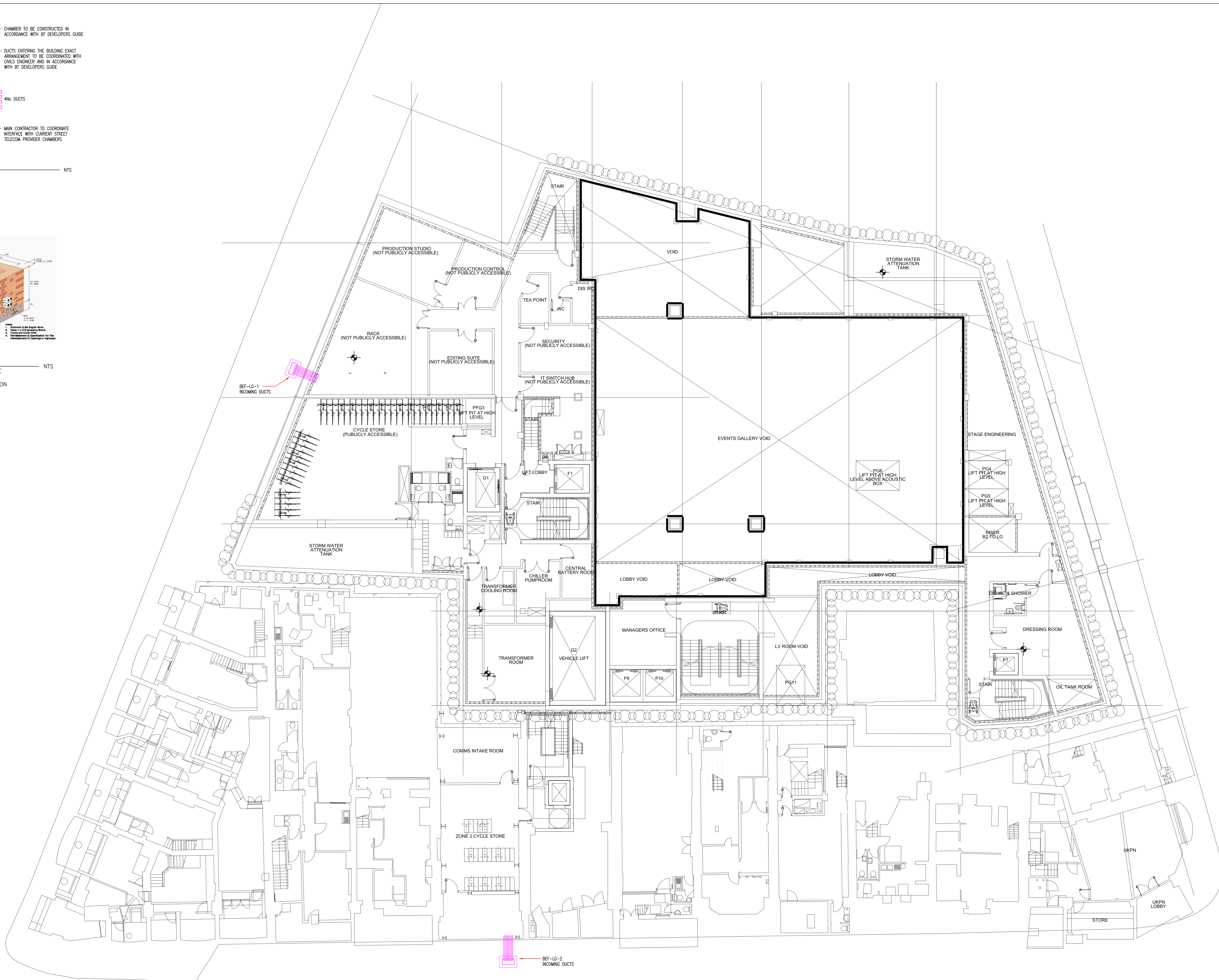

- NOTES**
1. TO BE READ IN CONJUNCTION WITH ALL IPT DESIGN DRAWINGS & SPECIFICATIONS
 2. ALL SERVICE ENTRY POINTS SHALL BE SUBJECT TO A SITE SURVEY AND AGREEMENT WITH THE STATUTORY AUTHORITY
 3. ALL INCOMING TELECOM SERVICES SHALL ENTER BUILDING VIA INDICATED PENETRATION THEN RUN TO FALL TO PREVENT ACCUMULATION OF WATER WITHIN PUDDLE FLANGE
 4. THE SETTING OUT AND LEVELS OF SERVICES ARE SHOWN FOR INFORMATION ONLY. THE CONTRACTOR IS TO CHECK THE RELATIVE LEVELS AND SETTING OUT ON SITE AND AGREE INCOMING POSITIONS WITH THE CIVIL ENGINEER.
 5. REFER TO DRAWING 9448-T-9500 FOR LEGEND



T1	14.05.15	TENDER ISSUE	GD
A	15.04.15	TENDER ISSUE	GD
STAGE 4			
Project: ST GILES			
Title: TELECOMS INTAKE (BEF) POSITIONS			
Drawn:	Drawn:	Designed By:	Checked By:
JWP/13	SF	JB	JB
Scale:	1:1000@AD		
9448	T	8267	T1