

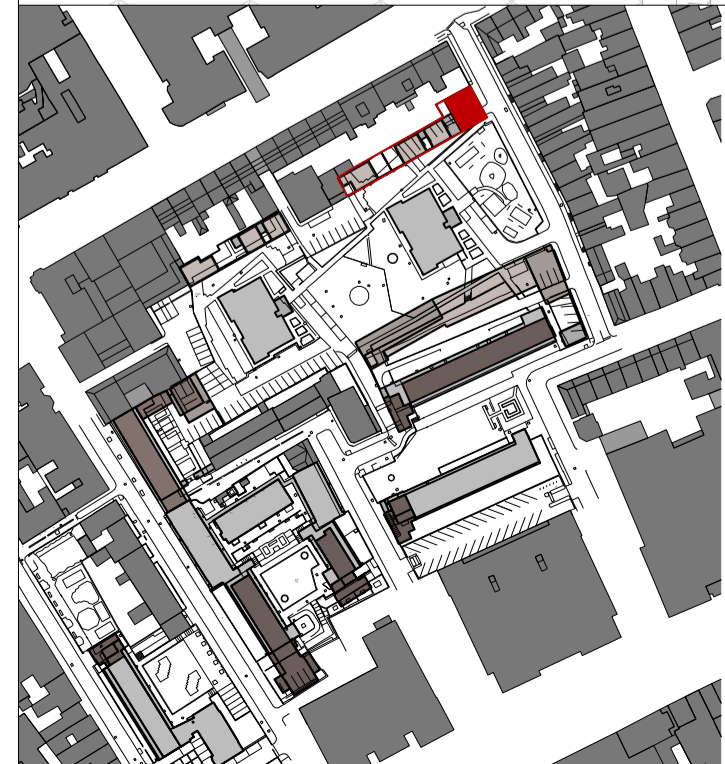

Please refer to drawings by
New Architects Ltd.
for the main house and new
substation

Z1
(02)236



NOTES:

- | | | | |
|---|------------------------------------|--|------------------------------------|
| 01 Entrance Area / Lobby | 16 Bicycle Storage | 31 Service riser | 44 L30/410 Aluminium access ladder |
| 02 Bin Store | 17 Caretaker Facility | 32 Weep hole to be executed as open joint (set out equally spaced to brick dimensions) | 45 L30/250 Metal access stair |
| 03 Kitchen & Dining Room | 18 Gasmeter Room | 33 Refuse Chute | |
| 04 Living Room | 19 Access to CHP | 34 Linear lighting channel | |
| 05 WC w/ shower | 20 Lift shaft to CHP (no lift car) | 35 Pendant light fixing | |
| 06 Storage | 21 Flue of CHP | 36 Allowance for future through the door lift | |
| 07 M&E Cupboard w/ washing machine | 22 Substation | 37 Consumer unit | |
| 08 Lift | 23 Recycling Facilities | 38 Fixed skylight | |
| 09 Double or Twin Bedroom | 24 Gates to entrance courtyard | 39 Rainwater butt (concealed beneath terrace) | |
| 10 Single Bedroom | 25 Movement joints | 40 N25/220 push lock anchor point | |
| 11 Bathroom w/ bathtub | 26 Air bricks | 41 Lightning protection strip to rear of RWP. | |
| 12 Private amenity space: balcony / terrace | 27 Pavers | 42 Matt well | |
| 13 Shared amenity space: roof terrace | 28 Rainwater downpipe | 43 N25/210A Mansafe-Guided type fall arrest system for roof maintenance access | |
| 14 Skylight over stair core as access to roof | 29 Casing for SVP | | |
| 15 Green roof | 30 Louvred area for ventilation | | |



| REVISION | DATE | AMENDMENT |
|----------|----------|----------------|
| C | 26.02.16 | General update |
| B | 14.01.16 | General update |
| A | 07.01.16 | General update |

-DO NOT SCALE FROM THIS DRAWING
-ALL DIMENSIONS TO BE CHECKED ON SITE BY THE CONTRACTOR
-AND SUCH DIMENSIONS TO BE HIS RESPONSIBILITY
-REPORT ALL DRAWING ERRORS AND OMISSIONS TO THE ARCHITECT
-ALL DIMENSIONS IN MILLIMETERS UNLESS NOTED OTHERWISE
-R IN DOUT: ASK CONTRACT ADMINISTRATOR

DUGGAN MORRIS ARCHITECTS
Duggan Morris Architects Ltd
Unit 7, 16-24 Underwood street, London, N1 7JQ
Telephone 020 7566 7440
www.dugganmorrish.com

job title
TYBALDS ESTATE REGENERATION

drawing title
MEWS BOOKEND SECOND FLOOR

status
CONSTRUCTION

scale
1:100@A1, 1:200@A3

| job no | source | zone | element | drawing no. | revision |
|--------|--------|------|---------|-------------|----------|
| A186 | A | Z1 | (01) | 133 | C |