

BUILDING DESIGN PARTNERSHIP LTD SHALL HAVE NO RESPONSIBILITY FOR ANY USE MADE OF THIS DOCUMENT OTHER THAN FOR THAT WHICH IT WAS PREPARED AND ISSUED.  
 ALL DIMENSIONS SHOULD BE CHECKED ON SITE.  
 DO NOT SCALE FROM THIS DRAWING.  
 ANY DRAWING ERRORS OR DIVERGENCES SHOULD BE BROUGHT TO THE ATTENTION OF BUILDING DESIGN PARTNERSHIP LTD AT THE ADDRESS SHOWN BELOW.

**NOTES**

EXISTING BUILDING SURVEY INFORMATION BY PLOWMAN CRAVEN, TO BE READ IN CONJUNCTION WITH ALL RELEVANT PROJECT INFORMATION.

REFER TO SERVICES ENGINEERS DRAWINGS FOR DETAILS OF PROPOSED PLANT INC, RISERS, DUCTS, FLUES, EXTRACT GRILLES, LOUVRES, ETC, AND ASSOCIATED BUILDERS WORK.

KEY:

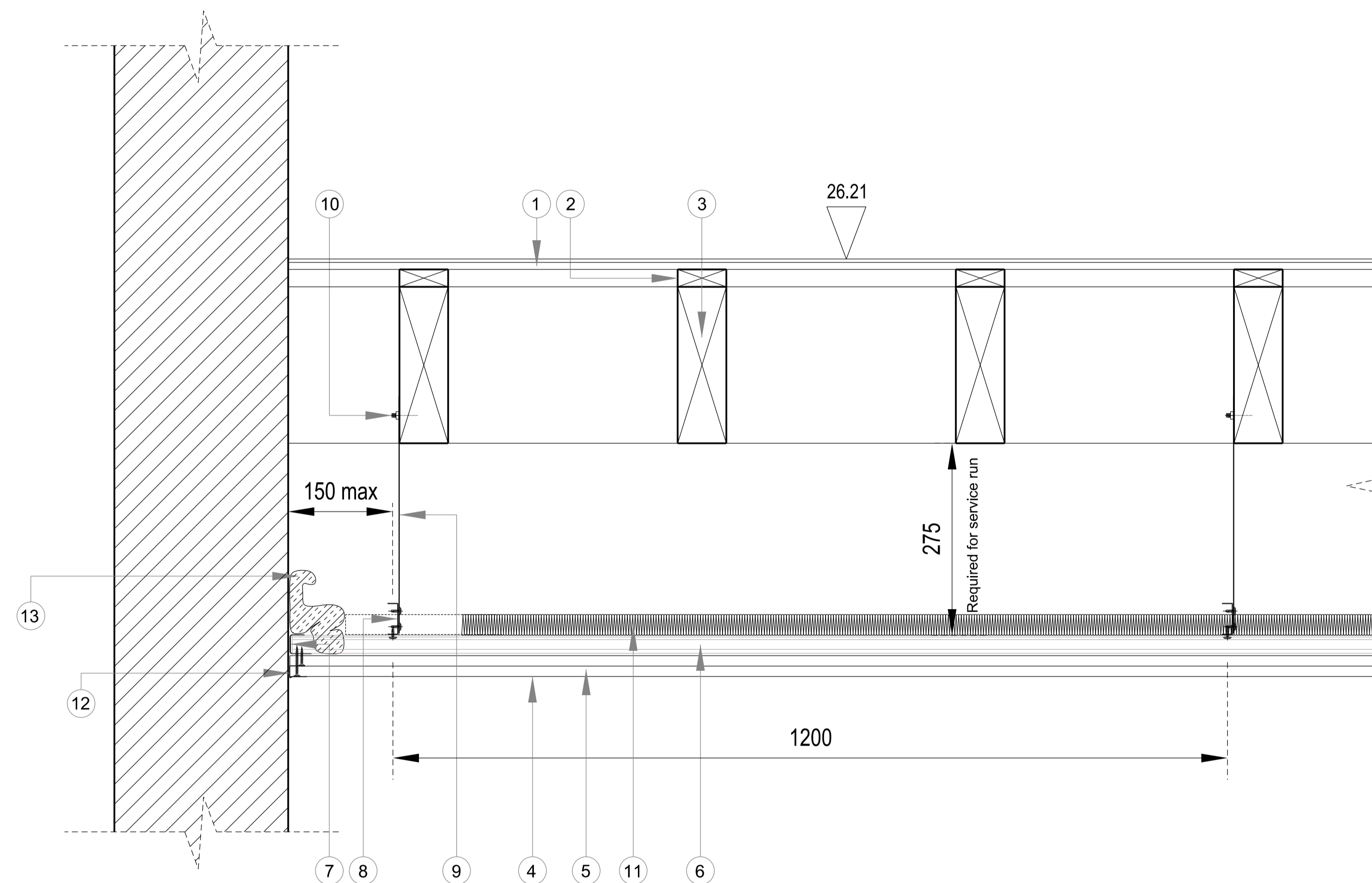

- 1 Existing floor boards
- 2 Existing packers
- 3 Existing floor joists 225x70mm @400mm c/c
- 4 2mm thistle skim coat plaster
- 5 2 x 15mm Gyproc fireline plasterboard fixed with British Gypsum Drywall Screws at 230mm centres in field of board & 150mm centres at board ends
- 6 Gypframe MF5 Ceiling Sections at max. 450mm centres fixed to each MF7 with 2 no. British Gypsum Wafer Head Jack-Point Screws or MF9 Connecting Clip
- 7 Gypframe MF6 Perimeter Channel suitably fixed to wall at 600mm centres
- 8 Gypframe MF7 Primary Support Channels at 1200mm centres
- 9 Gypframe MF8 Strap Hanger or FEA1 Steel Angle hangers at 1200mm centres fixed to MF7 with 2 no. British Gypsum Wafer Head Jack-Point Screws
- 10 Strap hangers fixed to side of floor joists with 2 x 32mm British Gypsum Drywall timber screws
- 11 30mm stone mineral wool insulation
- 12 Gyproc drywall edge bead
- 13 To minimise loss of sound insulation & maintain fire resistance of system, cloak unfixed perimeter using stone mineral wool (33kg/m<sup>3</sup>) by others secured with Gypframe FEA1 steel angel suitably fixed to wall at 600 mm centres

CASOLINE MF CEILING - Spec Ref K10/215A

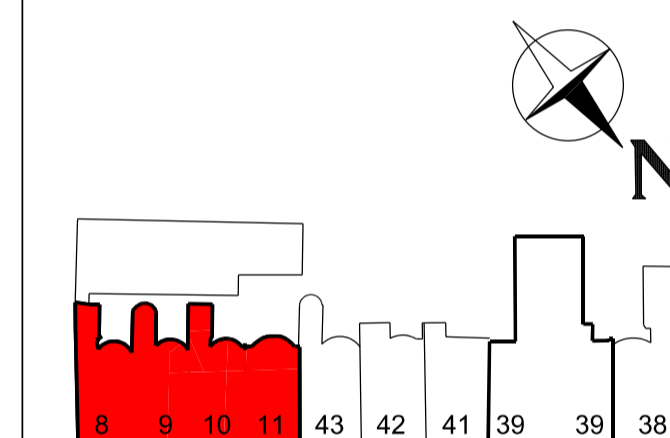

REVISION / DESCRIPTION	DRAWN	CHECKED	DATE
Issue for Construction		JT	19/01/16



**BDP.**

16 Brewhouse Yard  
 Clerkenwell  
 London EC1V 4LJ  
 United Kingdom  
 T +44 (0)20 7812 8000  
 F +44 (0)20 7812 8399  
 www.bdp.com

PROJECT TITLE  
**British Museum  
 Perimeter Properties Refurbishment**

PROJECT NUMBER  
**P2002323**

DRAWING TITLE  
**No.8 - No.11 Montague Street  
 Proposed Series  
 Basement MF Ceiling Detail  
 Issue for Construction**

ISSUE NO.  
**(35)AD001**

SCALE  
**1:5 @ A1  
 1:10 @ A3**

DATE  
**19/01/2016**

REVISION

-