

NOTE
 DO NOT SCALE FROM THIS DRAWING. FIGURED DIMENSIONS ONLY ARE TO
 BE TAKEN FROM THIS DRAWING. ALL DIMENSIONS ARE IN MILLIMETRES
 UNLESS OTHERWISE STATED.
 CONTRACTOR TO CHECK AND CONFIRM ALL DIMENSIONS AND SETTING
 OUT ON SITE. REPORT ANY ERRORS OR OMISSIONS TO WGI.
 EXISTING INFORMATION BASED ON SURVEY MODEL RECEIVED
 2015-10-20 (MODEL REF "32624RM-01-WP", "32624RM-02-WP",
 "32624RM-03-WP", "32624RM-04-WP") SURVEY MODEL IS PARTIALLY
 INCOMPLETE AND REQUIRES UPDATE FROM SURVEYOR. PROPERTY
 LINE SHOWN IS TO BE CONFIRMED
 CURRENT MODEL FILE NAME -114031-WGI-00-ZZ-M3-A-0001
 CURRENT MODEL REVISION - 1

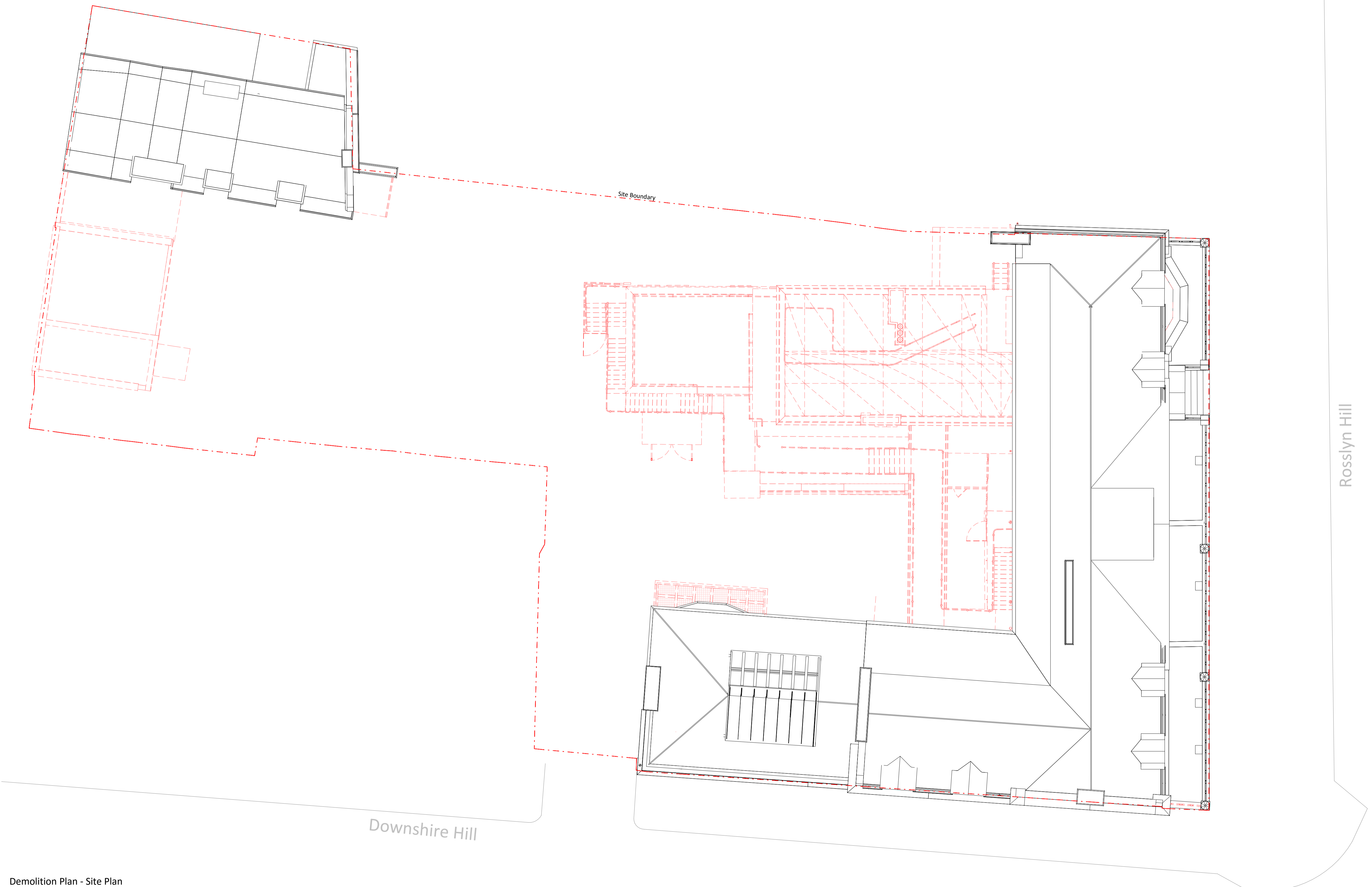

Demolition Plan - Site Plan
 1 : 100

Legend

Existing elements to be demolished

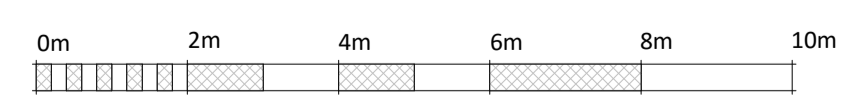

Scale 1:100

Rev	Date	By	Note
2016-03-22	ER	Issued For Planning	

PROJECT NUMBER
 114031

PROJECT
 Abacus Belsize Primary School
 26a Rosslyn Hill, London NW3

DRAWING NAME
 Demolition Plan - Site Plan

DRAWING NUMBER
 114031 - P401

DATE
 22.03.2016

SCALE
 1 : 100

DRAWING SIZE
 A1

DRAWN BY
 AR

CHECK
 RM

REVISION
 -



Watkins Gray International LLP
 Colechurch House
 1 London Bridge Walk
 London SE1 2XK
 United Kingdom
 t: +44 (0)20 7940 8400