

APPENDIX D

SCALED DRAWINGS

DO NOT SCALE FROM THIS DRAWING - ALWAYS WORK TO DIMENSIONS GIVEN

GENERAL NOTES:

1. All Swanton Consulting (SC) drawings are to be read with the specification and with all relevant architect's and engineers drawings and specifications.
2. The existing structure shown on these drawings is based on information provided by/on behalf of our client or obtained from limited site inspection. The nature of the existing structure should be confirmed by the contractor prior to starting any works.
3. The information on the proposed works indicated on these drawings is based on information provided by/on behalf of our client and is shown for information only and no reliance should be placed upon it without checking with the issuing party.
4. It has been assumed that there are no live services in the area of proposed works indicated, the contractor is to inform Swanton Consulting if this is not the case. All works associated with the identification, alteration or termination of services are to be carried out by others and not included in Swanton Consulting's works.
5. Scheme is a preliminary sketch to accompany the temporary works design brief for the works

- Haki Staircase
- Cabins
- Viewing/Access Platform
- Fire Escape/Access Route on Capping Beam

P7	Amended as Per Client Comments	MG	IV	29.03.16
P6	Amended as Per Client Comments	MG	IV	10.03.16
P5	Amended as Per Client Comments	MG	IV	09.03.16
P4	Amended as Per Client Comments	MG	IV	07.03.16
P3	Added Details As Per Client	MG	IV	02.03.16
P2	Moved Gantry Location	MG	IV	23.02.16
P1	Changed to suit clients comments	JL	IV	22.02.16
PO	Initial Issue	MG	IV	19.02.16

Rev.	Description	Drn	Chkd	Date
------	-------------	-----	------	------

Amendments

Drg Status **PRELIMINARY**



Anchor Bay Wharf,
 Manor Way,
 Erith,
 Kent,
 DA8 2AW
 Tel: 0870 950 8800

Client

Erith Contractors

Project

GOSH - Guilford Street Basement

Title

Gantry, Hoarding & Capping Beam Locations - Phase Two

Scale at A3 **1:350** Date **19.02.16**

Project No. **SC-1255** Drg No. **118** Rev. **P7**

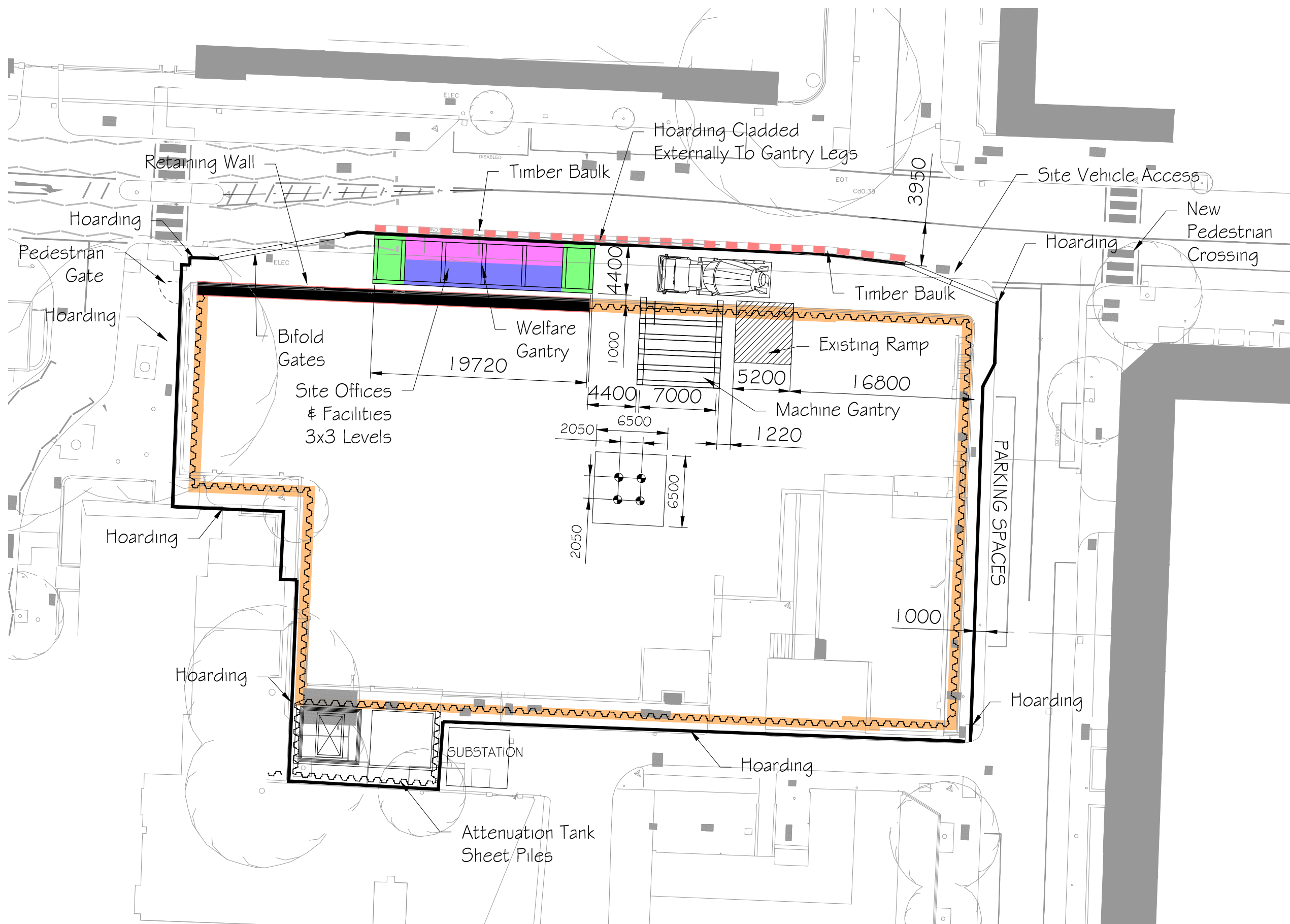

SUBSTATION

Attenuation Tank
 Sheet Piles

PARKING SPACES