



Datum Line 48.00m

1 EXISTING ELEVATION 5
SCALE 1:100



Datum Line 48.00m

2 PROPOSED ELEVATION & SECTION 5
SCALE 1:100

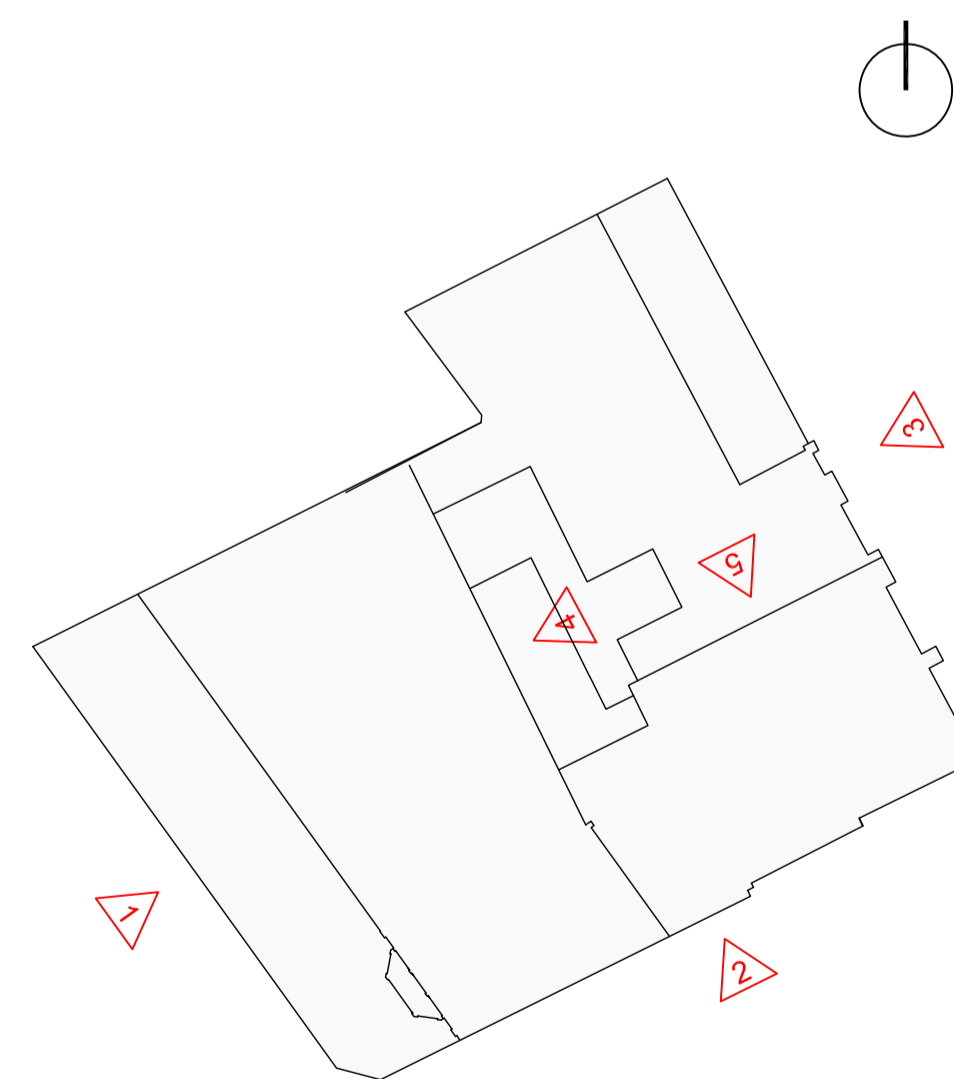
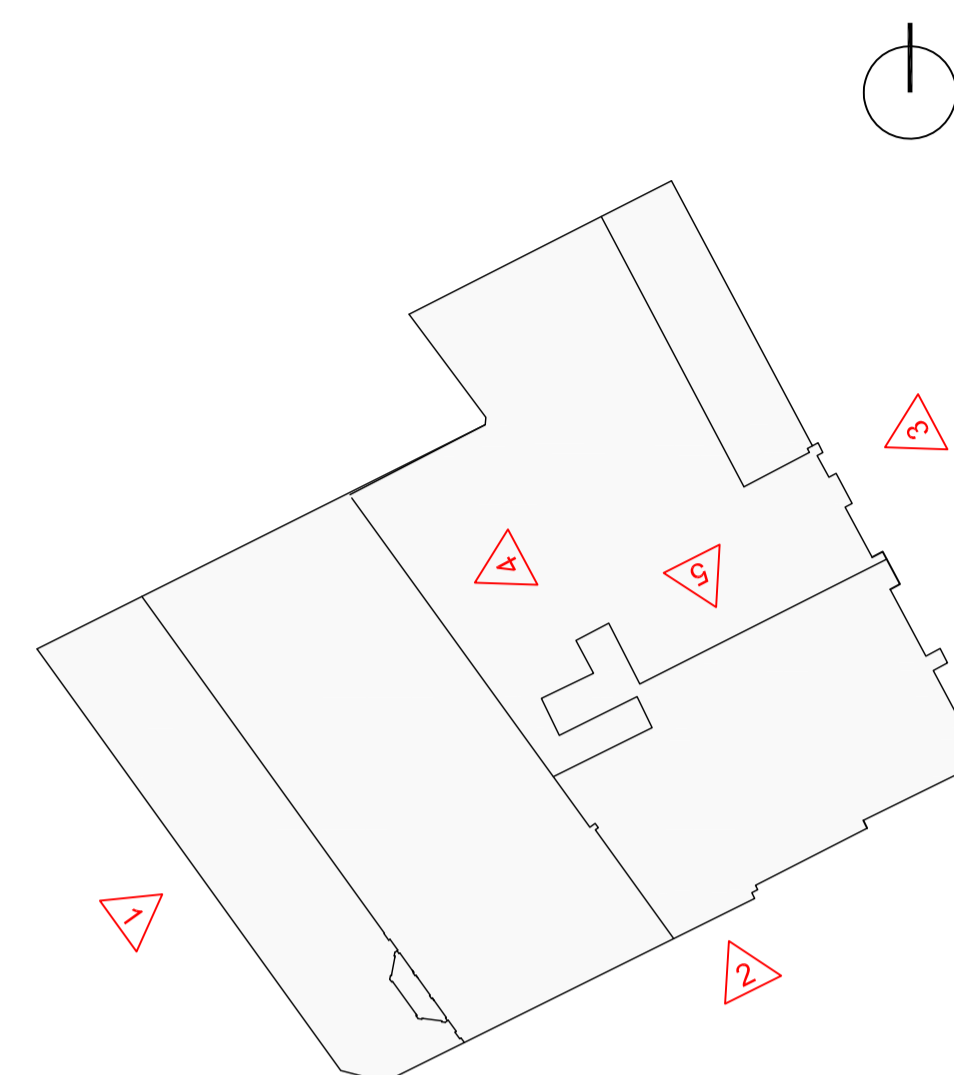

The use of this data by the recipient acts as an agreement of the following statements. Do not use this data if you do not agree with any of the following statements:

All drawings are based upon site information supplied by third parties and as such their accuracy cannot be guaranteed. All features are approximate and subject to clarification by a detailed topographical survey, statutory service enquiries and confirmation of the legal boundaries.

Do not scale the drawing. Use figured dimensions in all cases. Check all dimensions on site.

Report any discrepancies in writing to Wren Architecture before proceeding.

Client

PALMBEST Group
2 Abbey Road
London
NW10 7BW

Architects & Designers

Wren. architect
engineer
and
designer

7 Deane House Studios, 27 Greenwood Place,
NW5 1LB, London, UK - +44 (0) 207424 9448
www.wrenarchitecture.com

Rev	Description	Date	Drn	Chk
A	Revised PP submission	08.01.16	MW	
-	PLANNING ISSUE	06.11.14	MW	

Status
PLANNING ISSUE

Project
**320-324 Kilburn High road
LONDON
NW6 2QN**

Drawing Title
**Existing and Proposed
Elevations 5
Courtyard Elevation of Flats - 2nd Floor**

Project No. 0100	Drawing No. -A-EL-14	Revision A
Scale @ A1 1:100	Drawn By MW	