

NOTES

1. Expected Vehicle Movements = 25/day on Stage 3 programme
2. Week numbers based on Stage 3 programme

REVISED FOLLOWING COMMENTS NK 07/07/16  
 REVISED FOLLOWING ST GILES CROSSING 12/11/15  
 CLOSED FOR MEETING ST GILES CROSSING 18/09/15  
 WORKING GROUP MEETING 03/09/15  
 REVISED FOLLOWING INTERNAL REVIEW NK 10/09/15  
 REVISED FOLLOWING COMMENTS NK 06/07/16

Consolidated Developments Limited



ST GILES CIRCUS, LONDON WC1  
 ZONE 1 & 2  
 LOGISTICS STAGE 4  
 Wks 70 - 105 (Sep17 - May18) 24/06/15  
 SKA-LOG-004 05

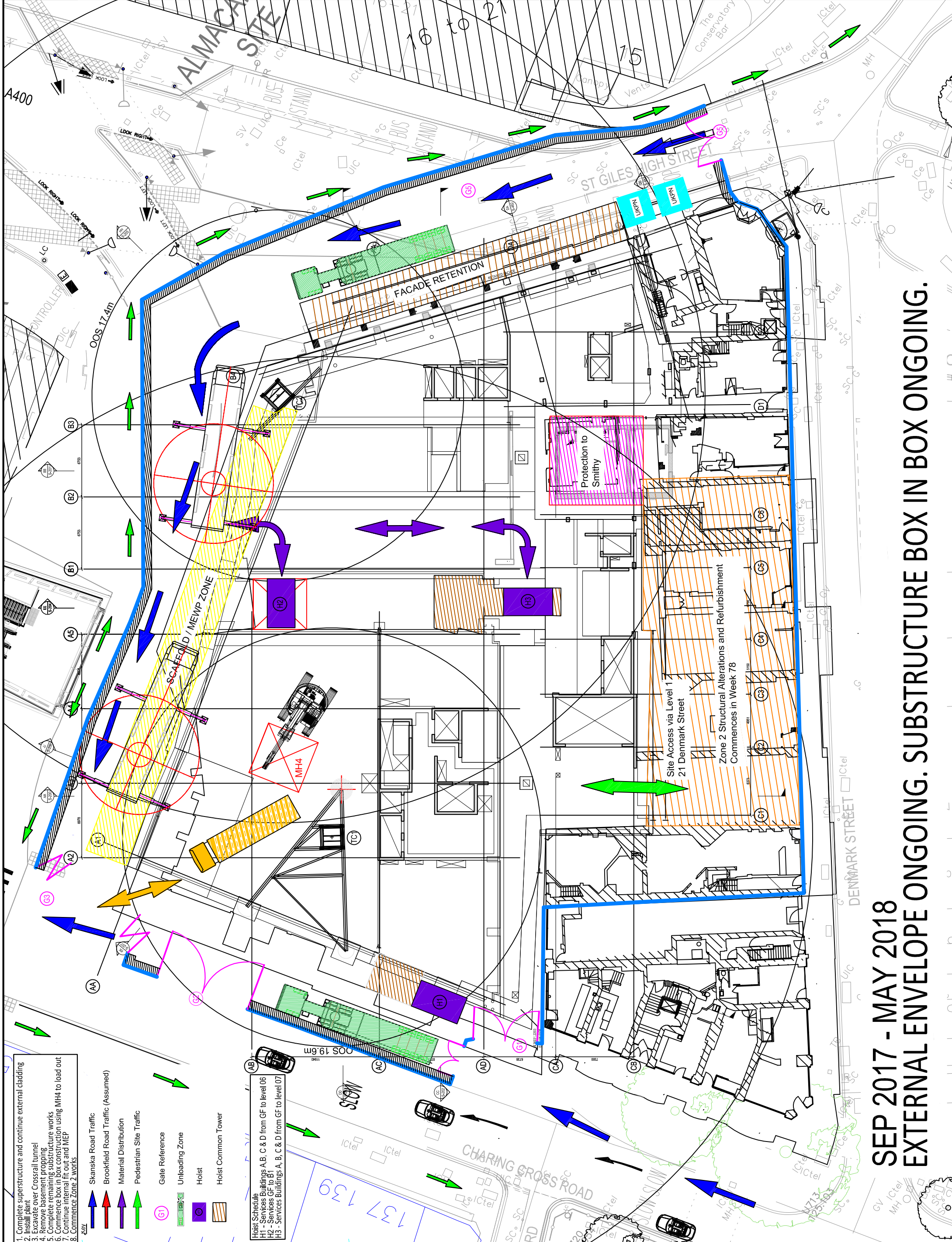

1. Complete superstructure and continue external cladding
2. Install plant
3. Excavate over Crossrail tunnel
4. Remove basement propping
5. Complete remaining substructure works
6. Commence box in box construction using MH4 to load out
7. Continue internal fit out and MEP
8. Commence Zone 2 works

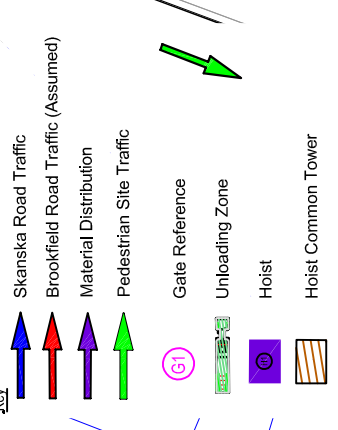

Hoist Schedule  
 H1 - Services Buildings A, B, C & D from GF to level 06  
 H2 - Services GF to B1  
 H3 - Services Buildings A, B, C & D from GF to level 07

SEP 2017 - MAY 2018  
 EXTERNAL ENVELOPE ONGOING. SUBSTRUCTURE BOX IN BOX ONGOING.