

Engineering Key

- AC1 — Indicates adoptable Combined sewer
- F1 — Foul private water inspection chamber
- S1 — Storm private water inspection chamber
- ⊕ — Rainwater down pipe
- ◆ — Soil vent pipe/internal drainage point
- 100#/80 — Diameter / Gradient
- ⊕ — Yard gully
- Aco Channel drain or similar approved with heel guard grating. Channel to incorporate silt trap at outfall.
- F.F.L 50.425 — Proposed building finished floor level
- 50.425+ — Proposed finished level
- Dropper Kerb
- Suspended high Level Foul Drainage
- Suspended high Level Storm Drainage
- DAB1 — Drop down from above to below

ELLIOTT SQUARE

15

ADELAIDE ROAD

ELSWORTHY RISE

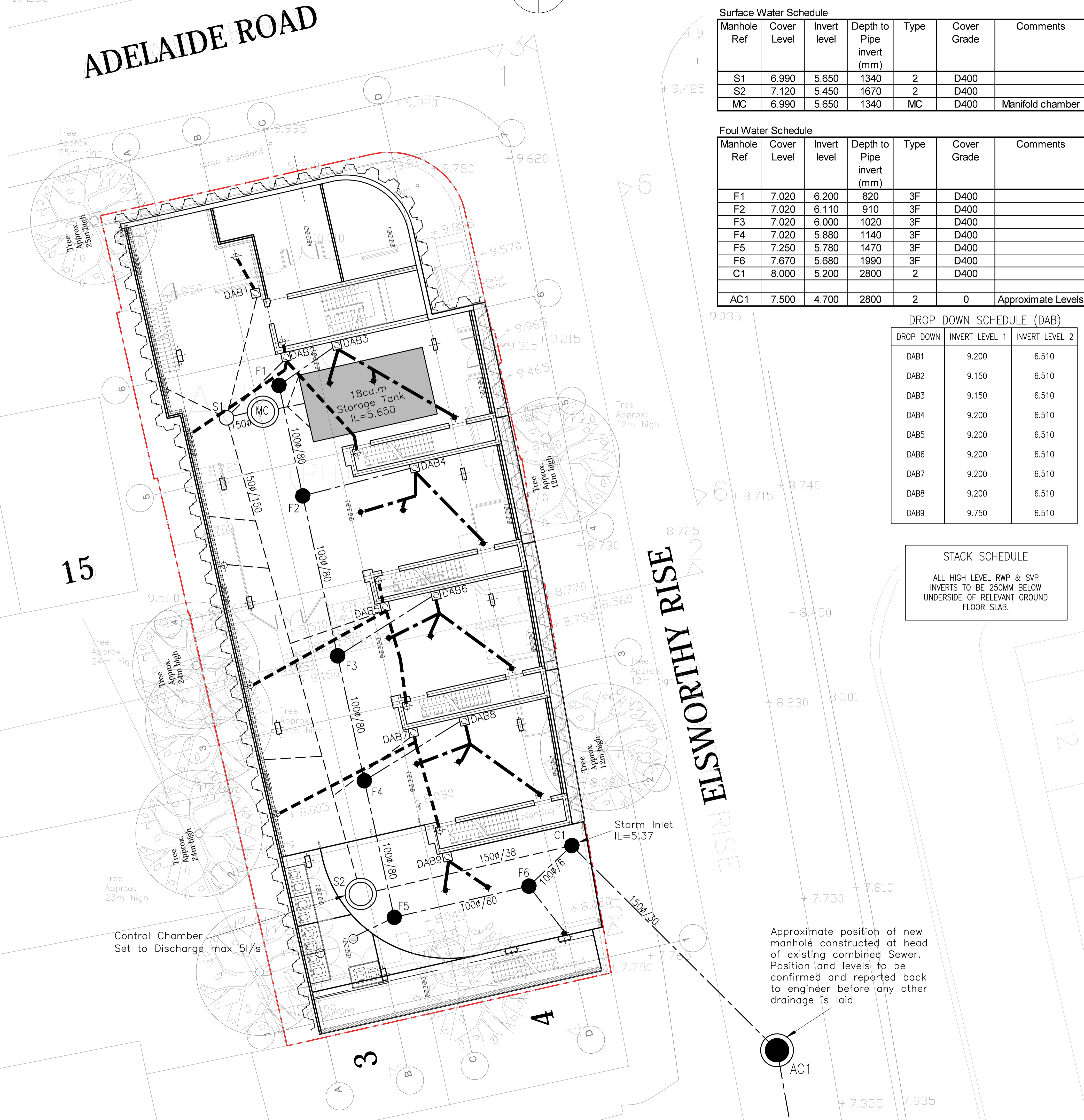

Surface Water Schedule

Manhole Ref	Cover Level	Invert level	Depth to Pipe invert (mm)	Type	Cover Grade	Comments
S1	6.990	5.650	1340	2	D400	
S2	7.120	5.450	1670	2	D400	
MC	6.990	5.650	1340	MC	D400	Manifold chamber

Foul Water Schedule

Manhole Ref	Cover Level	Invert level	Depth to Pipe invert (mm)	Type	Cover Grade	Comments
F1	7.020	6.200	820	3F	D400	
F2	7.020	6.110	910	3F	D400	
F3	7.020	6.000	1020	3F	D400	
F4	7.020	5.880	1140	3F	D400	
F5	7.250	5.780	1470	3F	D400	
F6	7.670	5.680	1990	3F	D400	
C1	8.000	5.200	2800	2	D400	
AC1	7.500	4.700	2800	2	0	Approximate Levels

DROP DOWN SCHEDULE (DAB)

DROP DOWN	INVERT LEVEL 1	INVERT LEVEL 2
DAB1	9.200	6.510
DAB2	9.150	6.510
DAB3	9.150	6.510
DAB4	9.200	6.510
DAB5	9.200	6.510
DAB6	9.200	6.510
DAB7	9.200	6.510
DAB8	9.200	6.510
DAB9	9.750	6.510

STACK SCHEDULE
ALL HIGH LEVEL RWP & SVP INVERTS TO BE 250MM BELOW UNDERSIDE OF RELEVANT GROUND FLOOR SLAB.

Approximate position of new manhole constructed at head of existing combined Sewer. Position and levels to be confirmed and reported back to engineer before any other drainage is laid

- Notes:**
- For drainage construction details refer to drawing No. C6655/CE2.
 - All pipe runs are to be 100mm nominal diameter unless otherwise stated.
 - For information and setting out of internal drainage points refer to Architect's layout drawings.
 - All chamber cover levels given are approximate to +/- 50mm.
 - Pipe gradients are for guidance only. For precise invert levels of manholes, please refer to manhole schedule.
 - All private drainage beneath adoptable carriageway shall be vitrified clay extra strength and with concrete bed and surround should cover depth be less than 1.2m.
 - All level entrances with no channel drain indicated to have level threshold drain installed to architect's details, discharging to granular pit underneath.
 - All suspended drainage is to be fitted with rodding access points as close to the head of the run as possible, at any change in direction and at no more than 12m centres.
 - Traps are to be provided to all new surface water down pipes.
 - All redundant private pipework to be broken out and connections stopped up.

REV	DATE	AMENDMENT	BY	CHKD
B	17/03/16	Storage tank moved position, invert of C1 lowered.	AB	LRW
A	17/03/16	Design adjusted to not incorporate any blue roof. Storm storage tank increased in size as a result.	AB	LRW

STATUS: **PRELIMINARY**

PROJECT: **Adelaide Road**

CLIENT:

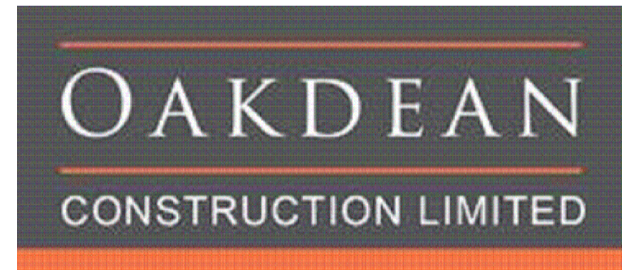

DRAWING: **Drainage Layout**

DATE: 16/3/16 DRAWN BY: AB
 SCALES (@A1): 1:100 CHECKED BY:

DRG NO.: **C6655/CE1**

walkersassociates CONSULTING LIMITED

Address: 13 Capricorn Centre, Crans Farm Road, Basildon, Essex SS14 3JU
 Tel: 01268 530 500
 Fax: 01268 28 60 28
 Web: www.walker-associates.co.uk