

Section 1 - 1
 Typical Existing
 Timber Sash Window
 Section

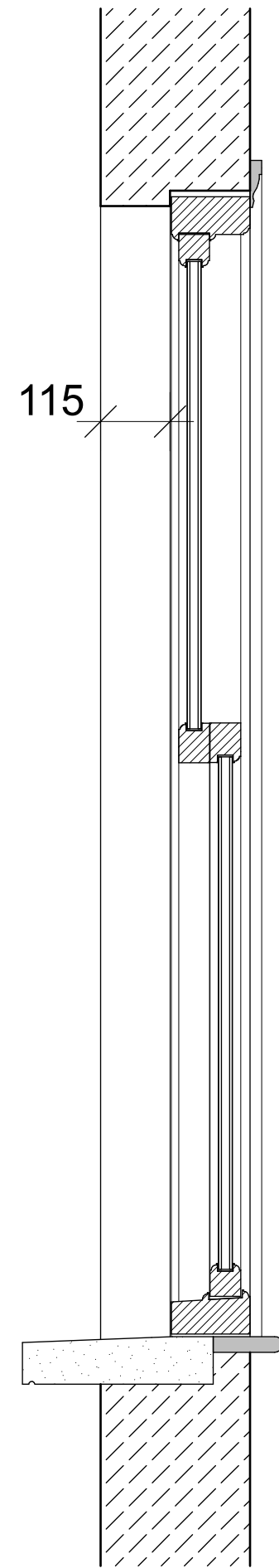

Section 2 - 2
 Typical Proposed
 UPVC Window
 Section



Architects · Project Managers · Quantity Surveyors
 130 New Walk
 Leicester, LE1 7JA
 Tel: 0116 204 5800, Fax: 0116 204 5801
 email: design@rg-p.co.uk, www.rg-p.co.uk

Project: Proposed Replacement Windows
 18 Lupton Street, Camden, NW5 2HT

Client: asra Housing Group

Sheet title: Typical Window sections

Ref: 2583/ 008

Scale: 1:10 @ A2

Date: March 2016

Drawn: PT Checked: