

PROPOSED MONITORING PLAN

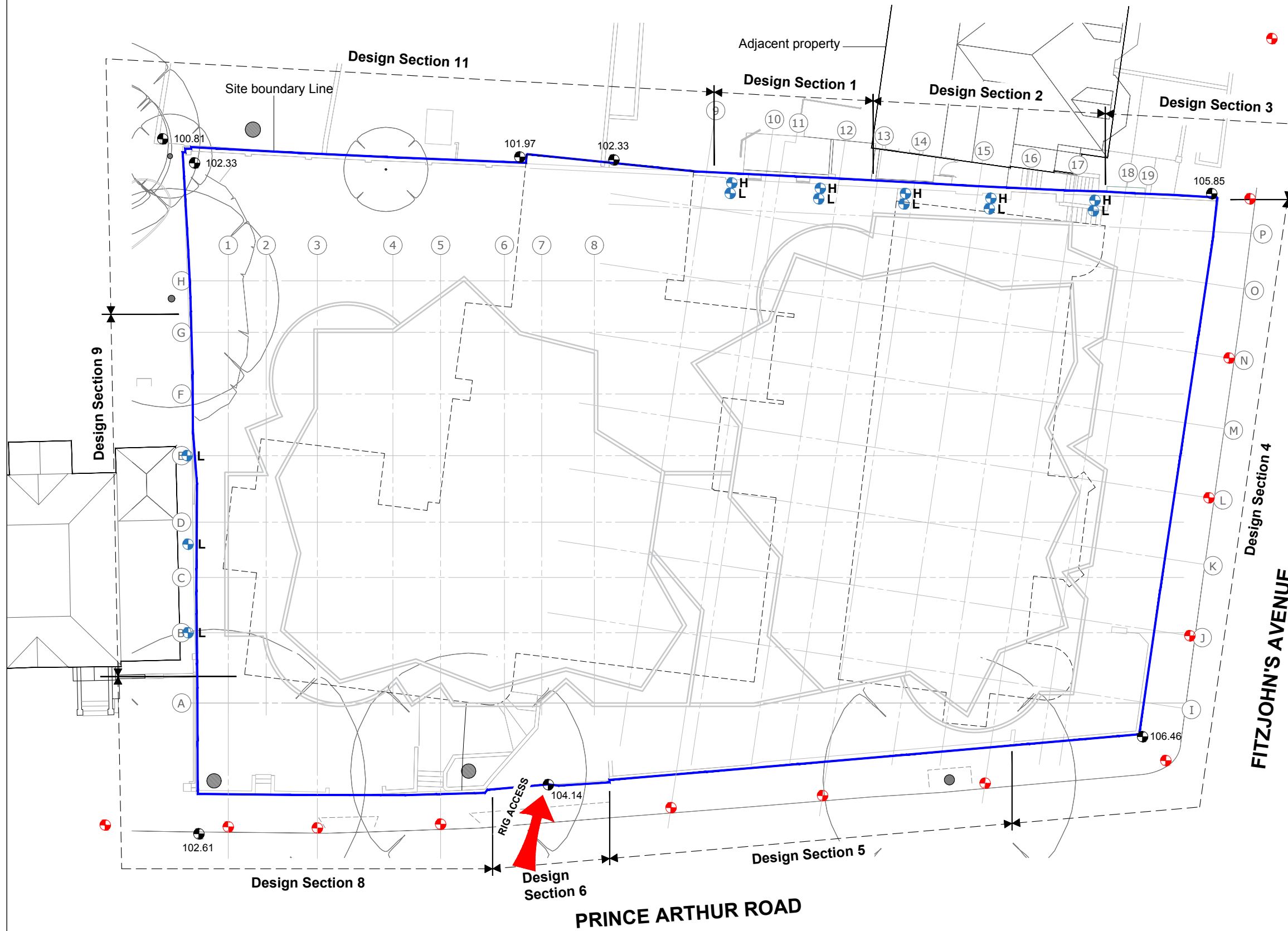

GENERAL NOTES

1. Final position of precise levels and 3D EDM to be confirmed on site to suit site contractors.
2. For monitoring strategy and trigger limits refer to CGL's enabling works specification report.

KEY

- Ground level
- Temporary ground 'hold' level
- Kingpost installed in 600mm dia hole drilled by 360° excavator
- Hit and miss sequencing number
- Stage 1 props
- Remnant of existing structure retained
- Temporary batter
- Site boundary
- Warning risk indicates a residual risk as a warning
- 3D EDM stick on target
H = High
L = Low
- Precise Level
- Existing building
- Proposed building

P2	12/02/2016	Minor revisions
P1	02/02/2016	For comments
Rev	Date	Comments



Card Geotechnics Ltd
4 Godalming Business Centre
Woolsack Way
Godalming
Surrey
GU7 1XW
T: 01483 310600

Project **79 Fitzjohn's Avenue**

Client **Pegasus Life**

Drawing title **Proposed Monitoring Plan**

Scale(s) **1:250** Job No. **CGL/09008**

Drawn OS 02/02/16 Dwg No. **CGL-EW-06** Rev. **P2**

© This drawing is the copyright of Card Geotechnics Limited. It may not be reproduced or amended without the written approval of Card Geotechnics