

SCHEDULE OF NEW WORKS (NW PREFIX)

- 01. NEW CONTEMPORARY KITCHEN WITH HIGH LEVEL CUPBOARDS
- 02. NEW CONTEMPORARY KITCHEN ISLAND
- 03. EXISTING PENDANT LAMPS REPOSITIONED OVER ISLAND
- 04. -
- 05. NEW BOARDED SLIDING DOOR TO MATCH BOARDING TO SIDE OF STAIR
- 06. EXTG DOOR PAINTED WHITE TO MATCH WALL COLOUR
- 07. NEW WHITE STAINED LARCH BENCH (DINESEN)
- 08. NEW FULLY GLAZED DOOR WITH SLIM FRAME
- 09.-
- 10.-
- 11.-
- 12. NEW FULLY GLAZED TIMBER FRAMED DOOR TO UNDERSIDE OF STAIR. DOOR FRAME TO BE CUT AROUND EXISTING WINDOW CILL PROJECTION WITHOUT DAMAGE TO THE CILL
- 13. NEW KITCHEN CUPBOARDS AT LOOW LEVEL WITH HIGH LEVEL CUPBOARDS FLUSH TO THE CHIMNEY BREAST WALL
- 14. NEW DOWNSTAND STEEL SUPPORTING BEAM FINISHED TO MATCH EXISTING PLASTERWORK
- 15. TILE WET ROOM FLOOR WITH ELECTRIC UNDERFLOOR HEATING
- 16. NEW FULLY GLAZED DOOR WITH SLIM FRAME
- 17. NEW TANKED WETROOM WITH TOILET PAN, SEMI RECESSED WASH HAND BASIN AND CEILING MOUNTED SHOWER HEAD. TILED TO CEILING
- 18. NEW FIRE PLACE SURROUND AND HEARTH IN A GEORGIAN STYLE SIMILAR TO THE EXISTING FIREPLACE AT GROUND FLOOR LEVEL. WITH NEW CAST IRON WOOD BURNING STOVE
- 19. NEW OVERLAY STONE TILE FLOOR WITH ELECTRIC UNDERFLOOR HEATING THROUGHOUT (APART FROM STORE UNDER STAIR)
- 20. EXISTING DOOR REHING TO OPEN OUTWARDS
- 21. INSULATION BACKED PLASTERBOARD TO IMPROVE FINISH & THERMAL PERFORMANCE
- 22. SHOWER BLIND TO COVER DOOR DURING SHOWERING
- 23. LOW POWER LED LIGHTS TO REPLACE INEFFICIENT BULBHEAD LIGHT WITH HOOD TO PREVENT LIGHT SPILL UPWARDS
- 24. WATERPROOF CAVITY DRAIN SHEET TO BE LINED WITH AESTHETIC RIB SHEET COVERING.

GENERAL NOTE: UPGRADES TO THE FIRE AND SMOKE DETECTION SYSTEMS ARE REQUIRED. FIRE DETECTION AND FIRE ALARM SYSTEM IN ACCORDANCE WITH THE RELEVANT RECOMMENDATIONS OF BS 5839-6:2004 TO AT LEAST A GRADE D CATEGORY LD3 STANDARD. DETECTORS MUST BE MAINS OPERATED AND CONFORM TO BS EN 14604: 2005

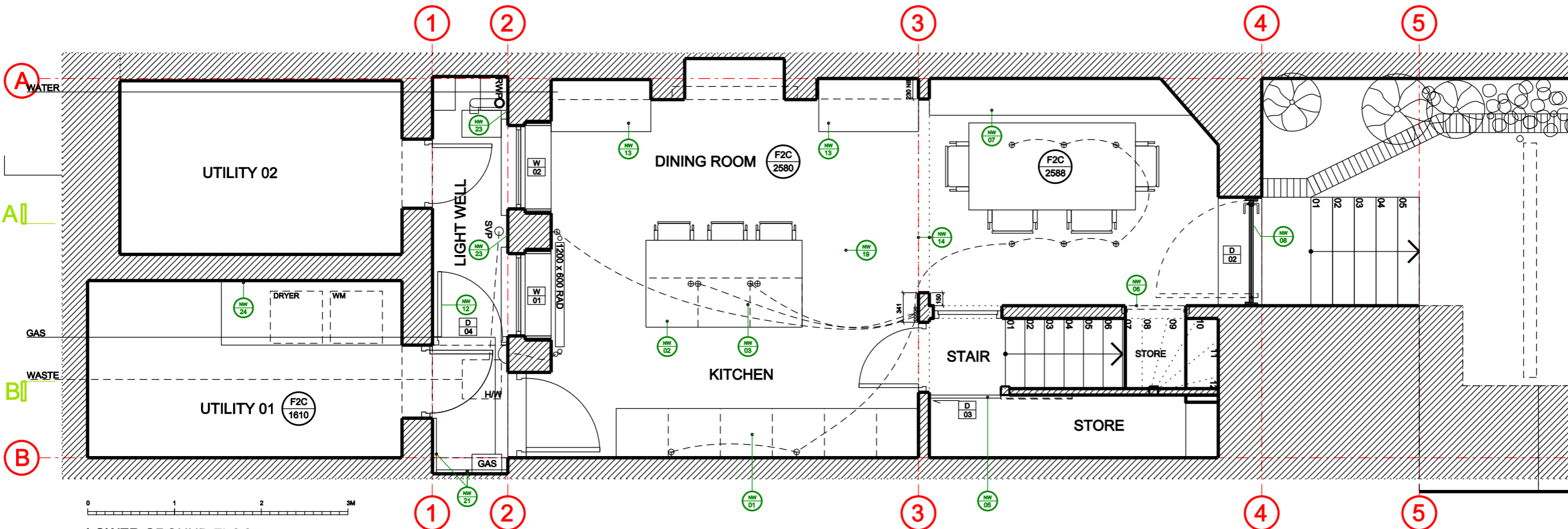

LOWER GROUND FLOOR - PROPOSED

Rev A 10.03.16 Amended following Conservation officer comments

Project No. **15118**

Client Katharine Reid & Michael Crabtree

Scale 1:50 at A3 Date March 2016
1:25 at A1

Project 17 Grove Terrace, London

Drawing Title: Basement Plans Proposed

Drawing No. P-110 Rev. A

Drawn JG Checked JG

Copyright Origin Architecture Ltd. 2016
No implied license exists. This drawing should not be used to calculate areas for the purposes of valuation. All dimensions to be checked on site by the contractor and each dimension to be their responsibility. Do not scale drawings. All work must comply with relevant British Standards and Building Regulations requirements. Drawing errors and omissions to be reported to the architect.

info@originstudio.co.uk
www.originstudio.co.uk

