

**PAU 7A** - 2 MALDEN ROAD, LONDON, NW5 3HR  
Flat conversion for Steve Young  
EXISTING SECTION A-A - Scale 1:50 (@A3)

26th March 2010  
17th December 2012

**Mark Prizeman** AADipl RIBA, chartered architect -  
13 Stockwell Park Road, London SW9 0AP  
TEL: 020 7735 2315  
MOB: 07990 525 869  
E-MAIL: markprizeman@btinternet.com  
markprizeman@hotmail.com

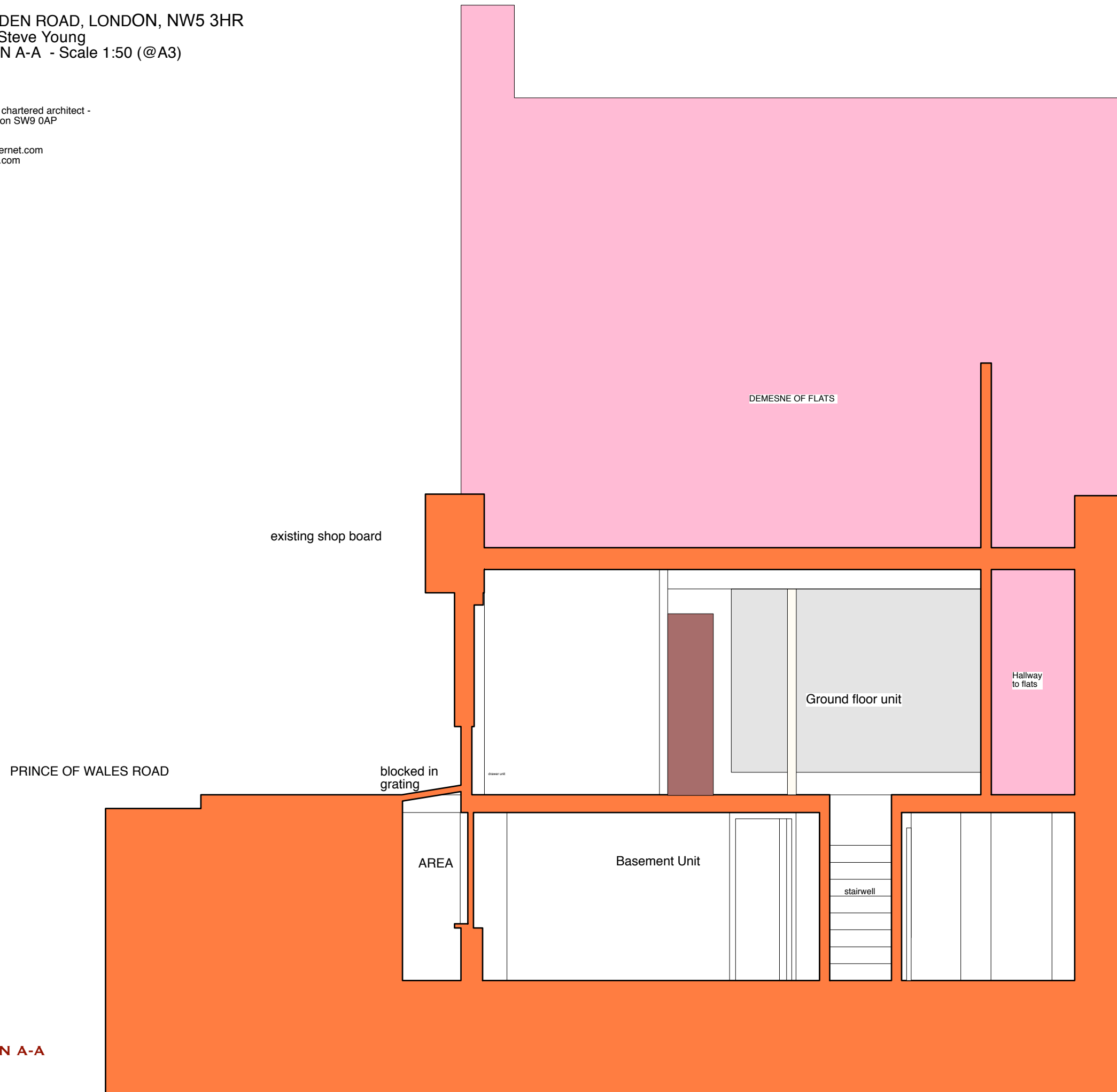

EXISTING SECTION A-A