

**PROPOSED SECTION AA**  
1:100@A1

## ANNEXE - APPROVED SECTIONS

APPROVED UNDER APPLICATION: 2013/1624

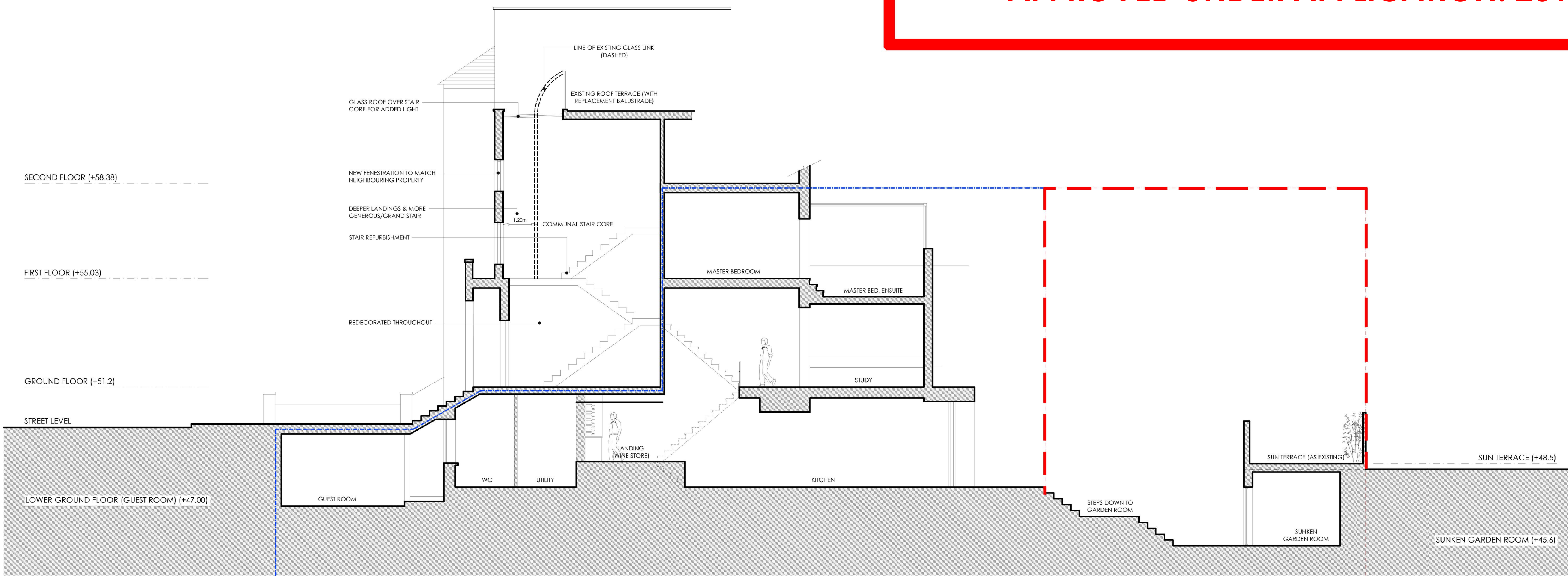

**PROPOSED SECTION BB**  
1:100@A1

6051				
Copyright of this drawing remains the sole property of den of Ramsden & Partners Architects Ltd unless otherwise assigned in writing. Figured dimensions are to be worked in all cases with any discrepancies reported to R+P prior to commencement of any work.				
Northpoint:				
Rev	Date	Amendment	By	Chk
A	20.06.13	REV INCLUDE 0.5m GREEN BUFFER	KS	
B	24.06.13	BUFFER DIMENSIONS ADDED	KS	
Notes:				

**den** RPA  
of Ramsden & Partners Ltd

67 Clerkenwell Road, London EC1R 5BL  
8 Wharf Street, The Colls, Leeds LS2 7EQ  
T: 0844 844 0070  
info@den.uk.com  
www.den.uk.com

Project: 38 Regents Park Road Primrose Hill, Camden				
Client: Mr & Mrs O'Brien				
Title: <b>PROPOSED SECTIONS (ANNEXE)</b>				
Date:	Scale:	Size:	Drawn:	Checked:
20.02.13	1:100	A1	KS	KG
Project No:	Dwg No:	Rev:	Status:	
6051	107	B	PLANNING	