

Notes

- This drawing has been prepared in accordance with the scope of RPS's appointment with its client and is subject to the terms and conditions of that appointment. RPS accepts no liability for any use of this document other than by its client and only for the purposes for which it was prepared and provided.
- If received electronically it is the recipient's responsibility to print to correct scale. Only written dimensions should be used.

EXISTING

Site boundary

PROPOSED

Biodiverse/ Wildflower Mat as Q37/ 440A to include the following species:

- Autumn hawkbit
- Birdsfoot trefoil
- Bladder campion
- Betony
- Catsear
- Common knapweed
- Common sorrel
- Common st johns word
- Common toadflax
- Common vetch
- Cowslip
- Field scabious
- Hay Rattle (yellow rattle)
- Lady's bedstraw
- Meadow buttercup
- Meadow cranesbill
- Meadowsweet
- Musk mallow
- Oxeye daisy
- Red campion
- Red clover
- Ribwort plantain
- Salad burnet
- Selfheal
- Tufted vetch
- Wild carrot
- Wild marjoram
- White campion
- Yarrow
- Sheeps fescue
- Crested dogtail
- Slender creeping red fescue
- Small leaved timothy

Hedgerow planting in raised planter as Q50/ 210
Extent of Green (Living) Wall as Q37/ 125

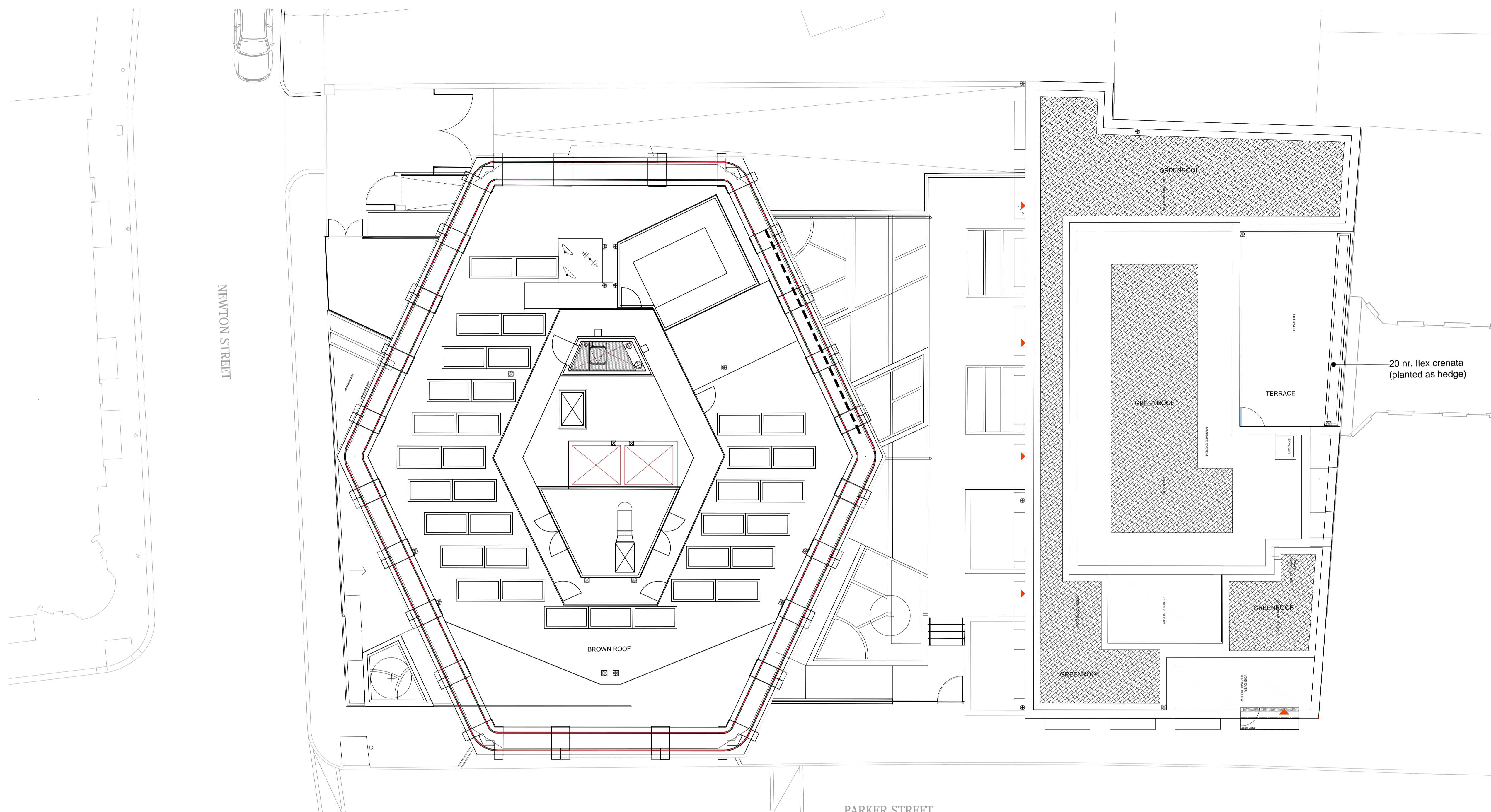

Rev	Description	Date	Initial	Checked
A	Paving removed	16:11:15	NJ	

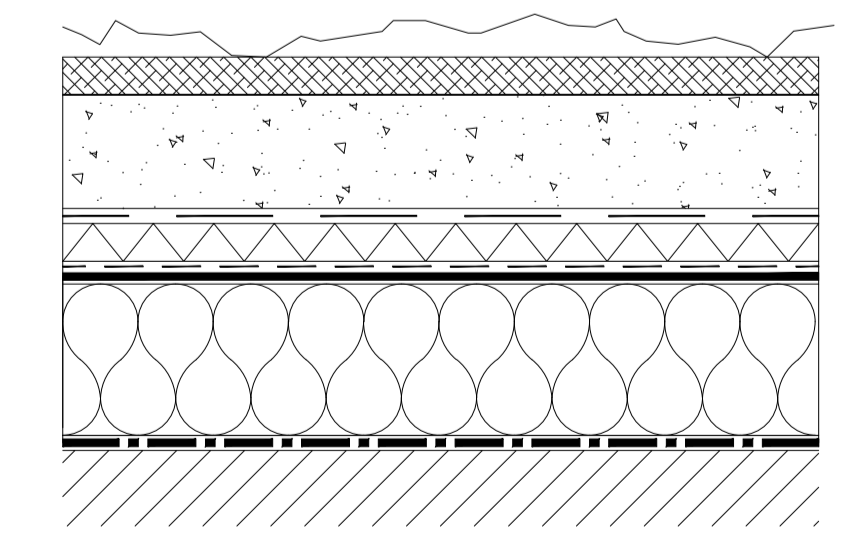
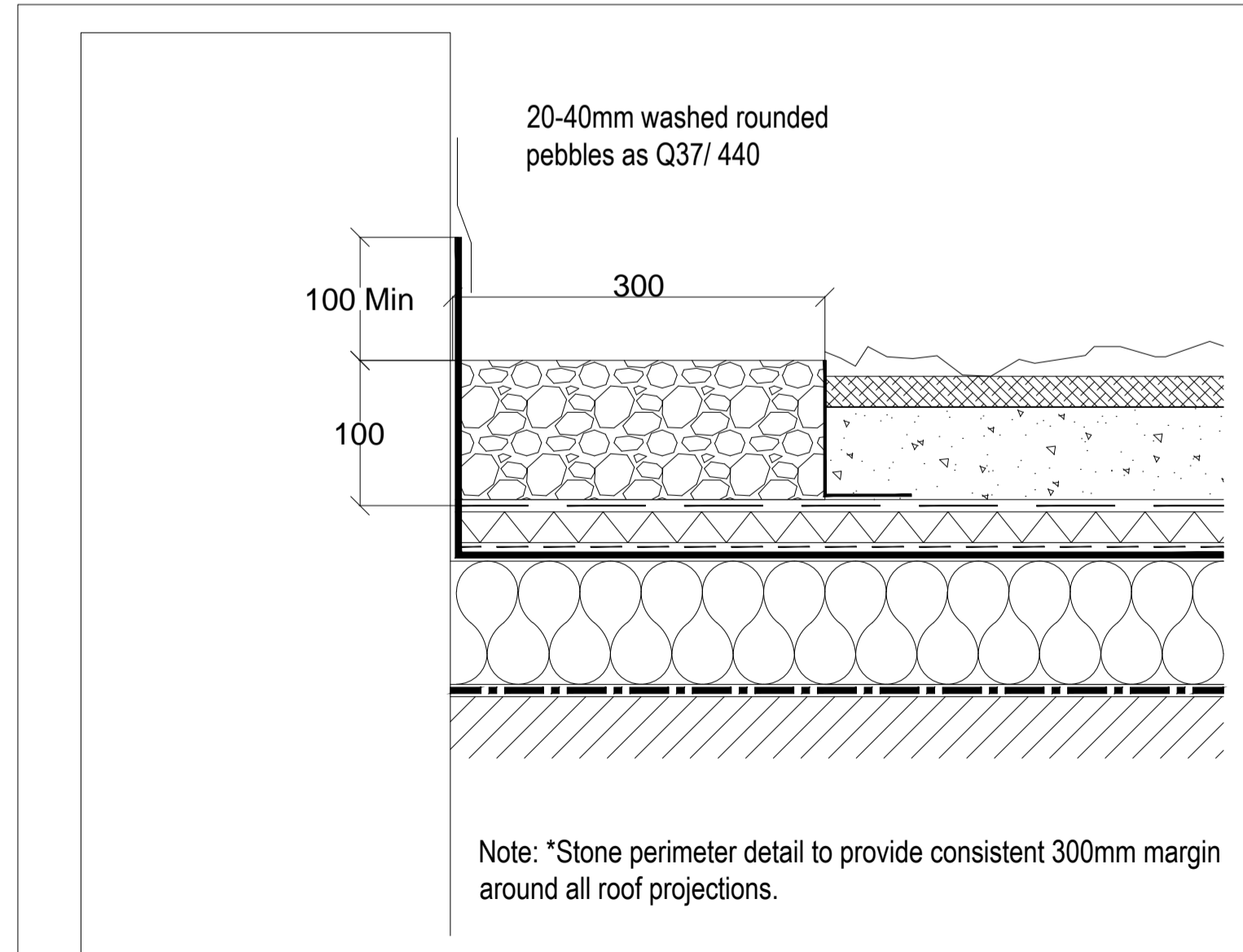
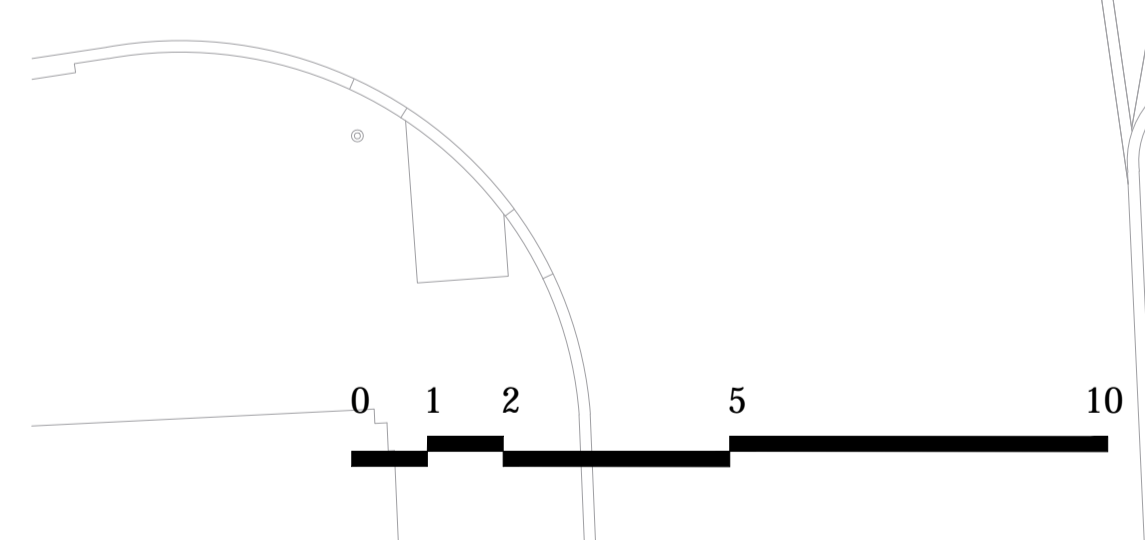

Lakesbury House, Hittingbury Road, Chandlers Ford, Hampshire, SO53 5SS
T: +44(0)2380 810 440 E: rpsso@rpsgroup.com F: +44(0)2380 810 449

Client BNP Paribas Real Estate

Project Parker Tower London

Title Planting Proposals Roof Scape

Status For Planning	Drawn By NJ	PM/Checked by CT
Job Ref JSL2545	Scale @ A1 1:100	Date Created 24/10/2015

Drawing Number 501	Rev B
--------------------	-------