

CTP/P15/16/B/19373

revisions

10/11 LINCOLN'S INN FIELDS  
EQUITY & LAW

LOCATION PLAN WITH  
REAR BOUNDARY

drawing number 191.C1

scale 1:100 date drawn by M

B & N WESTWOOD PIET AND PARTNERS ARCHITECTS  
22 QUEENS ROAD WEYBRIDGE SURREY  
Weybridge 46047 46088 44188

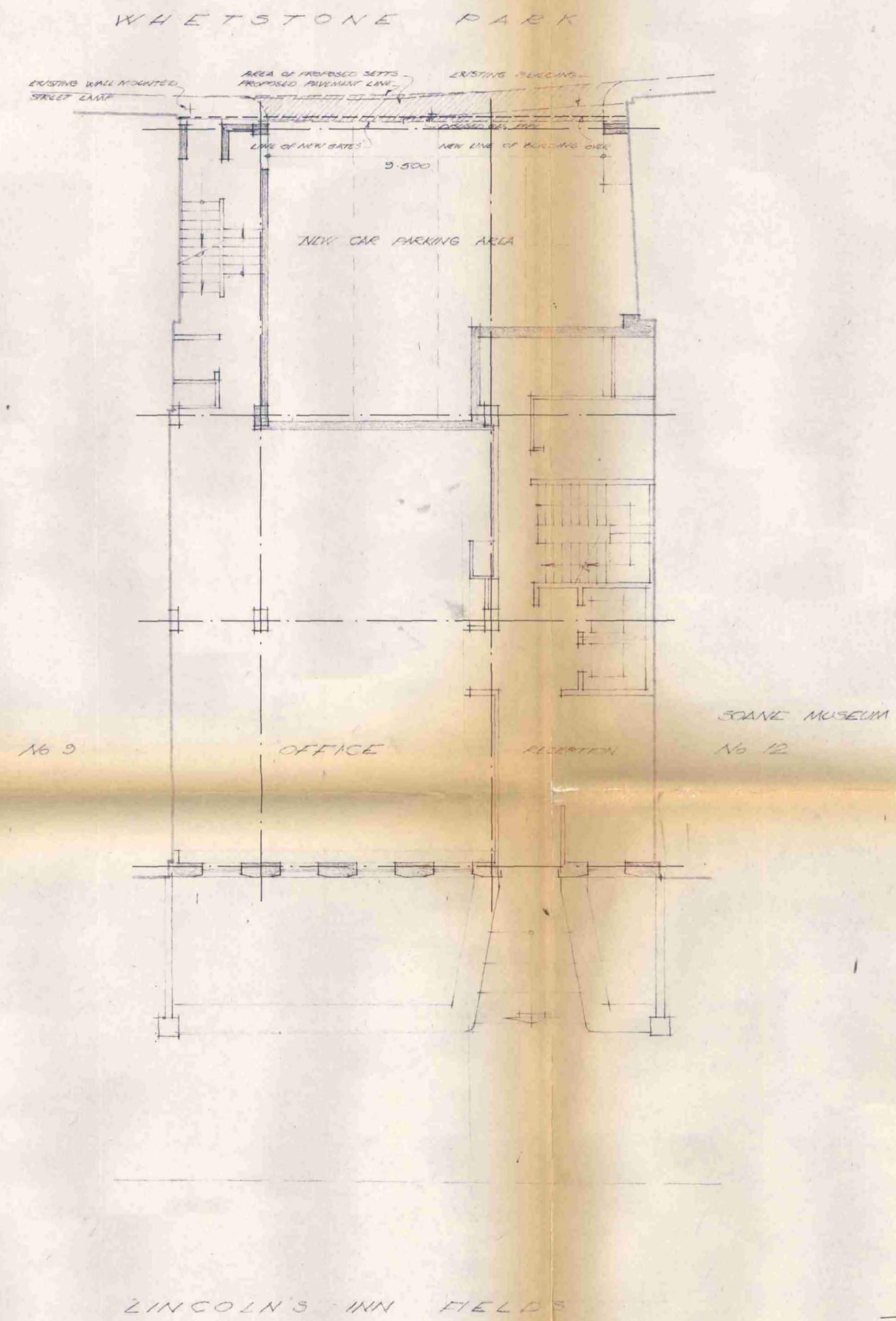
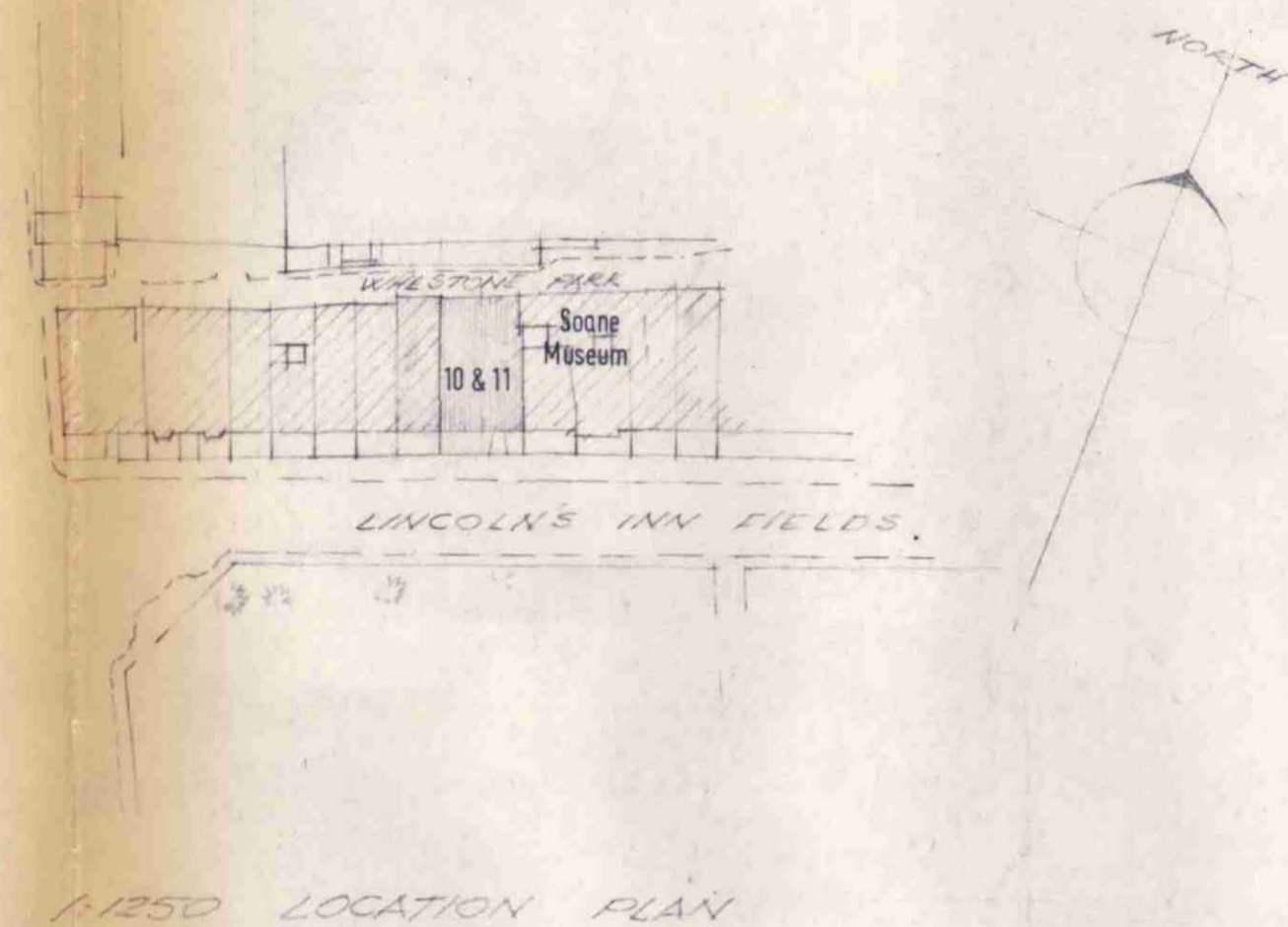

CASE COPY

LONDON BOROUGH OF CAMDEN  
 PLANS APPROVED  
 - 9 OCT 1974  
 ON BEHALF OF THE COUNCIL

CTP/PI5 / 16 / B / 1973

revisions

10/11 LINCOLN'S INN FIELDS  
 EQUITY & LAW

LOCATION PLAN WITH  
 REAR BOUNDARY

drawing number 491.C1

scale 1:100

date  
 drawn by M

B & N WESTWOOD PIET AND PARTNERS ARCHITECTS  
 22 QUEENS ROAD WEYBRIDGE SURREY  
 Weybridge 46047 46088 44188