

All information remains the property of Sigal Belot and may not be used for any purpose whatsoever, or reproduced through any medium without the written permission of Sigal Belot. No responsibility is accepted for unauthorised use. All dimensions given are to be checked on site. drawing to be used for planning application only.

## Materials Notes

**Roof** - EPDM rubber roof to new dormer

**Walls** - Vertical hung slates to match existing roof slates

**Windows** - All new windows to be timberframed sash and double glazed to match existing

**Rooflights** - Conservation style velux/rooflights over

**Railing** - Grey/silver metal guarding

**Rainwater goods** - Black downpipes & gutters

**Other** - All other facing building materials to be used will be selected to closely match the existing materials.



Front Elevation

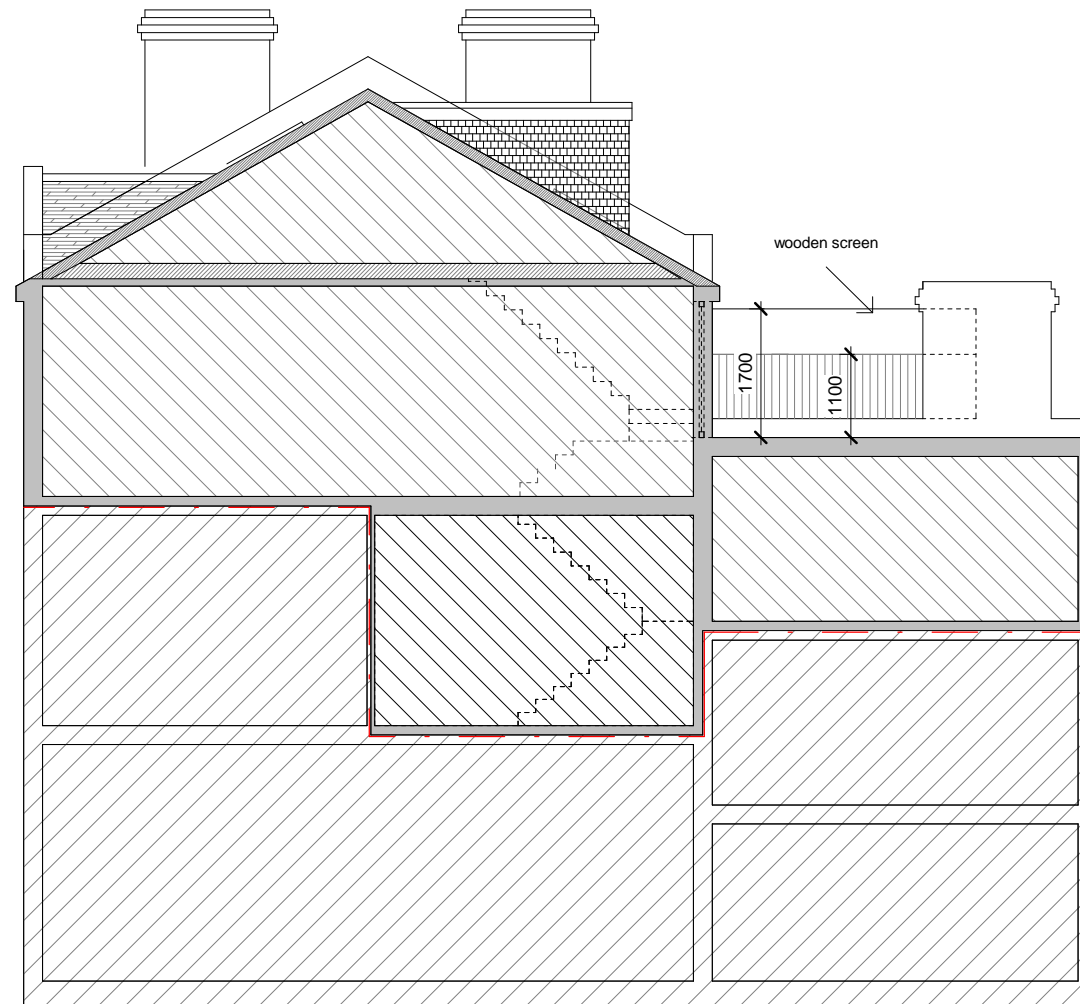

Side Elevation A

## PROPOSED ELEVATIONS FRONT & SIDE B

No.	Description	Date
1	dormer reduced in size and centred.	09/01/16
	changes to rooflights at front and added rooflight to rear.	
	external staircase to roof terrace removed.	
	amended existing opening to allow for a door to roof terrace from upper 2nd floor.	

No.	Description	Date
2	set down dormer from ridgeline.	17/02/16
	railings are set in from the rear of roof terrace and from boundary wall.	
	added wooden screen along boundary wall roof terrace	

**Sigal Belot**  
 mob 0776675622  
 email sigal1@btinternet.com

all dwgs to be read with former submitted existing drawings

**99c Goldhurst Terrace London NW6 3HA**  
**Proposed Elevations - Front & Side A**

Project number	2	GT2
Date	04/03/16	
Drawn by	Author	
Checked by	Checker	
Scale		1 : 100