

PHASE 1

	A	B1	B2	C	TOTAL
1B2P	2			8	10
2B3P	9				9
2B4P	11			12	23
3B4P					0
3B5P					0
3B6P					0
4B6P					0
5B7P					0
6B8P					0
H2B4P					0
H3B4P					0
H3B5P			2		2
H3B6P					0
H4B6P		3			3
H5B7P		1			1
H6B8P					0
M2B4P		5		1	6
M3B4P					0
M3B5P		13			13
M3B6P					0
M4B6P					0
M4B7P					0
M5B8P					0
M6B8P					0
TOTAL	22	22	2	21	

PHASE 2

	D1	D2	E1	E2	E3	E H & M	E H & M	TOTAL
1B2P	22	12	1	2	4			41
2B3P	4			5				9
2B4P	1	12	9	6	6			34
3B4P		1	1	1	1			4
3B5P	6	6	5	4	10			31
3B6P			1	1				2
4B6P								0
5B7P								0
6B8P								0
H2B4P								0
H3B4P								0
H3B5P						3		3
H3B6P								0
H4B6P								0
H5B7P								0
H6B8P								0
M2B4P								0
M3B4P								0
M3B5P							10	10
M3B6P								0
M4B6P						2		2
M4B7P			1	1				2
M5B8P			1	1				2
M6B8P								
TOTAL	33	31	19	21	21	5	10	

PHASE 3

	F1	F2	F3	F4	F H & M	TOTAL
1B2P	10	4	7	1		22
2B3P	4	5	5	9		23
2B4P	1	10	3	9		23
3B4P						0
3B5P	6	1	2			9
3B6P		1				1
4B6P						0
5B7P						0
6B8P						0
H2B4P						0
H3B4P						0
H3B5P						0
H3B6P						0
H4B6P					2	2
H5B7P						0
H6B8P						0
M2B4P	1					1
M3B4P						0
M3B5P	1				4	5
M3B6P						0
M4B6P						0
M4B7P	1					1
M5B8P						0
M6B8P						0
TOTAL	24	21	17	19	6	

TOTAL

	SOCIAL	MARKET	INTER.	TOTAL
1B2P	9	64	0	124
2B3P	14	27	0	59
2B4P	32	48	0	137
3B4P	3	1	0	8
3B5P	19	21	0	71
3B6P	2	1	0	5
4B6P	0	0	0	0
5B7P	0	0	0	0
6B8P	0	0	0	0
H2B4P	0	0	0	0
H3B4P	0	0	0	0
H3B5P	2	3	0	10
H3B6P	0	0	0	0
H4B6P	3	2	0	8
H5B7P	1	0	0	2
H6B8P	0	0	0	0
M2B4P	5	2	0	13
M3B4P	0	0	0	0
M3B5P	13	5	10	51
M3B6P	0	0	0	0
M4B6P	0	2	0	4
M4B7P	2	1	0	5
M5B8P	2	0	0	4
M6B8P	0	0	0	0
TOTAL	107	177	10	294

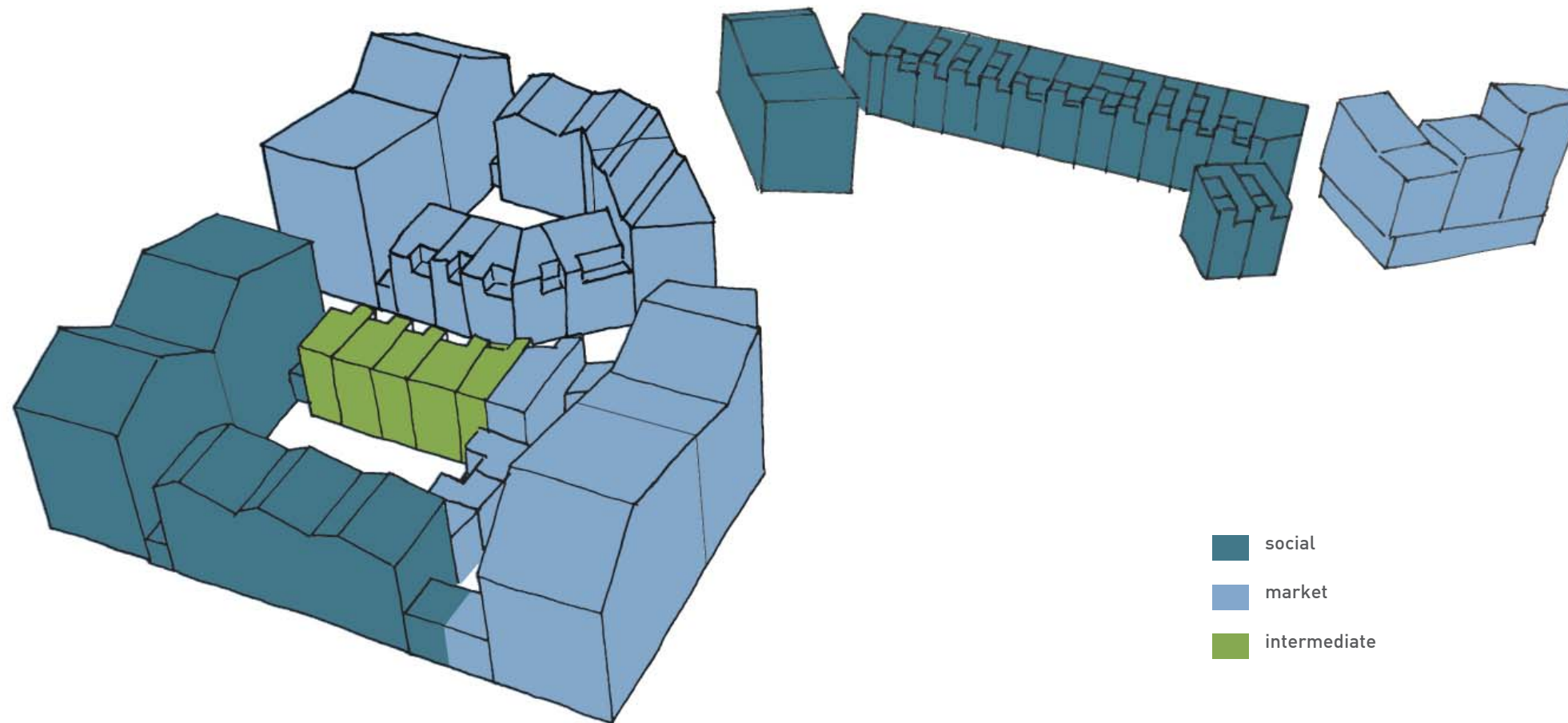

SOCIAL

1B	9	8%
2B	51	48%
3B	39	36%
4B	5	5%
5B	3	3%
6B	0	0%
total	107	

MARKET

1B	64	36%
2B	77	44%
3B	31	18%
4B	5	3%
5B	0	0%
6B	0	0%
total	177	

INTERMEDIATE

1B	0	0%
2B	0	0%
3B	10	100%
4B	0	0%
5B	0	0%
6B	0	0%
total	10	

TOTAL MIX

1B	73	25%
2B	128	44%
3B	80	27%
4B	10	3%
5B	3	1%
6B	0	0%
total	294	



PHASE 1 UNIT MIX

1B	10	3%
2B	38	13%
3B	15	5%
4B	3	1%
5B	1	0%
6B	0	0%
total	67	

PHASE 2 UNIT MIX

1B	41	14%
2B	43	15%
3B	50	17%
4B	4	1%
5B	2	1%
6B	0	0%
total	140	

PHASE 3 UNIT MIX

1B	22	7%
2B	47	16%
3B	15	5%
4B	3	1%
5B	0	0%
6B	0	0%
total	87	