

NW/n D/2

Automatic opening window on thermal & rain sensors to face of "chimney" & dormer over stair for ventilation of the whole house. The tapered roof form accelerates warm rising air & aids in stack ventilation. This is especially important for the deep plan rooms without external aspect along the back edge of the site at ground & basement floor.

- ridge level 12750
- ridge level 12225
- attic ffl 8520
- eaves level 8945
- ridge level 6370
- second ffl 6095
- eaves level 4125
- first ffl 3420
- Parliament Hill ground ffl 370
- 0.00
- basement ffl -2805
- basement sfl -2990
- basement sfl -3405

Note: The site datum has been re-indexed (0.00 has been lowered by 120 mm).

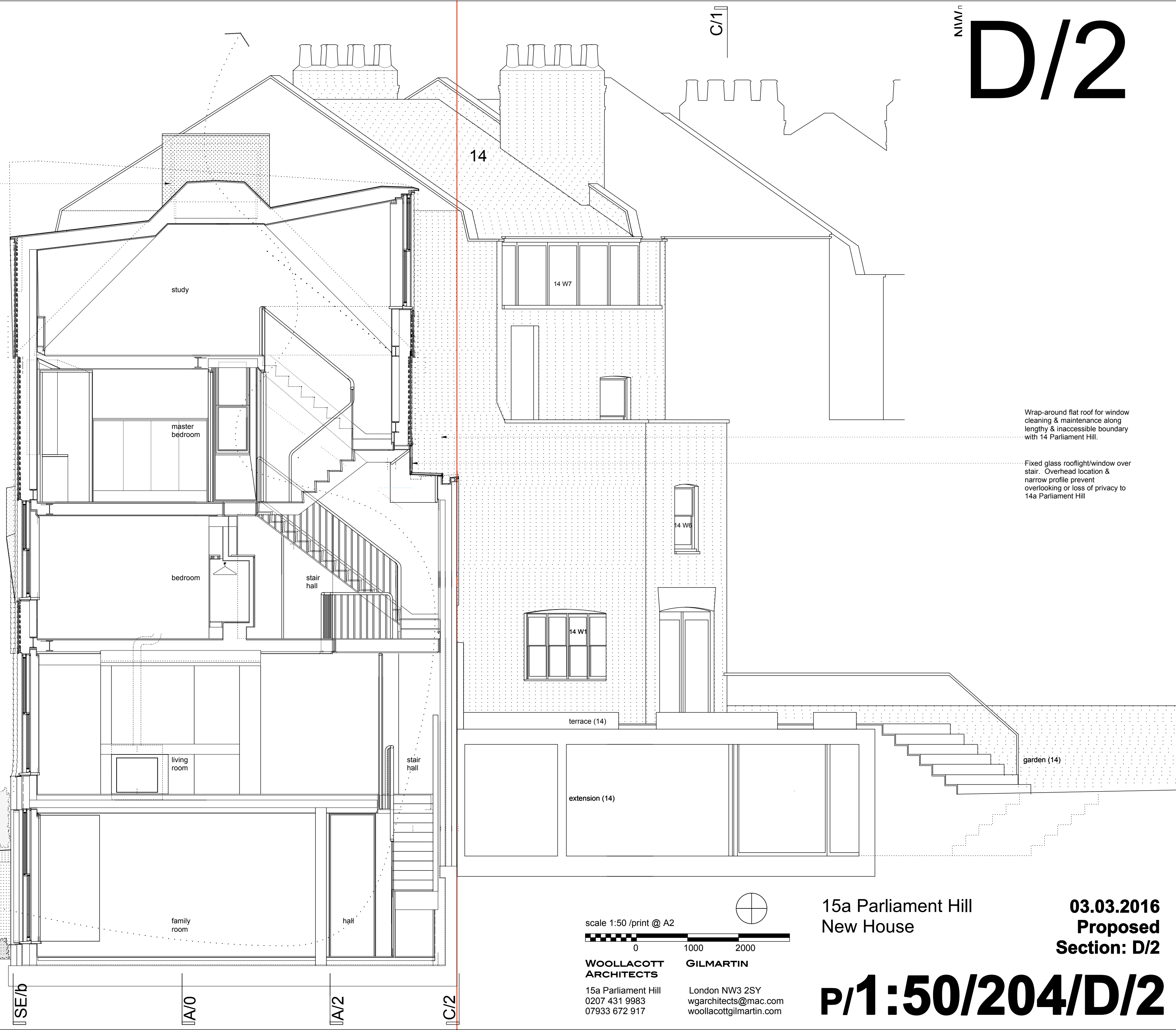
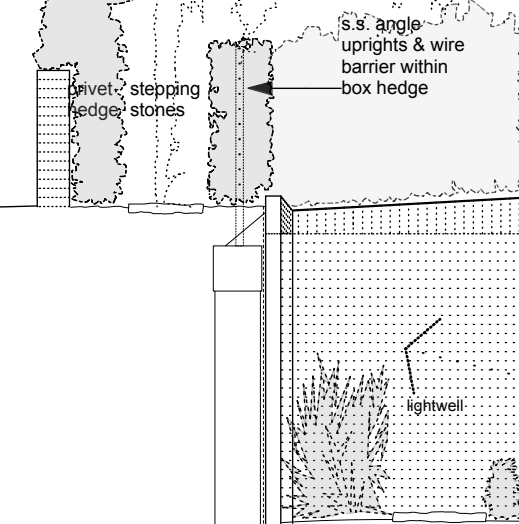

Wrap-around flat roof for window cleaning & maintenance along lengthy & inaccessible boundary with 14 Parliament Hill.

Fixed glass rooflight/window over stair. Overhead location & narrow profile prevent overlooking or loss of privacy to 14a Parliament Hill

scale 1:50 /print @ A2

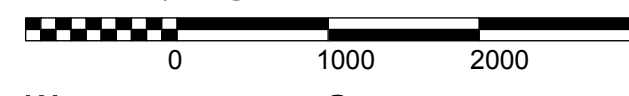

WOOLLACOTT ARCHITECTS

15a Parliament Hill
0207 431 9983
07933 672 917

GILMARTIN

London NW3 2SY
wgarchitects@mac.com
woollacottgilmartin.com

15a Parliament Hill
New House

03.03.2016
Proposed
Section: D/2

P/1:50/204/D/2