

PLANNING ISSUE

Check all dimensions on site. Do not scale off drawings without prior consultation. Any discrepancies to be reported to architects before execution of relevant works. This drawing has been produced for the London Borough of Camden for the development of Netley Primary School, 74 Stanhope Street, NW1 and for that application alone and is not intended for use by any other person or for any other purpose. Drawings remain copyright of Hayhurst and Co. and may not be reproduced without written consent or licence.

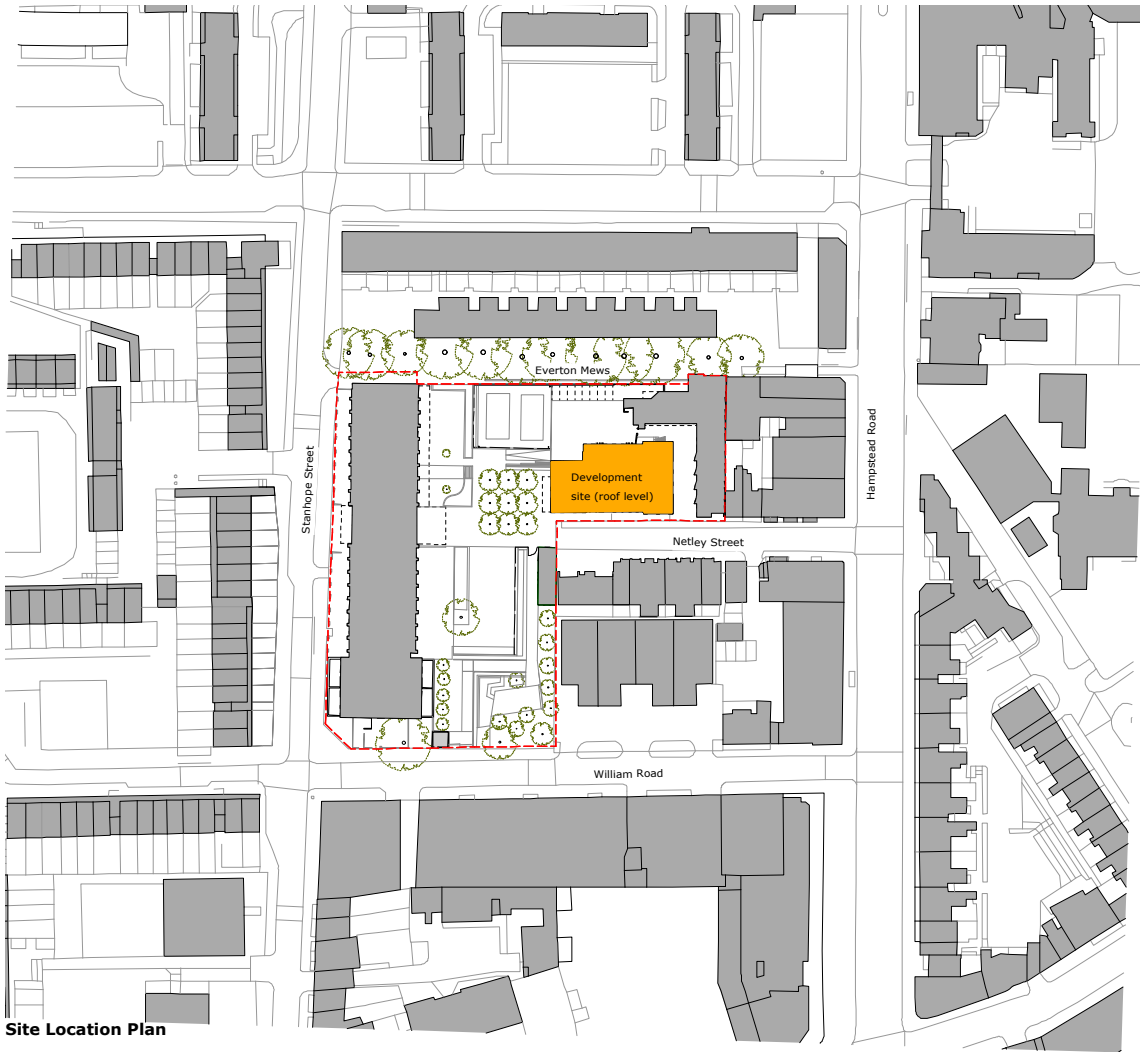
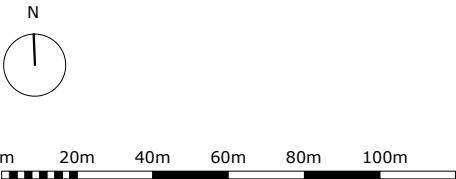

Site Location Plan

Issue/Revision	Date	Rev
Project: STEM & 2 Year Old Provision Netley Primary School, 74 Stanhope Street, London, NW1 3EX		
Hayhurst and Co.		
26 Fournier Street, London, E1 6QE T: (020) 7247 7028 F: (020) 7247 7029 E. mail@hayhurstand.co.uk www.hayhurstand.co.uk		
Subject:	STEM Site Location Plan	
Scale:	1:2000	Date: 13.08.2015
Original Size:	A4	
Drawing No.:	184 STEM A002	