

SCALE 1:100 @ A3

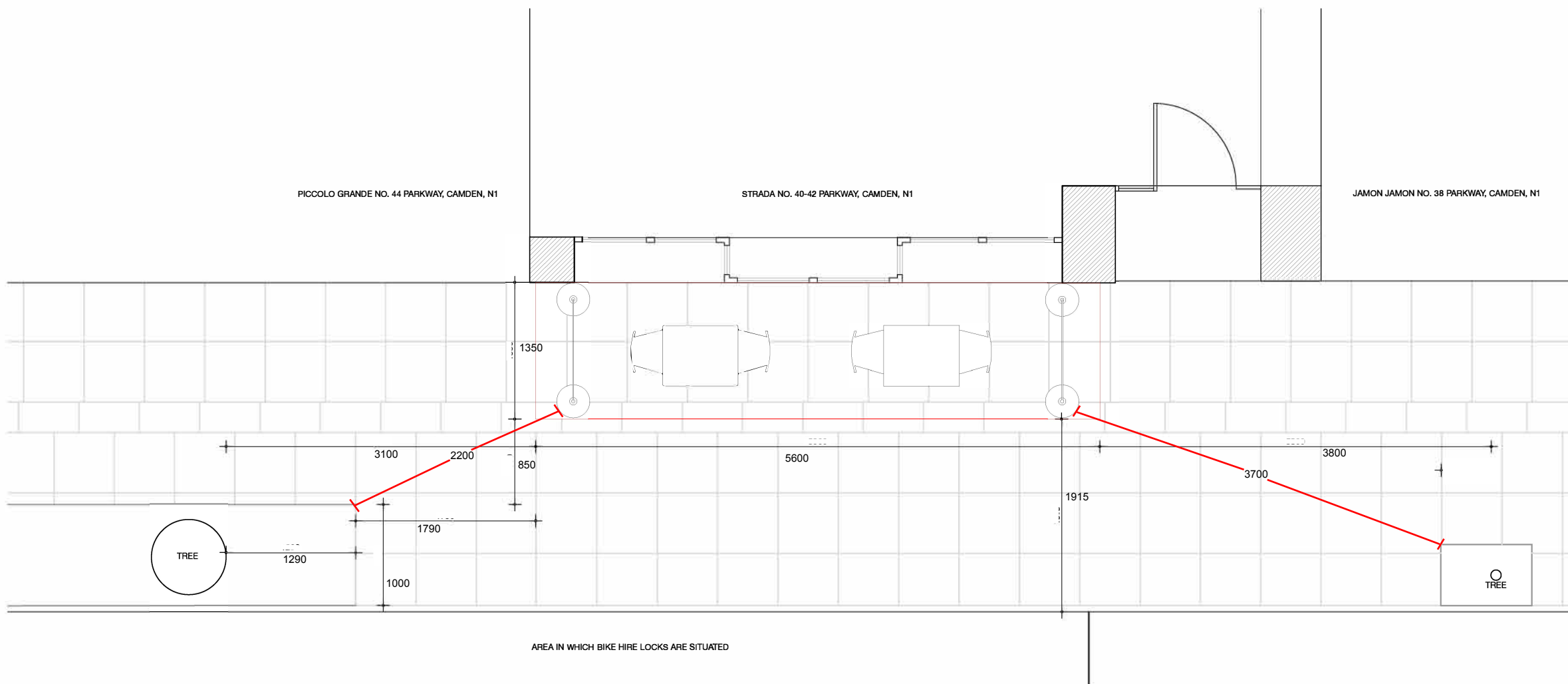

SCALE 1:50 @ A3

Licensing Plan
Strada, 40-42 Parkway, Camden, London, N1

— Licensed Area
5600mm x 1350mm

Furniture Dimensions
Table: 65cm x 65 cm
Chair: 59cm x 60 cm

- NOTES**
1. THIS DRAWING TO BE READ IN CONJUNCTION WITH ALL RELEVANT ARCHITECTS & ENGINEERS DRAWINGS & THE SPECIFICATIONS.
 2. THE CONTRACTOR IS TO BE RESPONSIBLE FOR ALL DIMENSIONS & FOR THE CORRECT SETTING OUT OF THE WORK ON SITE.
 3. DO NOT SCALE FROM THIS DRAWING.

Rev	Date	By	Amendments

Drawing Status

Studio C102
architecture & design

C102 Lighthouse Studios, 89A Shacklewell Lane, London E8 2EB
www.studio-c102.com | studio@studio-c102.com

Project Title

STRADA GENERAL
CAMDEN

Drawing Title

EXTERIOR LICENSING PLAN

Project Number

16-002-CAM

Scale

AS NOTED @ A3

Drawn by

BS

Checked by

KK

Date

FEB 2016

Drawing number

PL-01

Revision

-