







Information contained within this drawing is the sole copyright of HDGA Ltd, and is not to be reproduced without express permission. No implied licence exists. This drawing not to be used for land transfer or valuation purposes. Do not scale from this drawing. All dimensions & levels are to be checked on site by the contractor. Issued for purposes indicated only. Drawing errors and omissions to be reported to the architect.

Notes

Drawings based on survey by others. All dimensions to be confirmed on site.

-  Existing Radiators
-  Proposed Radiators
-  Demolition
-  Possible Hot Water Pipe Routes
-  Joist Direction
-  1940s Screed Concrete Floor, New Damp Proof Membrane to protect from rising damp.

REFER TO DAMP COURSING LTD LETTER AND PENNINGTON PHILIP BUILDING SURVEY FOR DETAILS.

Revisions

No.	Description

HARPER DOWNIE
CREATIVE ARCHITECTURE

Third Floor
77 Bastwick Street
London EC1V 3PZ
T +44 20 7490 7674
studio@harperdownie.com
www.harperdownie.com

Client
R. Keane + D. Timmer

Project
Listed Building Consent
5 Holly Terrace, Highgate, London, N6 6LX

Drawing Title
General Arrangement
Proposed Second Floor Plan

Status	Drawn	Checked
For Information	GL/CW	VC

Scale	Date
1:50@A3, 1:25@A1	25.01.16

Drwg. No. & Revision
876-GA02-P1

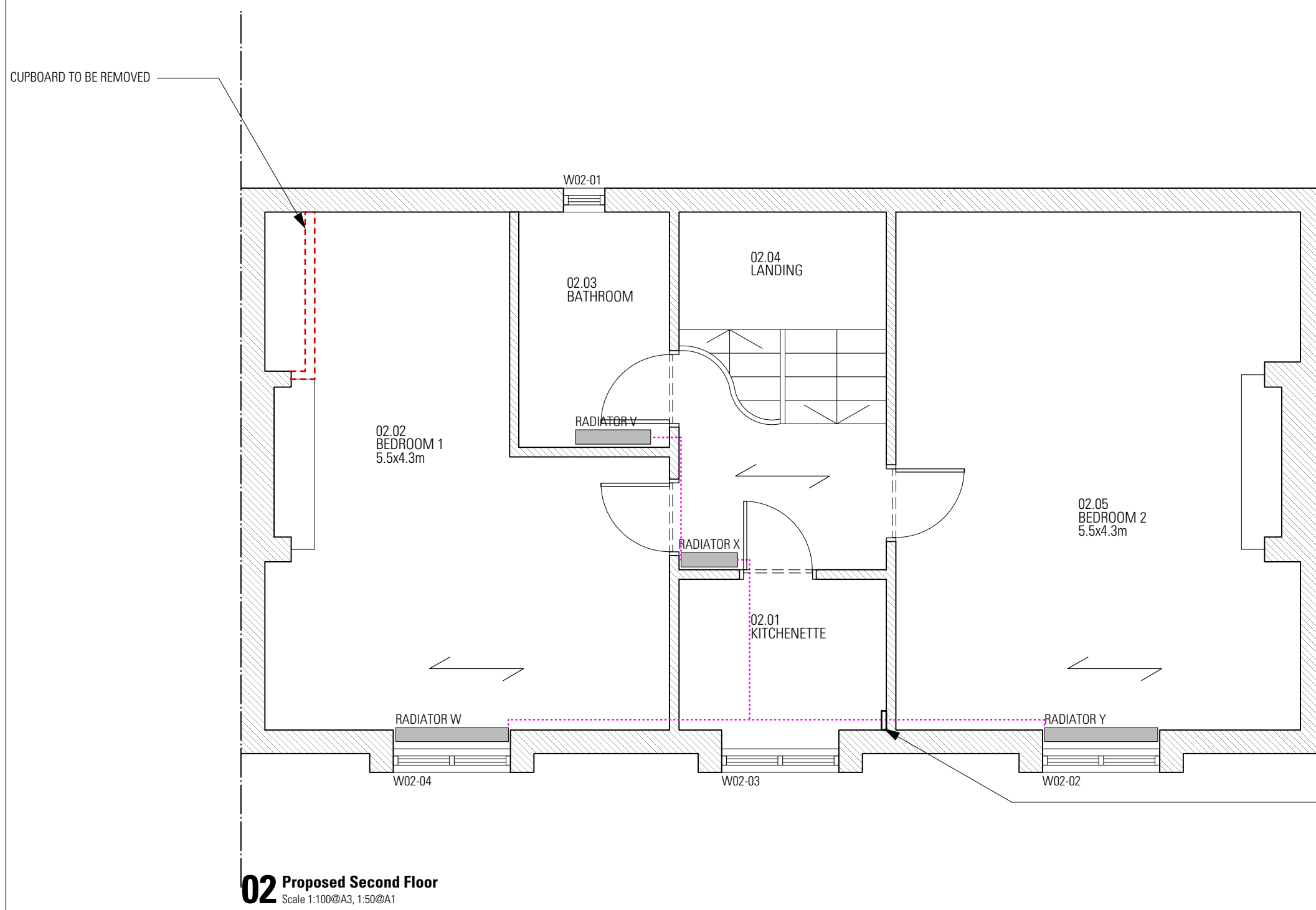

02 Proposed Second Floor
Scale 1:100@A3, 1:50@A1

