

GENERAL NOTES:
 1. DO NOT SCALE FROM THIS DRAWING. DIMENSIONS GOVERN.
 2. ALL DIMENSIONS ARE IN MILLIMETRES UNLESS NOTED OTHERWISE.
 3. ALL DIMENSIONS SHALL BE VERIFIED ON SITE BEFORE PROCEEDING WITH THE WORK.
 4. PLINCKE SHALL BE NOTIFIED IN WRITING OF ANY PROBLEMS/ISSUES.
 5. PLINCKE ACCEPTS NO LIABILITY FOR ANY EXPENSE LOSS OR DAMAGE OF WHATSOEVER NATURE AND HOWSOEVER ARISING FROM ANY VARIATION MADE TO THE DRAWING OR IN THE EXECUTION OF THE WORK TO WHICH IT RELATES WHICH HAS NOT BEEN REFERRED TO THEM AND PRIOR APPROVAL OBTAINED.

A1 Original Sheet Size
 0mm 50mm

KEY PLAN

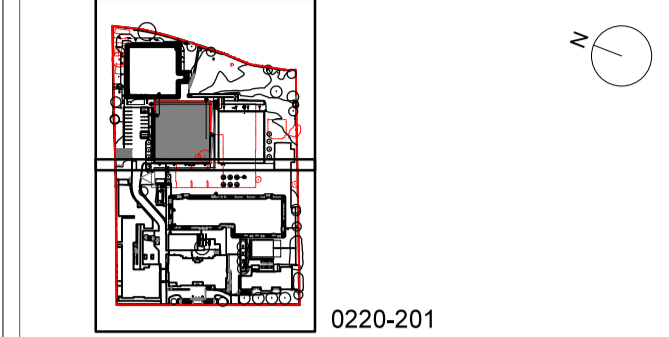

CDM:
 IN ADDITION TO THE HAZARDS / RISKS NORMALLY ASSOCIATED WITH THE TYPES OF WORK DETAILED ON THIS DRAWING, NOTE THE FOLLOWING:

ITEM NO.	RISK REGISTER DETAILS

KEY:

- | | |
|----------------------------------------------------------------------------------------------|------------------------------------------|
| SITE BOUNDARY | CYCLE STAND |
| EXISTING REMOVED SCHOOL BUILDING AND TREES | CYCLE SHELTER |
| EXISTING TREE RPA REFER TO ARBORISTS DWGS | TREE GRILLE |
| HAND DIG ZONE TO EXISTING RPA REFER TO ARBORICULTURIST REPORT & METHOD STATEMENT FOR DETAILS | HANDRAILS (TO ALL STAIRS) |
| DRAINAGE CHANNEL TO ENGINEERS DETAILS | DOOR BARRIERS |
| DRAINAGE GULLY TO ENGINEERS DETAILS | EXTERNAL TAP POINT TO ENGINEERS DETAILS |
| LAND FILTER DRAIN TO ENGINEERS DETAILS | SITE FENCING |
| EXISTING WALL FEATURE / EDGE RETAINED | 3.2M HT SPORTS WELDMESH FENCE |
| PCC UPSTAND BN KERB | 2.4M HT WELDMESH FENCE |
| PCC FLUSH KERB | 2.2M HT TIMBER HIT & MISS FENCE |
| PCC PIN KERB | 1.8M HT TIMBER PALLISADE FENCE |
| TIMBER EDGING BOARD | 1.1M HT BALLUSTRADE |
| VEHICULAR ASPHALT TO ENGINEERS DETAILS | TEMPORARY TIMBER POST & R WIRE TO RESSES |
| PEDESTRIAN ASPHALT TO ENGINEERS DETAILS | 2.2M HT SPORTS WELDMESH FENCE |
| PERMEABLE ASPHALT | GATE SCHEDULE |
| ARTIFICIAL GRASS | NO. HT. TYPE C/O. FENCE NO. |
| COLOURBY TACTILE PAVING (WARNING (PARKING BAYS) AND ROAD MARKINGS) | 01 3000 DL 2000 FE1 2 no |
| THERMOPLASTIC LINE (MARKINGS (PARKING BAYS) AND ROAD MARKINGS) | 02 3000 SL 1500 FE1 1 no |
| SPORTS LINE MARKINGS | 03 2400 DL 3000 FE2 1 no |
| DETERRENT PAVING | 04 2400 DL 2000 FE3 3 no |
| IN SITU CONCRETE PAVING | 05 2200 DL 1500 FE3 1 no |
| IN SITU CONCRETE STEPS (ALL STEPS ILLUSTRATED) | 06 1600 SL 1600 FE4 2 no |
| CONCRETE RETAINING WALL HEIGHT VARIES | |

NOTES:
 *TO BE READ IN CONJUNCTION WITH 0220-PLSH-101 OUTLINE SPECIFICATION

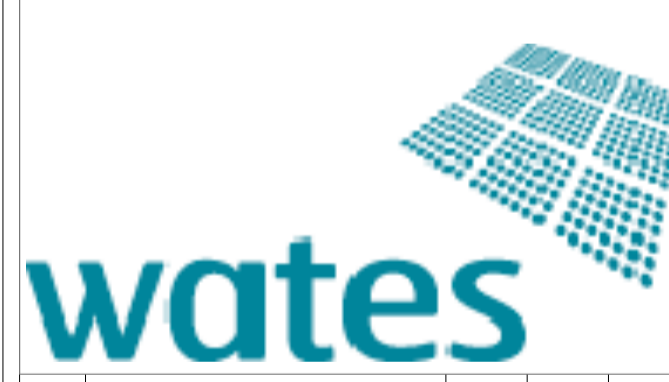

C01	Team comments incorporated	03.02.16	MT	CJ
C00	CONSTRUCTION ISSUE	14.12.15	AS	CJ
P01	Minor Amendments	21.05.15	PA	CJ
REV	REVISION	DATE	DWN	APPD

plincke.
 landscape urbanism design www.plincke.com
 London +44 (0)207 739 3330 Manchester +44 (0)161 237 9223

Project:
HAMPSTEAD SECONDARY SCHOOL
WESTBERE ROAD

Drawing:
HARDWORKS PLAN 01

Date:
 01.05.15 Scale:
 1:200

Status:
CONSTRUCTION Dm: PA App'd: CJ

Drawing No:
 0220-201 Rev:
 C01