

D07

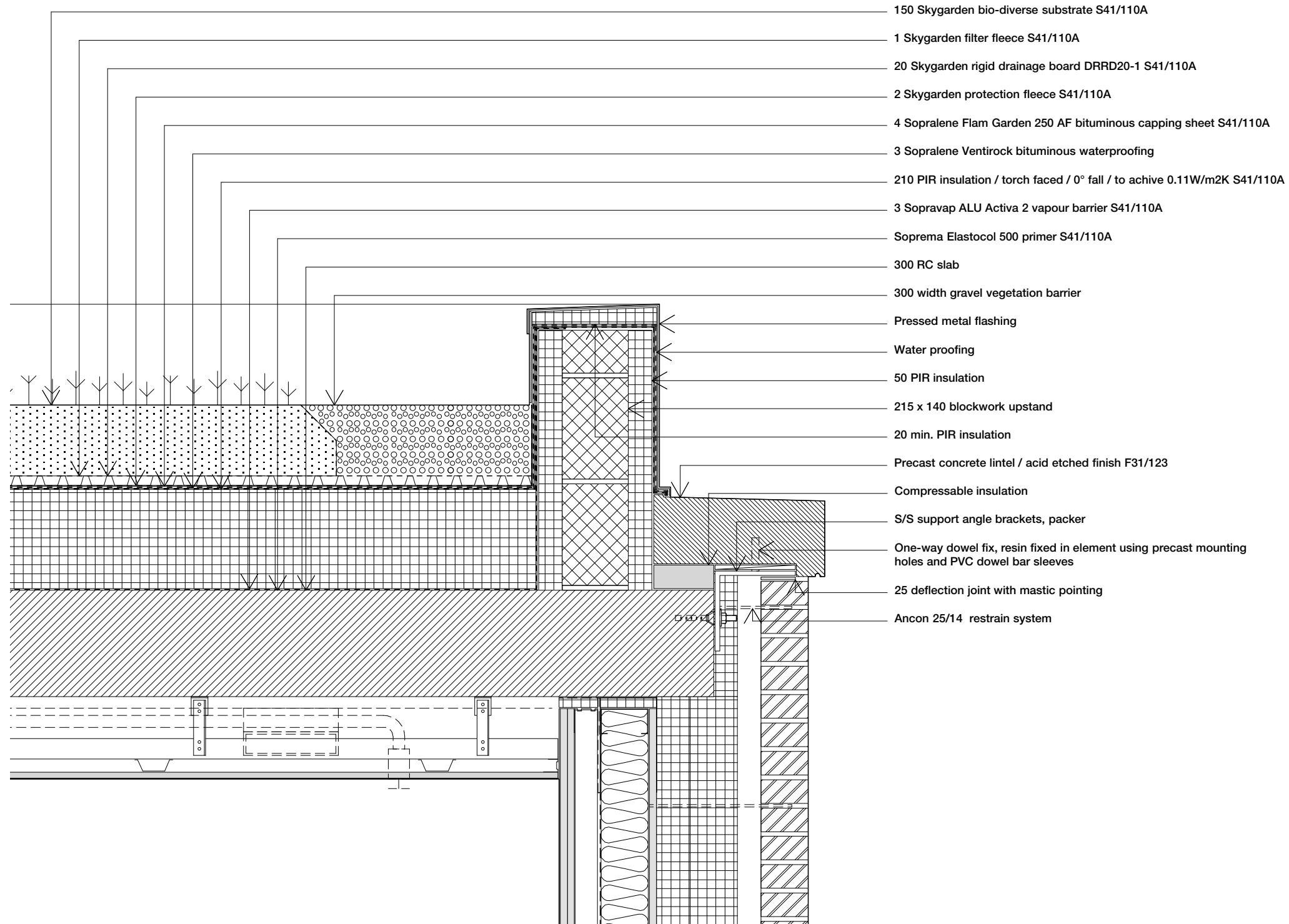

- 150 Skygarden bio-diverse substrate S41/110A
- 1 Skygarden filter fleece S41/110A
- 20 Skygarden rigid drainage board DRRD20-1 S41/110A
- 2 Skygarden protection fleece S41/110A
- 4 Sopralene Flam Garden 250 AF bituminous capping sheet S41/110A
- 3 Sopralene Ventirock bituminous waterproofing
- 210 PIR insulation / torch faced / 0° fall / to achieve 0.11W/m2K S41/110A
- 3 Sopravap ALU Activa 2 vapour barrier S41/110A
- Soprema Elastocol 500 primer S41/110A
- 300 RC slab
- 300 width gravel vegetation barrier
- Pressed metal flashing
- Water proofing
- 50 PIR insulation
- 215 x 140 blockwork upstand
- 20 min. PIR insulation
- Precast concrete lintel / acid etched finish F31/123
- Compressable insulation
- S/S support angle brackets, packer
- One-way dowel fix, resin fixed in element using precast mounting holes and PVC dowel bar sleeves
- 25 deflection joint with mastic pointing
- Ancon 25/14 restrain system

Sergison Bates architects^{LLP}
Envelope typical details

Fitzjohn's Avenue, NW3
Planning Technical Documents

Architects	Date	Scale
Sergison Bates architects 34 Clerkenwell Close London EC1R 0AU United Kingdom	26/01/16	1:10@A3
Tel +44 (0)20 7255 1564 e-mail studio @sergisonbates.co.uk		

276/4406

Revision

Do not scale from this drawing
 All dimensions to be verified on site
 Limited Liability Partnership Registered in England & Wales
 No. OC317501 Registered office as above