

Dimensions - Weights - Standards

- Nominal volume: 1100 litres
- Net weight: approx. 65 kg
- Max. load: 440 kg
- Permitted total weight: 510 kg

Measurements to be used as a guide only - variations will occur

1100 LITRE SPECIFICATION

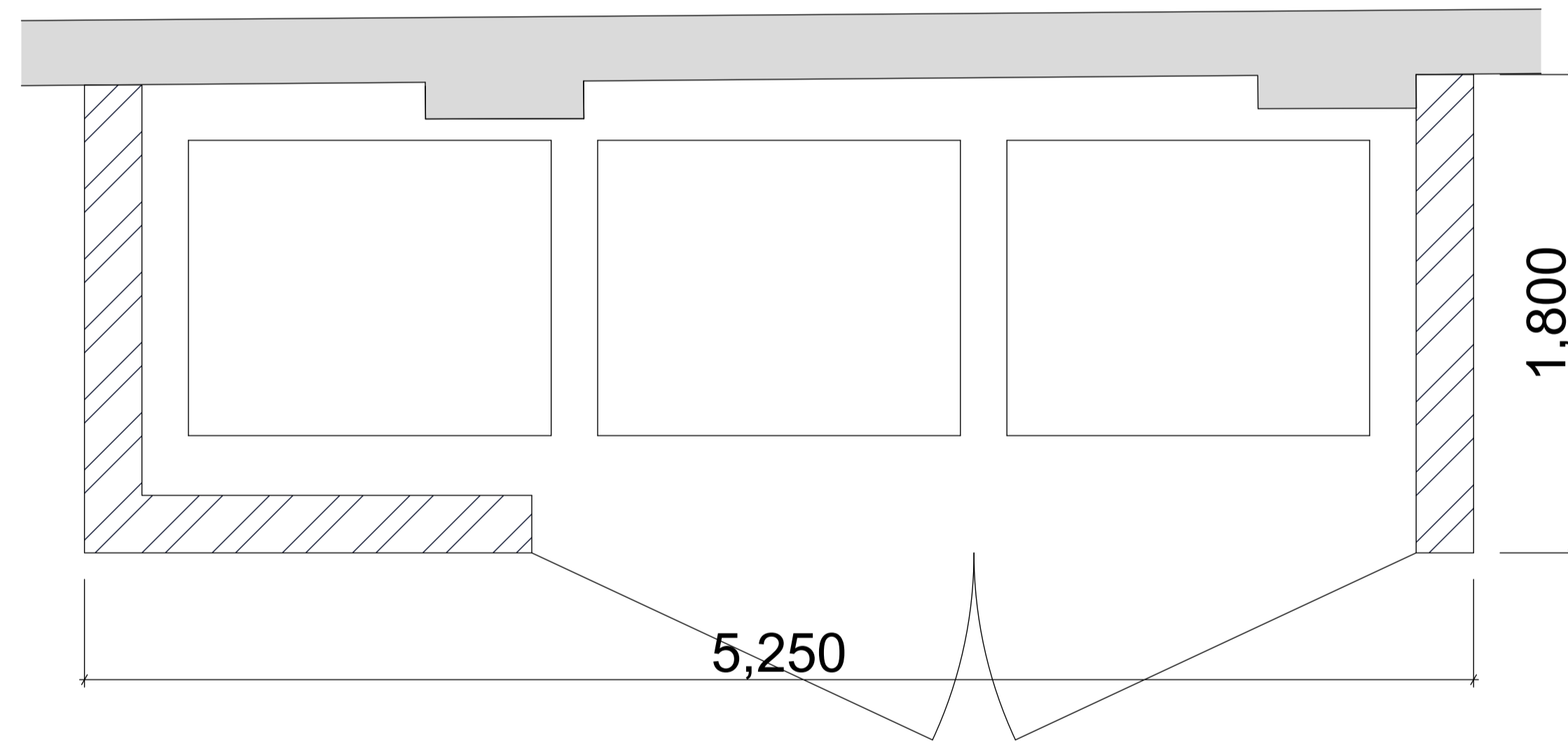

**RECYCLING STORE
1:20**

MATERIALS

- | | |
|---------|--------------|
| PLINTH | STONE |
| FRAME | OAK |
| SIDING | OAK BOARDING |
| JOINERY | OAK |
| RAFTERS | SHAPED OAK |
| ROOF | GRP TRAY |
| | SEDUM INFILL |
| | OAK TRIM |

PLANNING



SHAUN KNIGHT
ARCHITECTURE

40 FALCON ROAD, HAMPTON
TW12 2RA
07824 815 258M
0208 287 0596T
E:skarchitecture@hotmail.co.uk
W:shaunknightarchitecture.com

PROJECT: 36 LANCASTER
GROVE

TITLE : RECYCLING
STORE

Date: DECEMBER 2015

Scale: 1:20 AT A1 Drawn: SDK

DRAWING NUMBER: 072

