

Notes

Elm Street – Low Level Windows

The application seeks to install 3 new double glazed windows at low level into the Elm Street Façade, directly below the existing ground floor windows.

From our site investigations there are 3 existing apertures cast in the ground floor slab/retaining wall. The proposals seeks to open up the brickwork at low level on the façade and install new double glazed fixed lights to match the existing glazing details /profiles and colour.

The new windows are sized to compliment the existing windows.

note

01 Do not scale from this drawing
 02 All dimensions, in mm, to be checked on site by the contractor, such dimensions to be his responsibility
 03 Report all drawing errors, omissions & discrepancies to the architect.

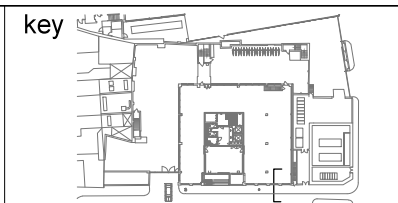

rev.	description	date
P	Issued for Planning	08.01.16

IMA Studio 5, The Glove Factory, Holt, BA14 6RL
 job title
Elm House
 drawing title / location
Existing Section A-A

info@ianmcardlearchitects.com t: 01225 784 160
 status
PLANNING
 project number
14-02
 scale
1:10 @ A3
 drawing number
P 14

drawn by
AR
 checked by
IM
 revision
-

P