

Outline of 18 Chenies Street

26 SW Elevation (2)

DATUM

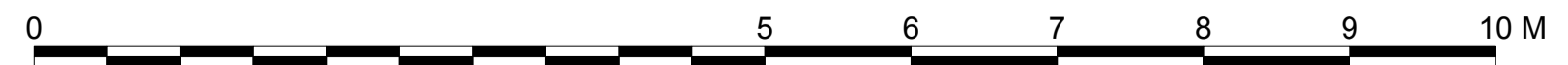

GENERAL NOTES

1. This drawing is the copyright of Haines Phillips Architects.
2. Do not scale from this drawing. Use figured dimensions only.
3. This drawing must not be used for land transfer purposes, or for construction purposes unless accompanied by an Architect's Instruction.

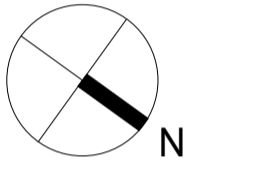
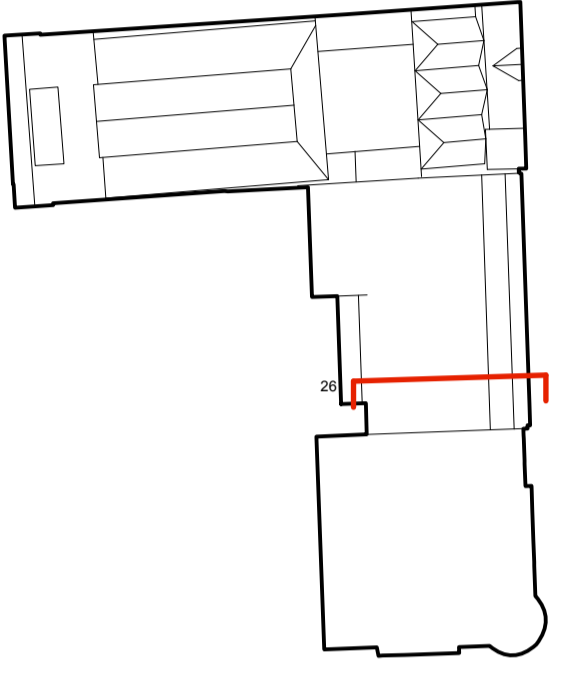

ISSUE	STATUS	COMMENT
SK	SKETCH	
P	PRELIMINARY	
PL	PLANNING	For comment and review Planning/Listed Building Application
T	TENDER	For pricing purposes only
C	CONSTRUCTION	For procurement & construction
AB	AS-BUILT	Record drawings on completion
L	LEGAL	Conveyancing or other legal purposes

REVISIONS

REV	DATE	NOTES
1	09/2015	First Issue.
2	02/2016	Rooflight updated at Planning Officer's request.

**HAINES PHILLIPS**  
ARCHITECTS

Tankerton Works  
12 Argyle Walk  
London WC1H 8HA  
t 020 7833 9324  
f 020 7837 2864  
e office@hainesphillips.co.uk

JOB TITLE  
**The Richard Attenborough Theatre and Associated Development for RADA  
16-18 Chenies Street WC1**  
DRAWING TITLE  
**As Proposed  
18 Chenies Street  
SW Elevation (2)**

DRAWN	DATE	JOB NR	DRAWING NR	ISSUE	REV
PC	09/15	3769	GA 554	PL	2