

Appendix 2

Laing O'Rourke Logistics Layout Construction plan TPB-LOR-SK-002.

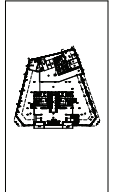

KEY PLAN

NOTES:
 1. THIS DRAWING IS FOR INFORMATION ONLY AND DOES NOT REPRESENT A CONTRACT DOCUMENT.
 2. THE DRAWING IS TO BE USED IN CONJUNCTION WITH THE LOGISTICS LAYOUT CONSTRUCTION DRAWING.
 3. ALL DIMENSIONS ARE TO FACE UNLESS OTHERWISE SPECIFIED.
 4. ALL DIMENSIONS ARE TO FACE UNLESS OTHERWISE SPECIFIED.
 5. ALL DIMENSIONS ARE TO FACE UNLESS OTHERWISE SPECIFIED.

Legend

- Site Cabin
- Gantry
- Scaffold
- Hoist

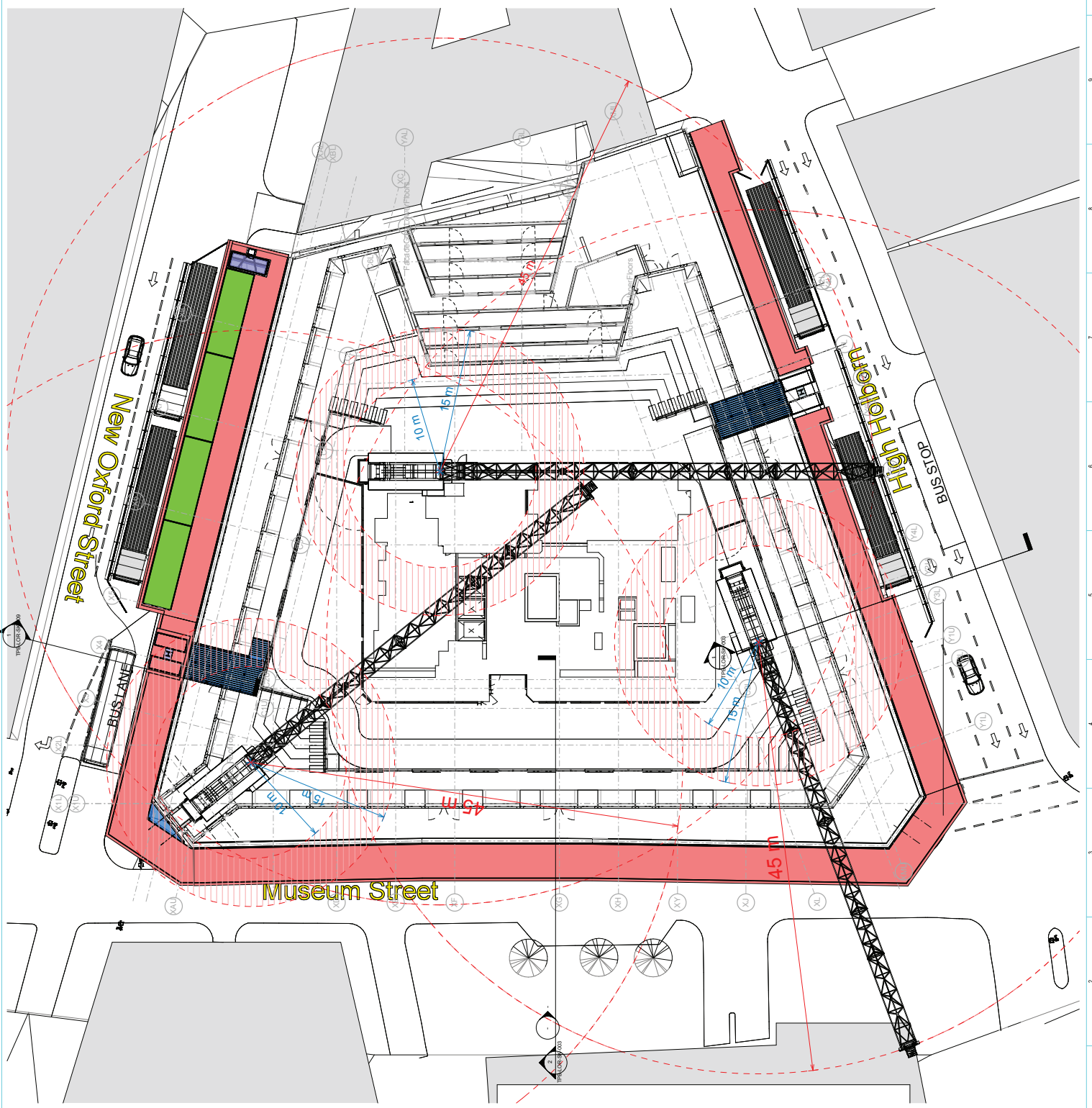

CAUTIONS IN PROGRESS
 This drawing is currently being used.
 It is intended for use as a reference only
 and is to be used for information only.

Project Name	Logistics Layout Construction
Project No.	TPB-LOG-SE-002
Revision	As Indicated
Drawn By	AT
Checked By	AT
Scale	As Indicated
Sheet No.	11
Sheet Total	12
Project Manager	TPB-LOG-SE-002

LANG DOUGRE PLC
 Langs Office Park,
 Bridge Road,
 Acacia Boulevard,
 Langford Road,
 Darford,
 Crawley,
 West Sussex,
 BN11 1AA, UK
 Tel: 01252 291000
 Fax: 01252 291001

© LANG DOUGRE PLC

The Post Building

Appendix 3

Draft external works General Arrangement plan (OX5160 - 1- 100) by Gillespies

