

NOTES:
Do not scale from this drawing.
Dimensions to be checked by Contractor working only from grid and figured dimensions and cross checked with all other relevant drawings.
Any discrepancies to be reported to the Architect prior to construction.
The title, copyright and information in this document is the property of Morrison Design Ltd, Chartered Architects.

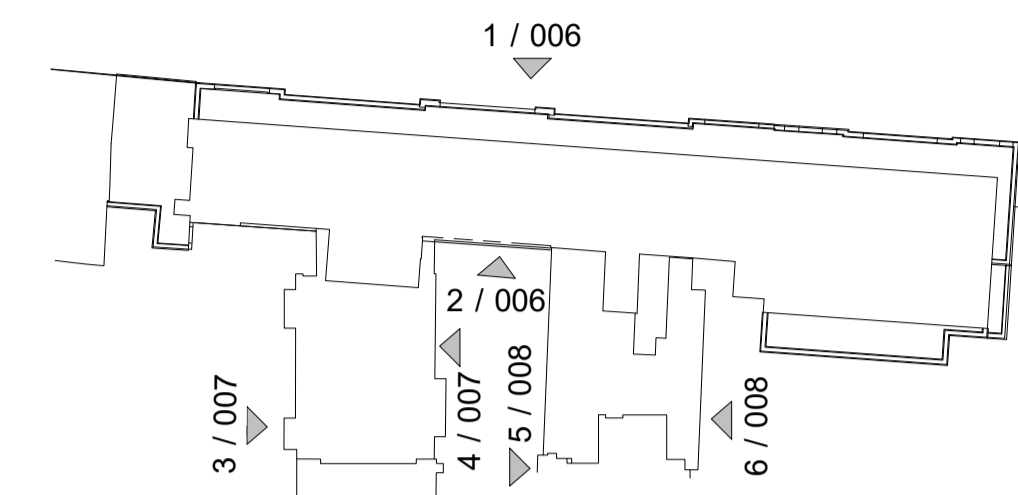
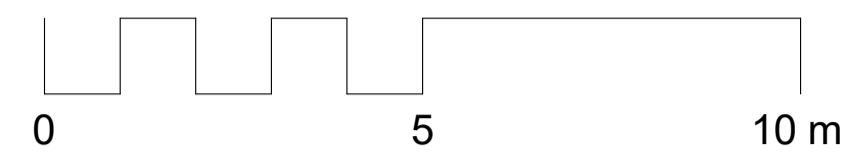

Key Plan
1 : 500

Material Key	
Identity	Material
A	Existing facing brickwork.
B	Existing feature brickwork parapet.
C	Proposed frameless glass balustrading with S.S. handrailing.
D	Proposed lightweight zinc cladding to replacement 4th and 5th floor levels, all to approved samples.
E	New double glazed curtain walling with sliding doors, all to approved samples.
F	New double glazed casement windows.
G	New Pilkington Profilitt channel translucent glazing system to approved sample.
H	New facing brickwork to match existing all to approved sample.
J	New insulated render system all to approved sample.
K	New maintenance access staircase.
L	New safety handrailing system.
M	New acoustic housing for relocated plant.

3 West Block 1
1 : 100



A West Elevation amended to show end elevation. 05.02.16
Red line included to show existing building outline.

Revision	Description	Date



MORRISON DESIGN
CHARTERED ARCHITECTS

St Alkmunds House, 103 Belper Road, Derby DE1 3ES
T: 01332 363355 F: 01332 291441 E: architect@morrisondesign.co.uk

Job Title
Proposed 4th & 5th Floor Alterations
Doubletree by Hilton London West End

Crimson Hotels
Drawing Title
Proposed Elevations Sheet 2 of 3

File Ref:
Plotter Settings:

Scale @ A1: As indicated Drawn: P/JN CFI □ Date: 08/24/15

Job No.	Drawing No.	Revision
3829B	007	A

PLANNING SUBMISSION

4 East Block 1
1 : 100