

Project
**THE WHITE WING -
GALLERIES 42-45**

Prepared For
**The Trustees of the British
Museum**

Project No: 15.33058.00



HOK
Qube, 90 Whitfield Street
London, W1T 4EZ, UK
t +44 (0)20 7636 2006
f +44 (0)20 7636 1987

All reproduction & intellectual property rights reserved © 2015
In Association with

Alan Baxter Ltd
75 Cowcross Street
London, EC1M 6EL

TGA Consulting Engineers
The Rivergreen Centre, Aykley Heads
Durham, DH1 5TS

Baker Mallett
Suite 1, Churchill Square, Kings Hill
West Malling, Kent, ME19 4YU

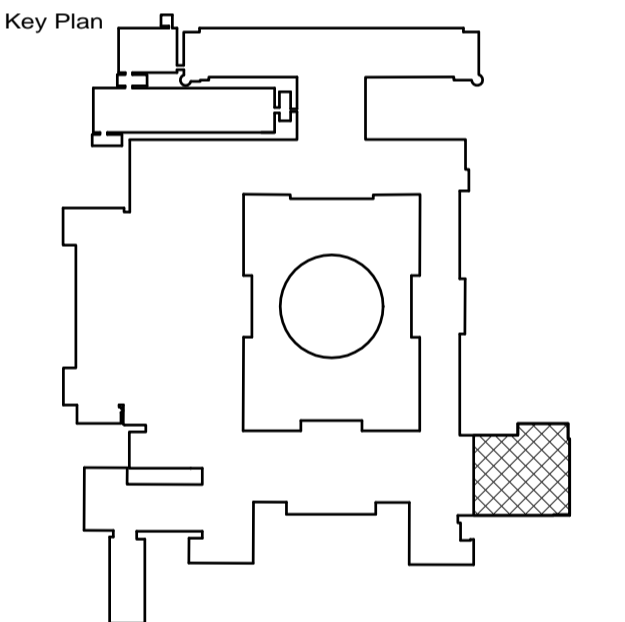

Do not scale dimensions from drawings
Site verify all dimensions prior to construction
Report all discrepancies to HOK immediately
This drawing is to be read in conjunction with all relevant
documents and drawings

Rev.	Description	Date	By
A	Listed Building Consent Application	27/01/2016	LC

Drawn by: LC Reviewed by: SPD
Drawn Date: 21/01/2016 Scale: As indicated

Project No: 15.33058.00

Sheet Title:

**PROPOSED ROOF
PLAN G42**

Original drawing is A1. Do not scale contents of this drawing.
Sheet Number: Revision:

A204 **A**

NOTE:
REFER TO SCOPE OF WORKS FOR DETAILS

ALL NEW SKYLIGHTS SHALL BE FITTED WITH
EXTERNAL LOUVRES

ALL HATCHES WILL BE RELOCATED AND
REPLACED WITH NEW, SECURE &
THERMALLY BROKEN HATCHES

0 .5 1 5 M