

NON-NOTIFIABLE	X	NOTIFIABLE
----------------	---	------------

**APPLICATION OF REGULATIONS TO NON-NOTIFIABLE PROJECTS**  
A PRINCIPLE DESIGNER WILL NOT BE REQUIRED DUE TO THE PROJECT NOT REACHING THE NOTIFICATION CRITERIA AT THE TIME OF ISSUE.  
ONCE ANY DEVELOPMENT WORKS HAVE COMMENCED ON OR OFF SITE IT SHALL BE THE RECIPIENT'S SOLE RESPONSIBILITY TO NOTIFY ANY CLARIFICATION OR VARIATION IN PROGRAMMING, SITE CONDITIONS, OR ANY OTHER QUALIFYING ELEMENTS WHATSOEVER WHICH MAY CHANGE THE PROJECT STATUS & ADVISE THE CLIENT OF HIS RESPONSIBILITIES IN ACCORDANCE WITH THE ABOVE-MENTIONED REGULATIONS.

**APPLICATION OF REGULATIONS TO NOTIFIABLE PROJECTS**  
A PRINCIPLE DESIGNER AND CONTRACTOR IS TO BE APPOINTED BY THE CLIENT. CONTRACTORS ARE ALSO ADVISED TO REFER TO ANY SPECIFIC RISK IDENTIFIED BELOW AND ANY RISK ANALYSIS DOCUMENT SUPPLIED BY THE FRUITFUL DESIGN CONSULTANCY LTD WHEN CONSIDERING THEIR CONSTRUCTION PHASE PLAN.

Revisions & Notes

Revision	Date	Description
A	19/01/15	Air supply fan to theatre kitchen omitted.

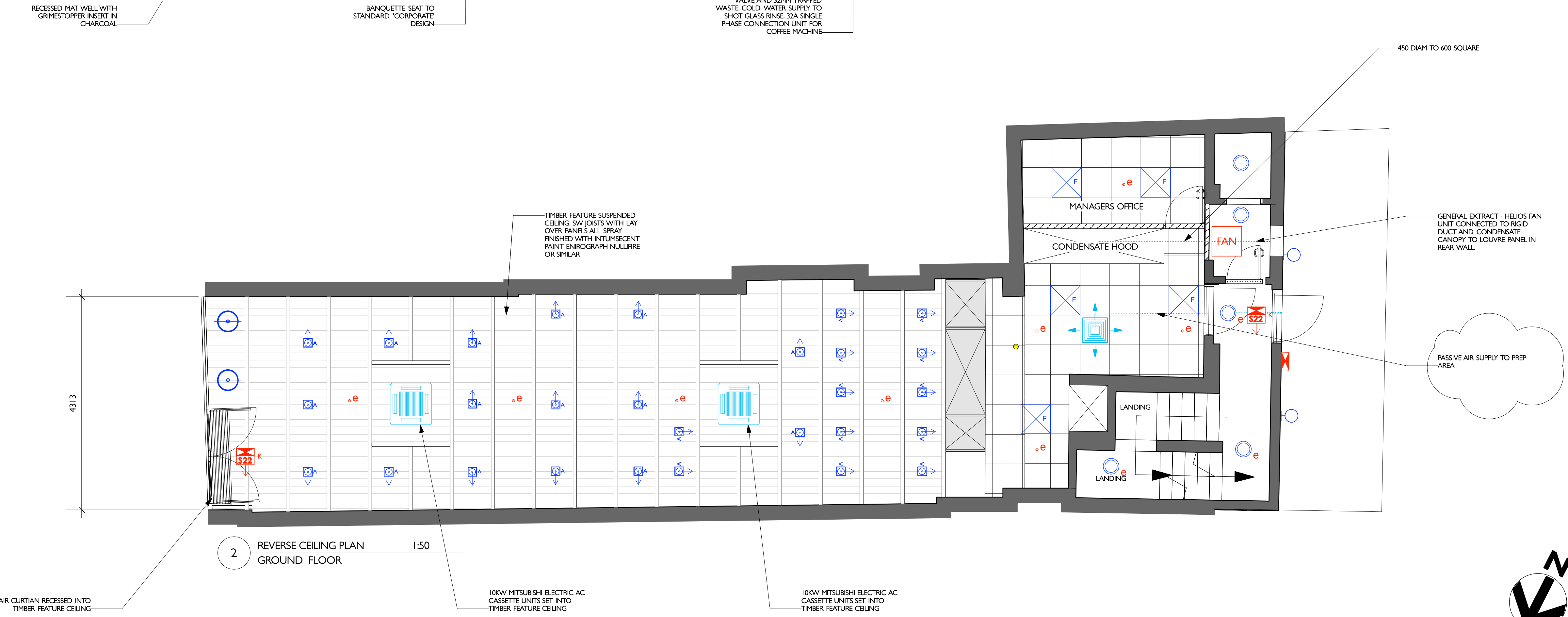
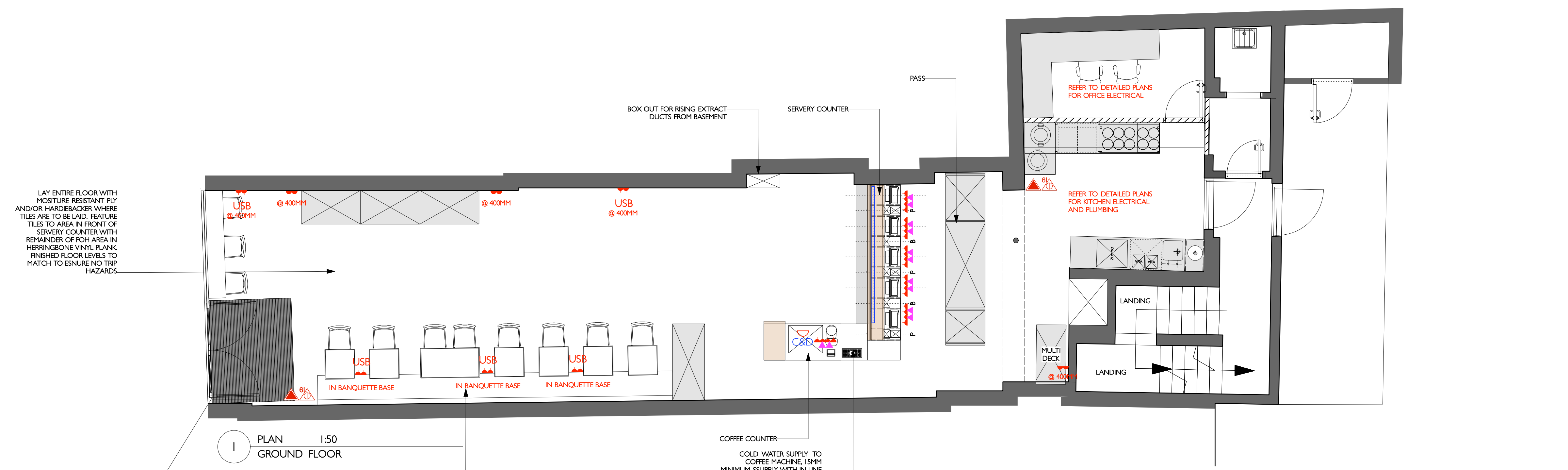

LIGHTING LEGEND

	RECESSED SQUARE FRAME LED GIMBLE
	FEATURE PENDANT CW 240V 42W MAINS HALOGEN LAMP
	LED 600 X 600 SUSPENDED CEILING MODULE
	LED BULK-HEAD FITTING. E DENOTES FITTING TO BE 3 HOUR MAINTAINED EMERGENCY FITTING
	RECESSED FIXED NON-MAINTAINED EMERGENCY ROUTELIGHT CW 2 X 240V 1W LED / 3HR EMERGENCY BATTERY PACK
	SURFACE MOUNTED NON-MAINTAINED EMERGENCY BULKHEAD 3HR EMERGENCY BATTERY PACK
	INTERNALLY ILLUMINATED FIRE EXIT SIGN CW 18W T8 / 3HR EMERGENCY BATTERY PACK
	SURFACE MOUNTED FLUORESCENT LIGHT FITTING WITH DIFFUSER
	P.I.R. DENOTES FITTINGS CONTROLLED BY PIR SENSOR
	EXTERIOR IP RATED WALL MOUNTED FLOODLIGHT
	LED STRIPLIGHT TO BE BUILT INTO JOINERY FABRICATION

The Fruitful Design Consultancy Ltd  
Unit 5, Chiltern House, Waterside, Chesham, Bucks, HP5 1PS  
T: 01494 771512 E: jmo@befruitful.co.uk

Client Name:  
PURE  
Project Title:  
179 CAMDEN HIGH STREET

Drawing Title:  
GROUND FLOOR - PLAN AND RCP

Drawing N°: PU.1015.05	Revision: A	Scale @ A1: 1:50
Date: 11/15	Drawn by: JMO	Checked by: BHRM

THIS DRAWING AND ANY ASSOCIATED DESIGN INTENT INFORMATION, IN ANY FORMAT, ARE THE PROPERTY OF THE FRUITFUL DESIGN CONSULTANCY LTD.  
COPYRIGHT IS RESERVED BY THE FRUITFUL DESIGN CONSULTANCY LTD. THIS DOCUMENT IS ISSUED ON THE CONDITION THAT IT IS NOT COPIED, REPRODUCED OR DISCLOSED IN ANY WAY BY OR TO ANY UNAUTHORIZED PERSONS WITHOUT THE PRIOR CONSENT IN WRITING OF THE FRUITFUL DESIGN CONSULTANCY LTD.  
DO NOT SCALE FROM THIS DRAWING.  
ALL DIMENSIONS ARE IN MILLIMETERS UNLESS OTHERWISE STATED.  
DIMENSIONS ON SITE AND ALL EQUIPMENT SIZES TO BE VERIFIED PRIOR TO WORK COMMENCING. IF IN DOUBT ASK.

